

## SADIE LED TABLE LAMP

SKU# 0022567, 0022568

Rated Voltage 2x 1.5V AA Batteries

To ensure correct function and safety, please read and follow all instructions carefully before assembly, installation and use of this product. Please keep the instructions for future reference.

### Warranty

- This product is covered by a 12-month warranty from the date of purchase. Please retain the proof of purchase.
- Warranty will be void if there is any damage due to improper usage or modification to the product.
- Failure to comply with the instructions in this manual may increase the risk of damage or injury and will void the warranty.

### Installation Requirements

- **Battery:** 2x 1.5V AA battery (Not included).
- Select a suitable location for this product:
  - This product is not waterproof.
  - This product is suitable for indoor use only.
  - Keep away from wet, dusty, humid, direct sun light or hot areas.
- Lay out all the components on a smooth surface and make sure no components are missing. If parts are missing, return the complete product to the place of purchase for inspection or replacement.
- Check whether the product has been damaged during transport. Do not operate/install any product which appears damaged in any way. Return the complete product to the place of purchase for inspection, repair or replacement.

### Installation Directions

- Loosen the screw from the battery compartment. (Step 1)
- Pull the tab and lift the lid out from the battery compartment. (Step 2)
- Check the polarity of 2 x 1.5V AA batteries (Not included). (Step 3)
- Install 2 x 1.5V AA batteries (Not included) into the battery compartment. (Step 4)  
Ensure the batteries are inserted with the correct polarity.
- Install the lid back over the battery compartment and tighten the screw.(Step 5)
- Use the 'On/Off' switch to turn the product on and off. (Step 6)

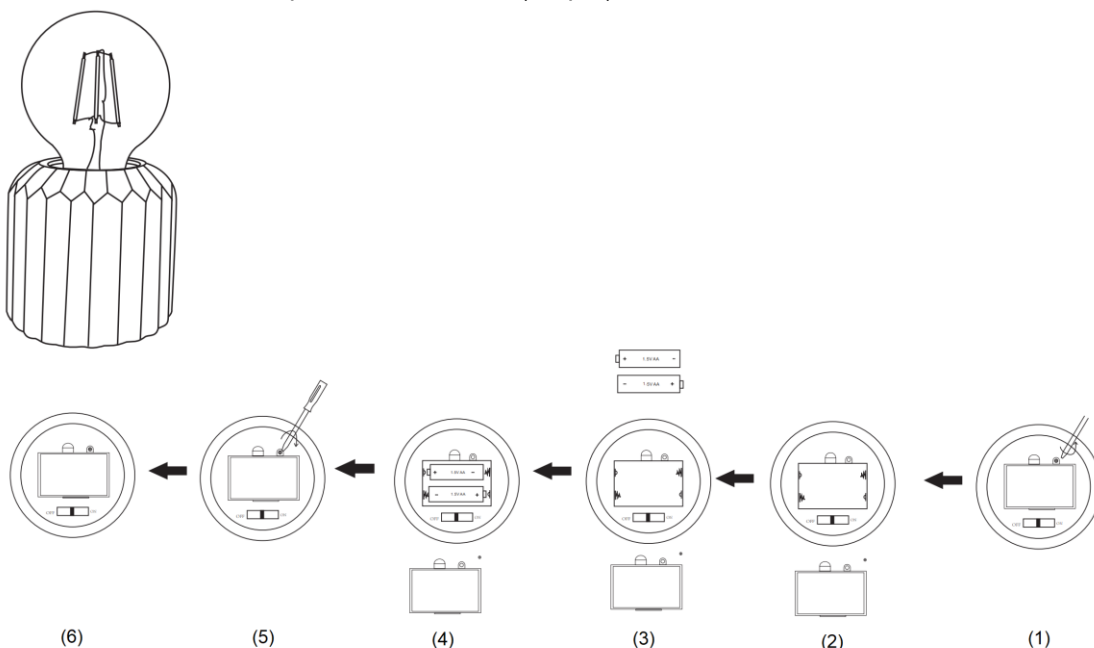

## Battery Tips and Warnings

- **WARNING – KEEP BATTERIES OUT OF REACH OF CHILDREN.**
- Swallowing may lead to serious injury due to chemical burns and potential perforation of the oesophagus.
- If you suspect your child has swallowed or inserted a battery, immediately call the 24-hour Poisons Information Centre on 13 11 26 for fast, expert advice.
- Regularly check the product and make sure the battery box is correctly secured.
- e.g. The screw and battery box lid is tightened. Do not use if battery box lid is not secure.
- If the battery box lid has been cracked or damaged, do not continue to use this product.
- Dispose of used batteries immediately and safely (so they cannot be retrieved by children).
- Exhausted batteries are to be removed from the product.
- Always replace a full set of batteries:
- Do not mix old/used batteries and new batteries.
- Do not mix different battery brands.
- Do not mix different battery types (eg. alkaline with lithium or other battery types).
- Batteries shall only be installed or replaced by an adult.
- Do not use rechargeable batteries in this product.
- The supply terminals are not to be short-circuited.
- Ensure the batteries are inserted with the correct polarity.
- Remove batteries from the product when not in use for long periods of time.

## Safety Tips and Warnings

- This product is NOT a toy. Keep out of reach of small children.
- This product is NOT suitable for children aged 3 and under.
- Young children should be supervised to ensure that they do not play with this product.
- This product is for decorative purpose only.
- The light source of this luminaire is not replaceable; when the light source reaches its end of life, the whole luminaire shall be replaced.
- Remove batteries from the product when not in use for long periods of time.
- To clean, wipe with a soft damp cloth or duster. Do NOT soak or immerse the product in water or other liquids.
- Ensure that the product does not come in contact with corrosive chemicals/solvents or abrasive cleaners etc.

## Specifications

SKU #	002256	002257
Colour	Beige	Sage
Battery	2 x 1.5V AA batteries (Not included)	
Power	1.0W Max.	0.8W Max.
Weight	0.3 kg	
Dimensions	H:170mm W:90mm L:90mm	