

NEWELL 8LT PENDANT

SKU# 011721

Rated Voltage 220-240V~ 50Hz

Thank you for purchasing this quality Lucci product. To ensure correct function and safety, please read and follow all instructions carefully before assembly, installation and use of this luminaire. Please keep instructions for future reference.

Warranty

- This luminaire is covered by a 12 month warranty. The warranty is from date of purchase, not the date of installation.
- If the luminaire is not assembled and installed by a licensed electrician the warranty will be void.
- Please retain proof of purchase and evidence of installation by a licensed electrician for any warranty enquiries.
- Warranty will be void if there is any damage due to improper usage or modification to the luminaire.
- Failure to comply with the instructions in this manual may increase the risk of damage or injury and will void warranty.

Installation Requirements

- Must be assembled and installed by a licensed electrician.
- All wiring and installation of the luminaire must adhere to the latest local and national wiring rules. eg. AS/NZS 3000 Electrical installations.
- This luminaire is a Class I product and must be earthed during wiring and installation.
- Select a suitable location for installation:
 - This luminaire is suitable for indoor use only.
 - The mounting point must support 2 times the weight of the luminaire.
 - Ensure the luminaire is not installed in direct line of an air vent/system.
 - If installing a luminaire in an area prone to moisture, ensure that the area is well ventilated and an appropriately rated exhaust fan is used if required. Damage or corrosion caused by moisture is not a product fault, and as such is not covered under warranty.
- Take care not to pull any electrical wires during unpacking as this may damage the connection.
- Lay out all the components on a smooth surface and make sure there are no components missing before assembling. If parts are missing, return the complete product to the place of purchase for inspection or replacement.
- Check whether the luminaire has been damaged during transport. Do not operate/install any product which appears damaged in any way. Return the complete product to the place of purchase for inspection, repair or replacement.
- Ensure power to the circuit you are working on has been switched OFF before commencing any electrical work.

Installation Directions

Remove all packaging material from the product and be careful not to throw away accessories that may be hidden within the packaging material. If assembly is required, place the luminaire on a smooth non-scratch surface.

Section A: Switch off the power before installation.

Section B: Assembly the luminaire as per following steps.

1. Decide on the suspension length for your luminaire and install the different length suspension rods onto the body of the luminaire. Feed the cords through the suspension rods as you assemble to remove any slack. Take care not to cross thread or twist and damage the cords. (Steps 1, 2, 3 of section B)

NOTE: The shortest suspension rod (h) has been pre-assembled onto the canopy (g). Take note of the parts (c, d, e, f) and the sequence they are installed. Loosen the rods (h) from the canopy by undoing the nuts (c) inside the canopy (g).

2. Pull the cords up into the canopy and attach the canopy to the top of the suspension rod. (Steps 4 of section B)
3. Install the canopy onto the top of the suspension rod. Install the star washer (f), terminal-block parts (e), star washer (d) and tighten nut (c) at the top. The parts must be assembled in this sequence. (Steps 5, 6, 7, 8 of section B)

NOTE: Ensure the nuts & screw of the earth terminal are fully tightened so there is an effective earth continuity.

4. Join all the live wires and one end of the provided single wire into the closed-end connector. Crimp the closed-end connector and install the heat shrink tubes onto it. Use the heat gun to shrink the heat shrink tube. Use cable ties to tighten the heat shrink tube onto the closed-end connector and cut off the excess ends of the cable tie. Repeat the same steps for the neutral wires. (Steps 9, 10, 11 of section B)

NOTE: All live wires and neutral wires are identified by different colours (L: Brown, N: Blue) and also with the L/N label. Ensure they are joined correctly.

5. Connect the ends of the single wire to the terminal block, tighten the screws on the terminal block. (Steps 12, 13 of section B)

Section C: Install the luminaire onto the ceiling as per following steps.

1. Remove the mounting bracket by loosening the screws on the side of the canopy. Use the mounting bracket as a template to mark the screw positions on the ceiling.
6. Install the mounting bracket onto the ceiling by using appropriately sized mounting screws and anchors. Ensure the screws and anchors used are suitable for the mounting surface and the surrounding environment. (Steps 1, 2 of section C)
2. Connect the mains supply wire to the terminal block. Ensure that the wires are secure and no bare wires are exposed. (Step 3 of section C)

Mains Supply Wire

Earth – Yellow/Green

Neutral – Blue or Black

Live – Brown or Red

Luminaire Wire / Terminal block

Yellow/Green or 

Blue or N

Brown or L

3. Install the canopy onto the mounting bracket. (Step 4 of section C)
4. Tight and secure screws on the side of the canopy. (Step 5 of section C)
5. Install globes (not included) into the lamp holders. Do not exceed the maximum wattage rating. (Step 6 of section C)
6. Rotate the arms to your desired angle.

NOTE: Do not rotate the arms more than 350° as this may damage the joint or damage the internal wiring.

Section D: After the installation, switch on the luminaire to test all the lighting functions and enjoy your new luminaire.

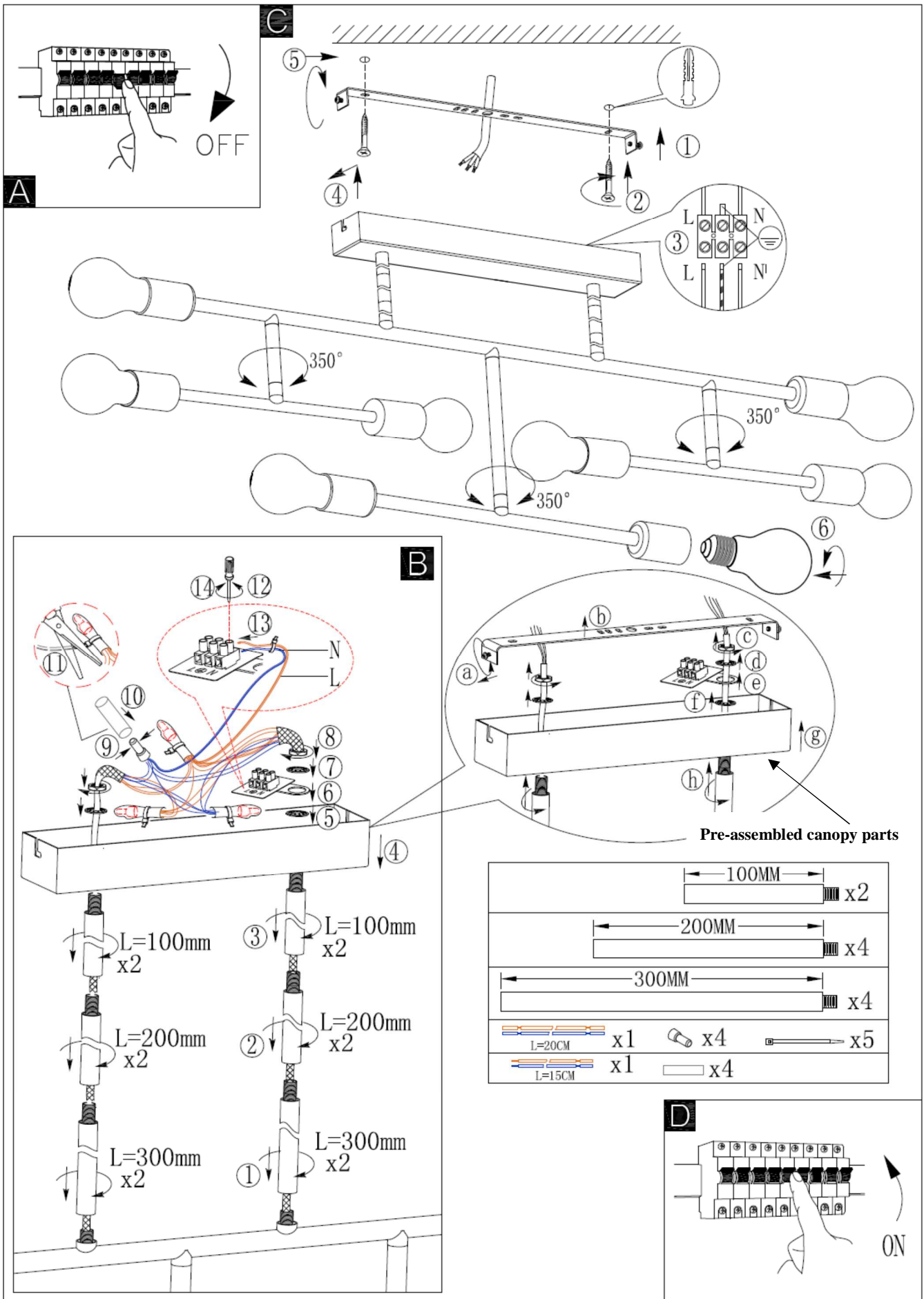

Safety Tips

- Always ensure the power is OFF and the luminaire has cooled down before performing any maintenance, cleaning or making any adjustment to the luminaire.
- To avoid injury or damage to the luminaire, ensure that power leads and screws are secure before connecting the power.
- Select a suitable location away from liquids and hazards.
- Ensure that the luminaire does not come in contact with corrosive chemicals/solvents or abrasive cleaners etc.
- To clean, wipe with a soft damp cloth. Do NOT soak or immerse the luminaire in water or other liquids.

Specifications

SKU #	011721
Supplier Model Nr.	203702
Colour	Black
Rated Voltage	220-240V~ 50Hz
Rated Wattage	336W Max. (8 x 42W Max.)
Lamp Holder	ES / E27
Weight	2.7kg
Canopy size	L:405mm H:30mm W:50mm
Dimensions	H:240mm L:1180mm W:510mm Susp:1200mm Max.