

LOCH 1 LIGHT SQUAT PENDANT

SKU# 011945, 011946, 011947, 011948

Rated Voltage 220-240V~ 50Hz

To ensure correct function and safety, please read and follow all instructions carefully before assembly, installation and use of this product. Please keep instructions for future reference.

Warranty

- This luminaire is covered by a 12- month warranty. The warranty is from date of purchase, not the date of installation.
- If the luminaire is not assembled and installed by a licensed electrician, the warranty will be void.
- Please retain the proof of purchase and evidence of installation by a licensed electrician for any warranty enquiries.
- Warranty will be void if there is any damage due to improper usage or modification to the luminaire.
- Failure to comply with the instructions in this manual may increase the risk of damage or injury and will void the warranty.

Installation Requirements

- Must be assembled and installed by a licensed electrician.
- All wiring and installation of the luminaire must adhere to the latest local and national wiring rules. E.g. AS/NZS 3000 Electrical Installations.
- Do not exceed the maximum wattage rating.
- Select a suitable location for installation:
 - This luminaire is suitable for indoor use only.
 - The mounting point must support 2 times the weight of the luminaire.
 - If installing a luminaire in an area prone to moisture, ensure that the area is well ventilated, and an appropriately rated exhaust fan is used if required. Damage or corrosion caused by moisture is not a product fault, and as such is not covered under warranty.
- Take care not to pull any electrical wires during unpacking as this may damage the connection.
- Lay out all the components on a smooth surface and make sure no components are missing before assembling. If parts are missing, return the complete product to the place of purchase for inspection or replacement.
- Check whether the luminaire has been damaged during transport. Do not operate/install any product which appears damaged in any way. Return the complete product to the place of purchase for inspection, repair or replacement.
- Ensure power to the circuit you are working on has been switched OFF before commencing any electrical work.

WARNING: Ensure power to the circuit you are working on has been switched OFF before commencing any electrical work.

1. Remove all the packaging material from the product and be careful not to throw away accessories that may be hidden within the packaging material. If assembly is required, place the luminaire on a smooth non-scratch surface.
2. Determine the suspension length required for your installation by loosening the cord anchorage (F) and adjust the length of the suspension cord (H). Tighten the cord anchorage (F), take care not to overtighten and damage the cord.
3. Remove the mounting bracket (B) from the canopy (E) by loosening the screws (D) on the sides.
4. Use the mounting bracket (B) as a template to mark the screw positions on the ceiling.
5. Install the mounting bracket (B) onto the ceiling by using appropriately sized mounting screws (C) and anchors (A). Ensure the screws (C) and anchors (A) used are suitable for the mounting surface and the surrounding environment.
6. Connect the mains supply wire and luminaire wires together to the terminal block (G). Ensure the wires are secure and no bare wires are exposed.

Mains Supply Wire

Earth – Yellow/Green 

Neutral – Blue or Black

Live – Brown or Red

Luminaire Wire/ Terminal Block

Yellow/Green or 

Blue or N

Brown or L

NOTE: This luminaire is a Class I product and must be earthed during wiring and installation.

7. Install the canopy (E) onto the mounting bracket (B) and secure by tightening the screws (D) on the sides.
8. Attach the final rod (I) to the top of the lamp holder assembly plate (J).
9. Install glass shade (L) onto the lamp holder assembly (J), and secure it using one of the following methods:
 - a) **For SKU# 011945 & 011947:** Place the metal bracket (M) into the glass shade (L) and secure it to the lamp holder assembly plate (J) by using locking nuts (N).
 - b) **For SKU# 011946 & 011948:** Place the metal bracket (P) into the glass shade (L) and secure it to the lamp holder assembly plate (J) by using locking nuts (Q).
10. Install lamp (O - not included) into the lamp holder (K) of luminaire. Do not exceed the maximum rated wattage.

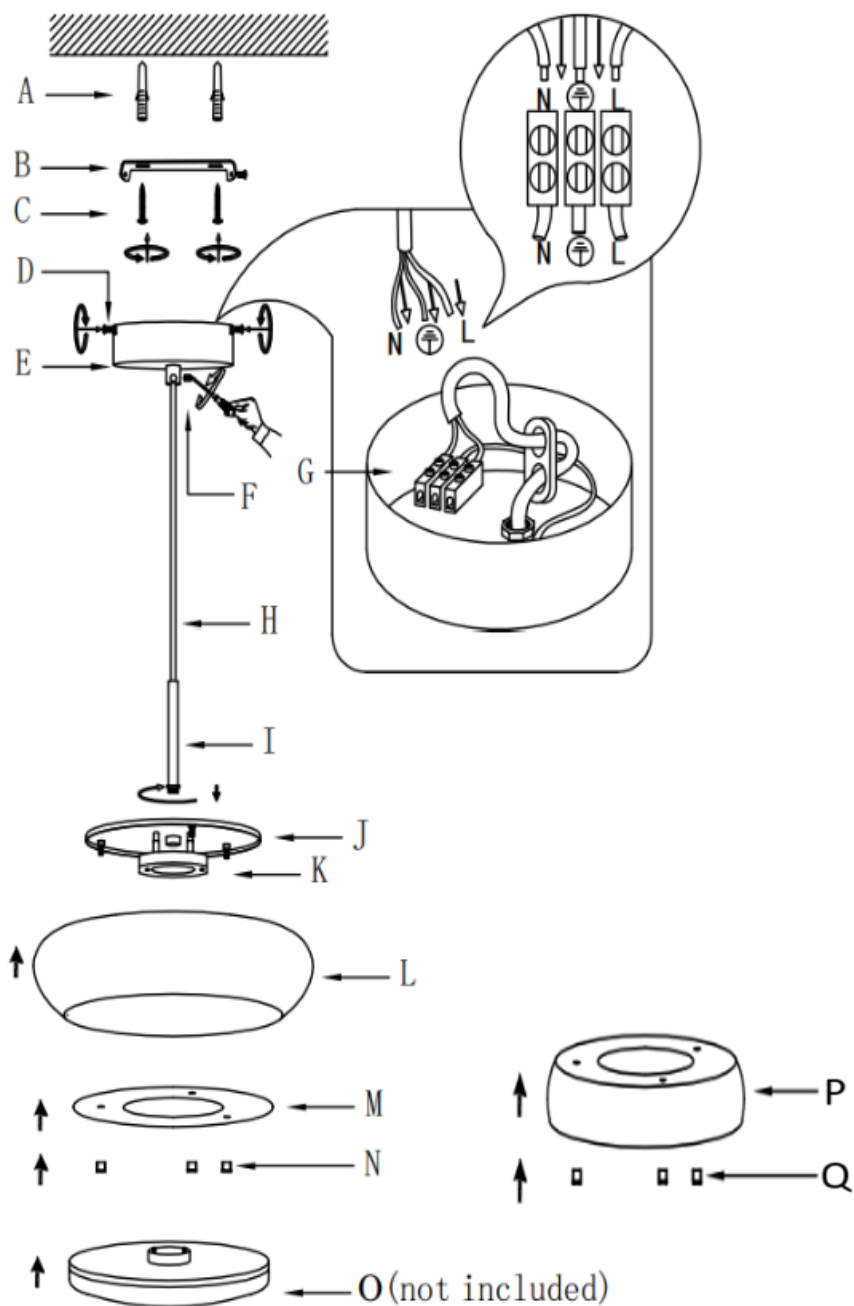

Safety Tips

- Always ensure the power is OFF and the luminaire has cooled down before performing any maintenance, cleaning, changing the globe or making any adjustment to the luminaire.
- To avoid injury or damage to the luminaire, ensure that power leads and screws are secure before connecting power.
- Select a suitable location away from liquids and hazards.
- Ensure that the luminaire does not come in contact with corrosive chemicals, etc.
- To clean/wipe with a damp clean cloth. Never soak the luminaire with water.

Specifications				
SKU #	011945	011946	011947	011948
Colour	Chrome with Opal Glass	Gun Metal with Smoke Glass	Aged Brass Finish with Milk Glass	Bronze Finish with Sepia Glass
Rated Voltage	220-240V~ 50Hz			
Rated Wattage	1x 18 Max			
Lamp Holder	GX53			
Weight	1.8KGS			
Recommended Globe	200mm GX53 globe (SKU# 128162)			
Canopy Dimensions	H:35mm Dia:120mm			
Luminaire Dimensions	Dia:280mm H:185mm			