

PHAROS 10LT LED PENDANT

SKU# 020676, 020677

Rated Voltage 220-240V~ 50Hz

To ensure correct function and safety, please read and follow all instructions carefully before assembly, installation and use of this product. Please keep instructions for future reference.

Warranty

- This luminaire is covered by a 3-year warranty. The warranty is from date of purchase, not the date of installation.
- If the luminaire is not assembled and installed by a licensed electrician, the warranty will be void.
- Please retain proof of purchase and evidence of installation by a licensed electrician for any warranty enquiries.
- Warranty will be void if there is any damage due to improper usage or modification to the luminaire.
- Failure to comply with the instructions in this manual may increase the risk of damage or injury and will void the warranty.
- This luminaire is not suitable for use with dimmer switches. Warranty will be void if this luminaire is used on the same circuit which has a dimmer switch.

Installation Requirements

- This luminaire must be assembled and installed by a licensed electrician.
- All wiring and installation of the luminaire must adhere to the latest local and national wiring rules. E.g. AS/NZS 3000 Electrical Installations.
- The luminaire is a Class I product and must be earthed during wiring and installation.
- Select a suitable location for installation:
 - This luminaire is suitable for indoor use only.
 - The mounting point must support 2 times the weight of the luminaire.
 - Ensure the luminaire is not installed in direct line of an air vent/system.
 - If installing a luminaire in an area prone to moisture, ensure that the area is well ventilated, and an appropriately rated exhaust fan is used if required. Damage or corrosion caused by moisture is not a product fault, and as such is not covered under warranty.
- This luminaire is not suitable for use with dimmer switches. Warranty will be void if this luminaire is used on the same circuit which has a dimmer switch.
- Take care not to pull any electrical wires during unpacking as this may damage the connection.
- Lay out all the components on a smooth surface and make sure no components are missing before assembling. If parts are missing, return the complete product to the place of purchase for inspection or replacement.
- Check whether the luminaire has been damaged during transport. Do not operate/install any product which appears damaged in any way. Return the complete product to the place of purchase for inspection, repair or replacement.
- Ensure power to the circuit you are working on has been switched OFF before commencing any electrical work.

Installation Directions

NOTE: Due to the size/weight/wiring of the luminaire, two people will be required to lift it up during the installation process.

Remove all packaging material from the product and be careful not to throw away accessories that may be hidden within the packaging material. If assembly is required, place the luminaire on a smooth non-scratch surface.

FIGURE A

WARNING: Ensure power to the circuit you are working on has been switched OFF before commencing any electrical work.

FIGURE B

1. Remove the mounting bracket from the canopy by loosening the screws on the side.
2. Use the mounting bracket as a template to mark the screw hole positions on the ceiling.
3. Install the mounting bracket onto the ceiling by using appropriately sized mounting screws. Ensure the screws used are suitable for the mounting surface and the surrounding environment.
4. Connect the mains supply wire to the terminal block. Ensure the wires are secure and no bare wires are exposed.

Mains Supply Wire

Earth – Yellow/Green

Neutral – Blue or Black

Live – Brown or Red

Luminaire Wire / Terminal Block

Yellow/Green or 

Blue or N

Brown or L

NOTE: The luminaire is a Class I product and must be earthed during wiring and installation.

5. Lift the luminaire up to the mounting bracket.
6. Secure the canopy onto the mounting bracket by tightening the screws on the side.
7. Lift up the top part of the luminaire head.
8. Remove the ring from the threaded part of the luminaire head.
9. Install the washer onto the luminaire head.
10. Install the shade onto the luminaire head.
11. Install the ring onto the threaded part of the luminaire head and secure using the tool provided.

FIGURE C

Check and ensure the luminaire is fully installed.

Turn the power back on to the circuit and switch on the luminaire to test all the lighting functions and enjoy your new luminaire.

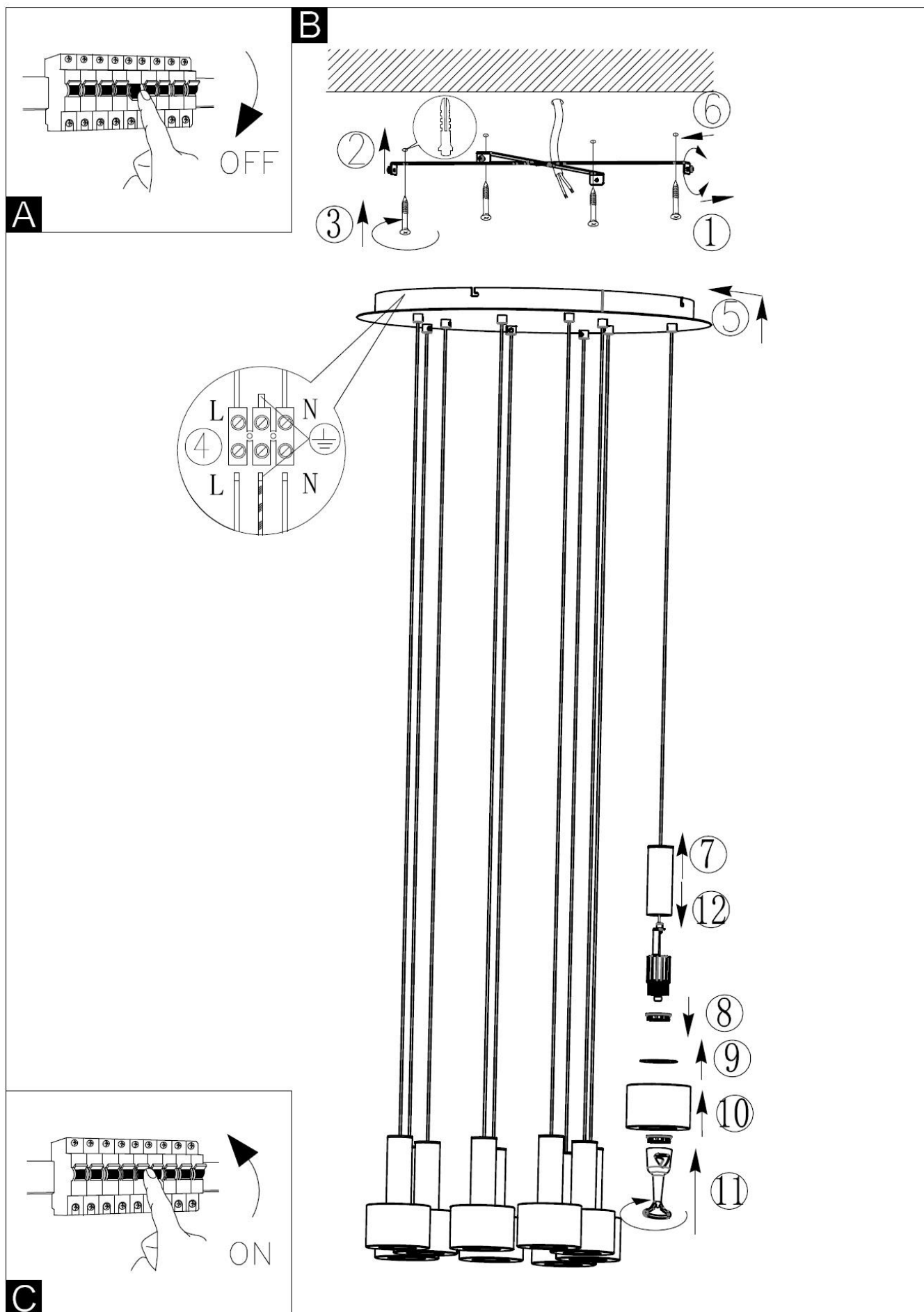

Safety Tips

- Always ensure the power is OFF and the luminaire has cooled down before performing any maintenance, cleaning, or making any adjustment to the luminaire.
- To avoid injury or damage to the luminaire, ensure that power leads and screws are secure before connecting the power.
- The light source of this luminaire is not replaceable; when the light source reaches its end of life the whole luminaire shall be replaced. There are no serviceable parts, do not attempt to dismantle or open the luminaire.
- Select a suitable location away from liquids and hazards.
- To clean, wipe with a soft damp cloth. Do NOT soak or immerse the luminaire in water or other liquids.
- Ensure that the luminaire does not come in contact with corrosive chemicals/solvents or abrasive cleaners etc

Specifications

SKU #	020676	020677
Art. No.	205604	205605
Colour	Brushed chrome with clear glass shades	Black with smoke glass shades
Rated Voltage	220-240V~ 50Hz	
Rated Wattage	35W	
LED specs	3000K, 3300 lumens, non-dimmable	3000K, 1700 lumens, non-dimmable
Weight	12.6 kg	
Canopy Dimensions	H:33mm Dia:500mm	
Luminaire Dimensions	H:159mm Dia:500mm Susp:2310mm Max.	