

24V RIBBON TRACK KIT

SKU# 140780, 140781.

Rated Voltage 24V

To ensure correct function and safety, please read and follow all instructions carefully before assembly, installation and use of this product. Please keep instructions for future reference.

NOTE: This installation instruction applies to the Skywire ribbon track only.

The driver and luminaires are sold separately.

The luminaires used must be compatible with the Skywire system.

A licensed electrician is recommended.

When working with 240V, a licensed electrician is required.

Warranty

- This product is covered by a 12-month warranty valid for in-store replacement or refund only.
- The warranty period starts from the date of purchase, not the date of installation.
- Please retain proof of purchase for any warranty enquiries.
- The warranty is subject to the Skywire track system being used with Skywire luminaires (sold separately).
- Warranty will be void if there is any damage due to improper usage or modification to the product.
- Failure to comply with the instructions in this manual may increase the risk of damage or injury and will void the warranty.

Installation Requirements

- All wiring and installation of the product must adhere to the latest local and national wiring rules.
e.g. AS/NZS 3000 Electrical Installations. If unsure, please contact a licensed electrician.

NOTE: A licensed electrician is recommended for this installation.

NOTE: When working with 240V, a licensed electrician is required.

- Do not exceed the maximum rated current.
- Select a suitable location for installation:
 - This product is suitable for indoor use only.
 - The mounting point must be a solid surface, such as concrete or a thick wooden structure. The tension on the ribbon track is 120kg (1177N).
 - The maximum mechanical loading for the ribbon track system, inclusive of the weight of luminaires and accessories is 9kg. Do not exceed this weight.
 - The ribbon track system is unsuitable for the connection of inductive loads.
 - It is the user's responsibility to ensure electrical, mechanical and thermal compatibility between the Skywire ribbon track and the luminaires (not included) attached to it.
 - If installing a luminaire in an area prone to moisture, ensure that the area is well ventilated, and an appropriately rated exhaust fan is used if required. Damage or corrosion caused by moisture is not a product fault, and as such is not covered under warranty.
- Take care not to pull any electrical wires during unpacking as this may damage the connection.
- Lay out all the components on a smooth surface and make sure no components are missing before assembling. If parts are missing, return the complete product to the place of purchase for inspection or replacement.
- Check whether the product has been damaged during transport. Do not operate/install any product which appears damaged in any way. Return the complete product to the place of purchase for inspection, repair or replacement.

INCLUDED PARTS:

Remove all packaging material from the product and be careful not to throw away accessories that may be hidden within the packaging material

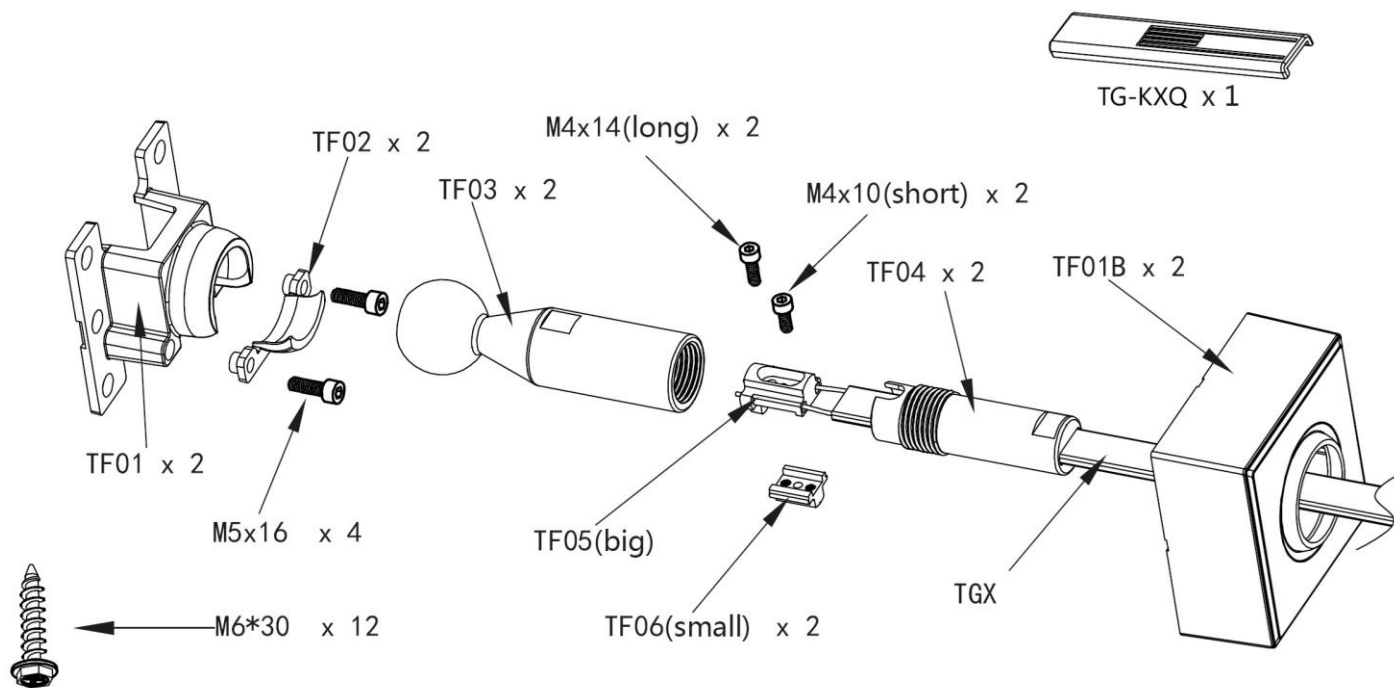

Installation Directions

WARNING: Ensure power to the circuit you are working on has been switched OFF before commencing any electrical work.

INSTALLING THE LIVE END

1. Select a suitable location for installation, see page 1 for the installation requirements.
2. Use the mounting bracket (TF01) as a template to mark the screw hole positions on the mounting surface. (Fig. A)
3. Drill the installation holes into the mounting surface. (Fig. A)
4. Install the mounting bracket (TF01) onto the mounting surface by using appropriately sized mounting screws (M6*30) and anchors. Ensure the screws (M6*30) and anchors used are suitable for the mounting surface and the surrounding environment. (Fig. A)
5. Insert the ball joint (TF03) end of the ribbon track with the wires into the mounting bracket (TF01). (Fig. B)
6. Secure the ball joint (TF03) by installing the cover (TF02) onto the mounting bracket (TF01) and secure with the screws (M5*16). (Fig. B)
7. Install the decorative cover (TF01B) over the mounting bracket (TF01). (Fig. C)

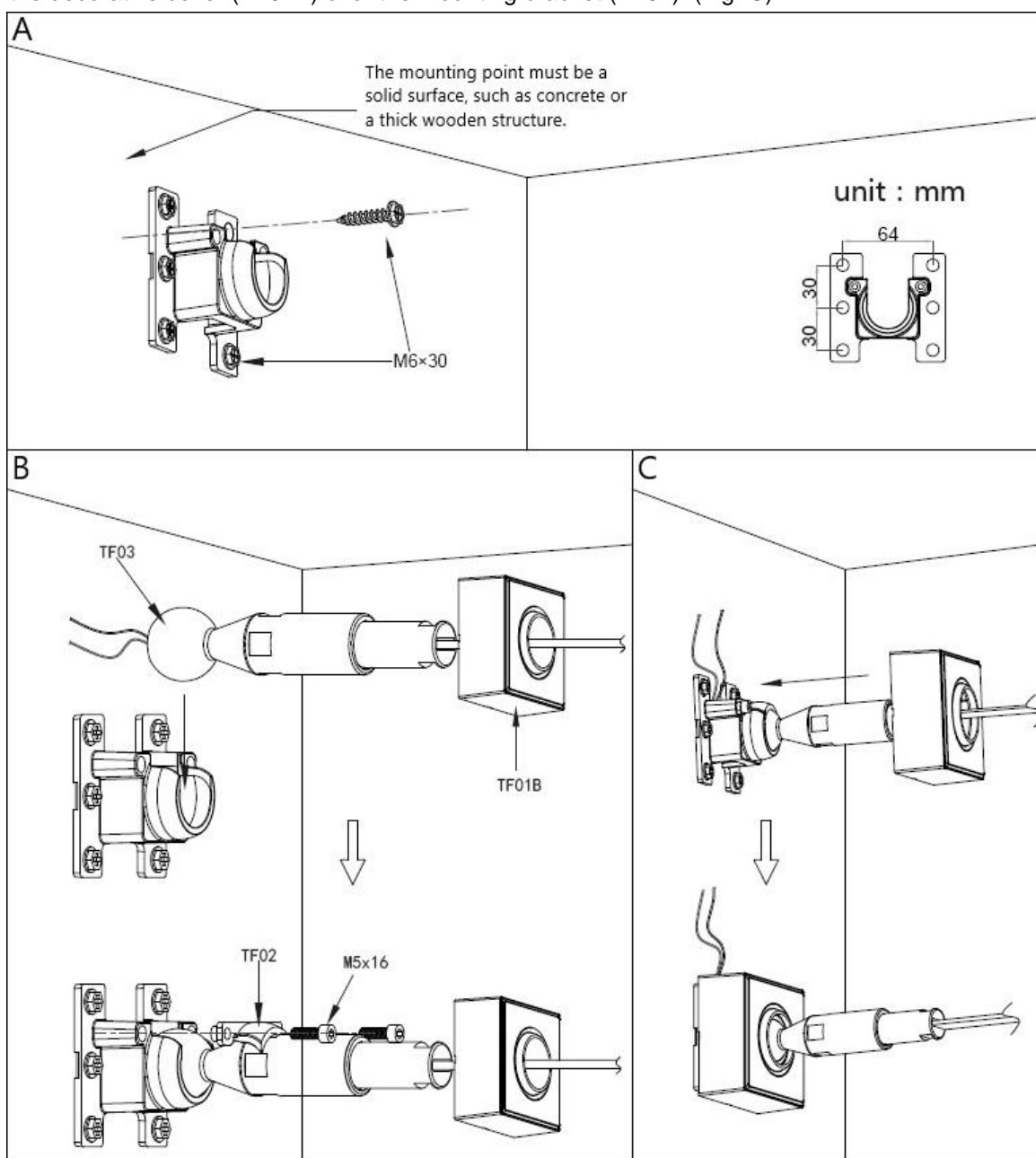

INSTALLING THE DEAD END

8. Select a suitable location for installation, see page 1 for the installation requirements.
9. Use the mounting bracket (TF01) as a template to mark the screw hole positions on the mounting surface. (Fig. D)
10. Drill the installation holes into the mounting surface. (Fig. D)
11. Install the mounting bracket (TF01) onto the mounting surface by using appropriately sized mounting screws (M6*30) and anchors. Ensure the screws (M6*30) and anchors used are suitable for the mounting surface and the surrounding environment. (Fig. D)
12. Insert the ball joint (TF03) into the mounting bracket (TF01). (Fig. E)
13. Secure the ball joint (TF03) by installing the cover (TF02) onto the mounting bracket (TF01) and secure with the screws (M5*16). (Fig. E)
14. Install the decorative cover (TF01B) over the mounting bracket (TF01). (Fig. F)
15. Straighten and align the ribbon track up to the dead end ball joint (TF03) and measure the distance. (Fig. G)

NOTE: Add an additional 30mm to the end of the ribbon track before cutting. (Fig. G)

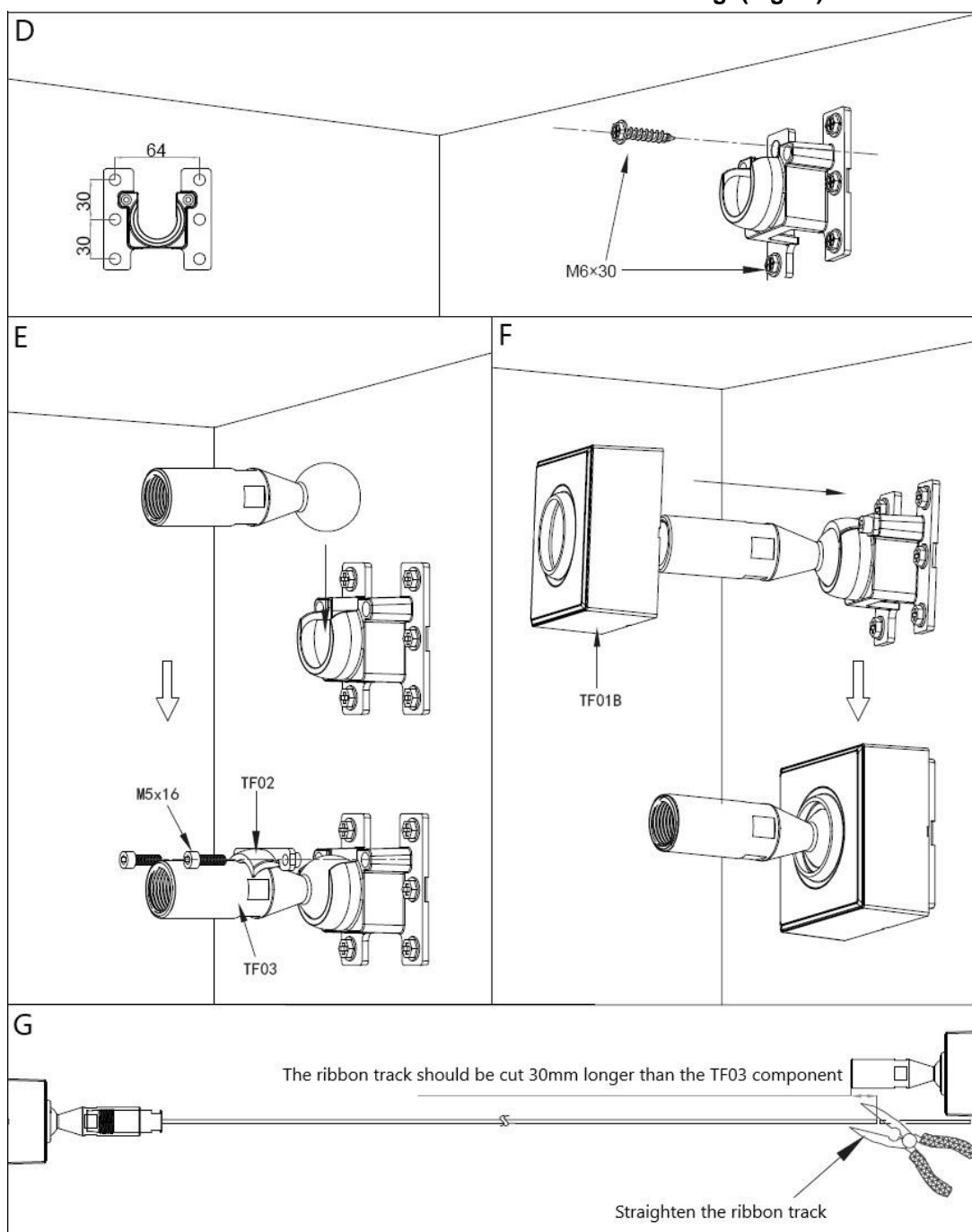

STRIPPING THE RIBBON TRACK

16. Place the wire stripper template (TG-KXQ) at the end of the ribbon track (TGX) and push down so it can stay in position. (Fig. H)
17. Use a sharp knife to cut the outer left and right sides of the wire stripper template (TG-KXQ). (Fig. H)
18. Pull and separate the sides of the ribbon track from the middle part of the ribbon track. (Fig. I)
19. Cut and remove the middle part of the ribbon track. (Fig. I)
20. Strip the ends of the ribbon track to expose the steel wire rope. (Fig. J)
21. Leave about 80mm of steel wire rope and cut off any excess. (Fig. J)
22. Insert the ribbon track into the dead end (TF04) and slide it further down. (Fig. K)
23. Insert the steel wire rope ends into the wire anchor (TF05) and install the clamp (TF06) and secure with the screw (M4x10). Ensure to leave a 4mm gap of the steel wire rope. (Fig. L)
24. Slide the dead end (TF04) to the end of the ribbon track upto the fully assembled wire anchor. (Fig. M)
25. Secure the wire anchor in the dead end (TF04) by tightening the screw (M4x14) (Fig. N)

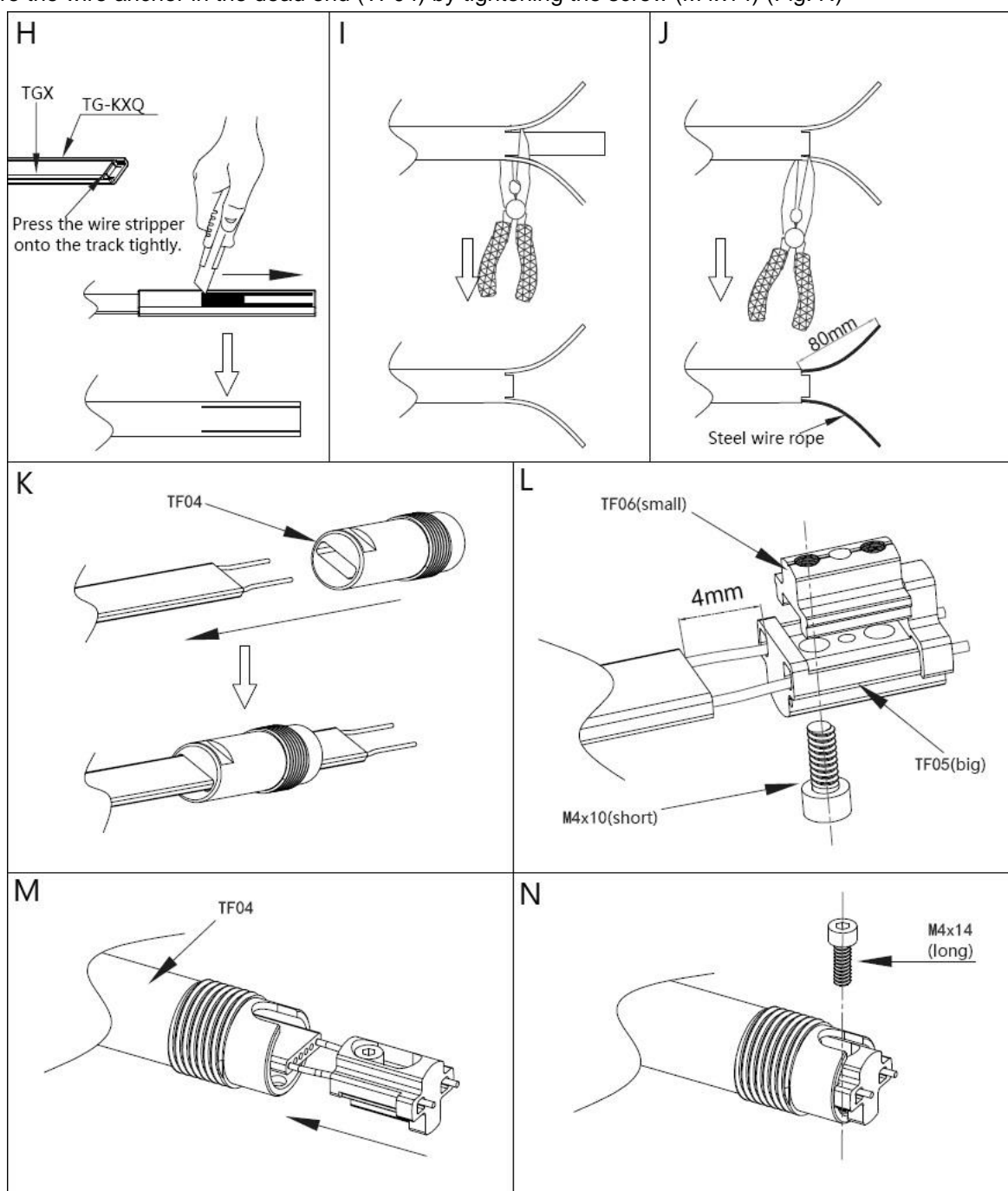

INSTALL THE DEAD END RIBBON TRACK

26. Insert the dead end (TF04) into the ball joint (TF03). Rotate the ball joint (TF03) to secure them together. (Fig. O)
27. Use a spanner to hold the dead end (TF04) stationary and continue to rotate the ball joint (TF03) to tighten the ribbon track. (Fig. P)
28. Continue to tighten the ribbon track until it is straight and no more slack. (Fig. Q)
29. After the installation is complete, install a luminaire (not included) to test and ensure the track system is working.

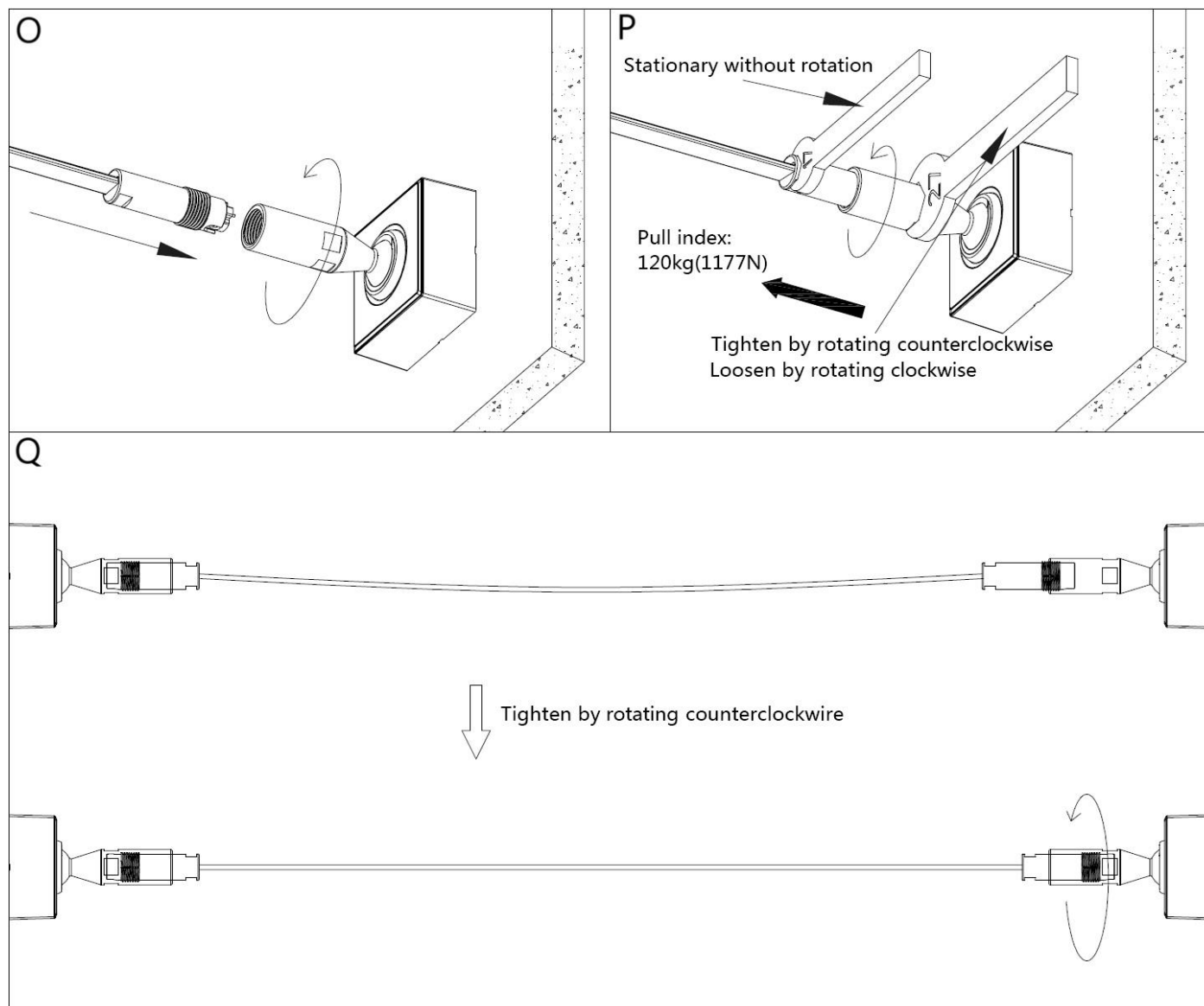

Safety Tips

- Always ensure the power is OFF and the product has cooled down before performing any maintenance, cleaning or adjustment.
- To avoid injury or damage to the product, ensure that power leads and screws are secure before connecting the power.
- To clean, wipe with a soft damp cloth. Do NOT soak or immerse the product in water or other liquids.
- Ensure that the product does not come in contact with corrosive chemicals/solvents or abrasive cleaners etc.

Specifications

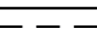
SKU #	140780	140781
Rated Voltage	24V 	
Rated Current	6.25A	
Protection Class	Class III	
Dimensions	L:5000mm W:17mm D:4mm	L:10000mm W:17mm D:4mm