

MFL RAIL TRACK KIT

SKU# 147091

Rated Voltage 220-240V~ 50Hz

To ensure correct function and safety, please read and follow all instructions carefully before assembly, installation and use of this product. Please keep instructions for future reference.

NOTE: This installation instruction applies to the track system and driver only.

The luminaires are sold separately.

The luminaires used must be compatible with the MFL Rail system.

Warranty

- This product is covered by a 12-month warranty. The warranty is from date of purchase, not the date of installation.
- If the product is not assembled and installed by a licensed electrician, the warranty will be void.
- Please retain the proof of purchase and evidence of installation by a licensed electrician for any warranty enquiries.
- Warranty will be void if there is any damage due to improper usage or modification to the product.
- Failure to comply with the instructions in this manual may increase the risk of damage or injury and will void the warranty.

Installation Requirements

- This product must be assembled and installed by a licensed electrician.
- All wiring and installation of the product must adhere to the latest local and national wiring rules.
e.g. AS/NZS 3000 Electrical Installations.
- This is a Class II product and must be maintained during wiring and installation.
- Do not exceed the maximum rated current.
- Select a suitable location for installation:
 - This product is suitable for indoor use only.
 - The mounting point must support 2 times the weight of the track system and any attached luminaires.
 - The maximum mechanical loading for the track system, inclusive of the weight of luminaires and accessories is 2.5kg. Do not exceed this weight.
 - The track system is unsuitable for the connection of inductive loads.
 - It is the user's responsibility to ensure electrical, mechanical and thermal compatibility between the track system and luminaires attached to it.
- Take care not to pull any electrical wires during unpacking as this may damage the connection.
- Lay out all the components on a smooth surface and make sure no components are missing before assembling.
If parts are missing, return the complete product to the place of purchase for inspection or replacement.
- Check whether the product has been damaged during transport. Do not operate/install any product which appears damaged in any way. Return the complete product to the place of purchase for inspection, repair or replacement.

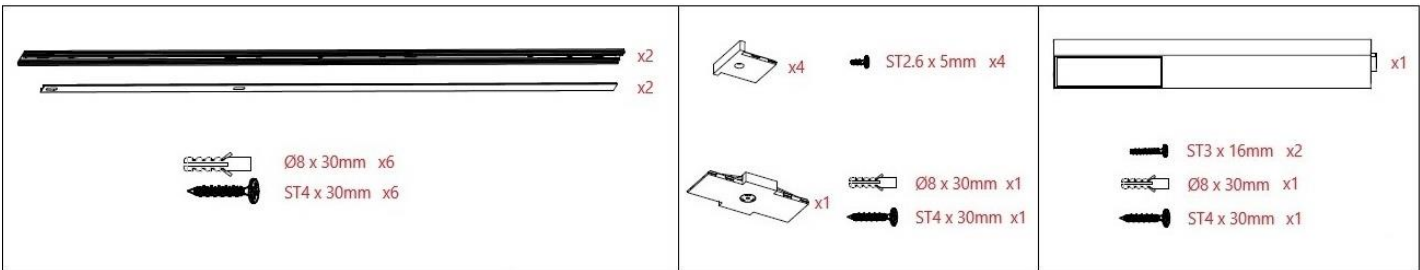

Installation Directions

WARNING: Ensure power to the circuit you are working on has been switched OFF before commencing any electrical work. (Fig. A)

- 1. Remove all packaging material from the product and be careful not to throw away accessories that may be hidden within the packaging material. If assembly is required, place the product on a smooth non-scratch surface.
- 2. Layout the track, the joiner and the dead ends on the mounting surface. (Fig. B)
- 3. Use them as a template to mark the screw hole positions on the mounting surface. (Fig. B)
- 4. Drill the installation holes onto the mounting surface.
- 5. Install the track, the joiner and the dead ends onto the mounting surface by using appropriately sized mounting screws and anchors. Ensure the screws and anchors used are suitable for the mounting surface and the surrounding environment.
- 6. Decide on the location of the LED driver:
OPTION 1: Install the driver at the end of the MFL Rail track. (Fig. C & D on page 3 and detailed picture on page 4)
OPTION 2: Install the driver at the edge of the MFL Rain track. (Fig. C & D on page 3 and detailed picture on page 4)
OPTION 3: Install the driver at the middle of the MFL Rail track. (Fig. C & D on page 3 and detailed picture on page 5)
- 7. Check and ensure there is a hole on the mounting surface OR the MFL rail track to feed the mains supply wire through to the LED driver. The mains supply wire can enter from the side or the back of the LED driver.
- 8. Install the magnetic strip onto the MFL Rail track.
- 9. Open the cover on the LED driver box by loosening the screw.
- 10. Connect the mains supply wire to the terminal block inside the LED driver box.

Mains Supply Wire	Terminal Markings
Neutral – Blue or Black	N - Neutral
Live – Brown or Red	L - Live

NOTE: This is a Class II product and must be maintained during wiring and installation.

- 11. Ensure the wires are secure and no bare wires are exposed.
- 12. Place the mains supply wire into the cord-anchorage and secure by tightening the screws.
- 13. Install the driver onto the track and lock by pressing the tab at the end of the LED driver box.
- 14. Install the screw through the back of the driver enclosure to secure it to the mounting surface.
- 15. Close the cover back onto the LED driver enclosure and secure the cover with the screw.
- 16. After the installation is complete, install a luminaire (sold separately) to test and ensure the track system is working.

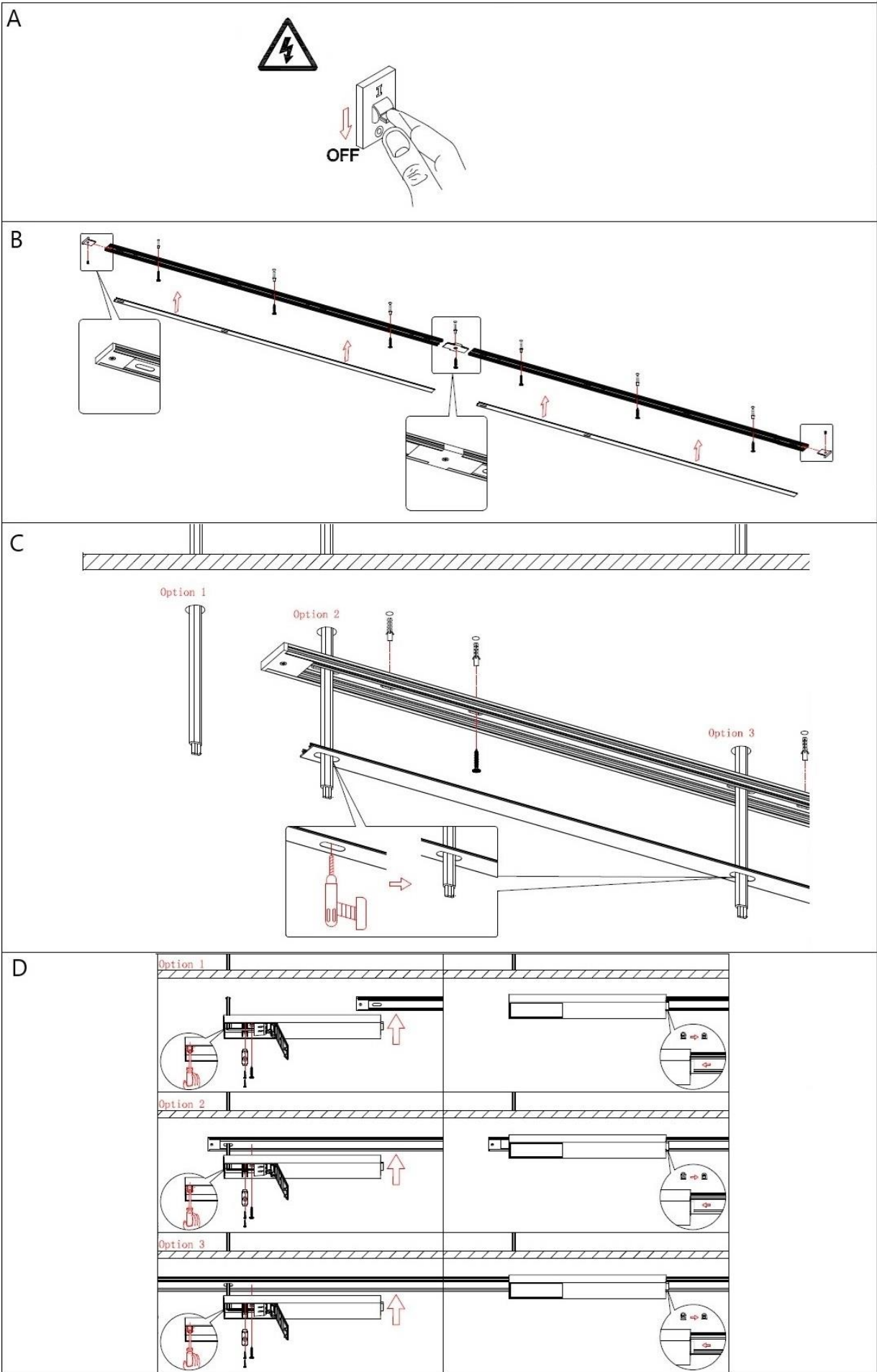

Driver location – Option 1

Install the driver at the end of the MFL rail track.

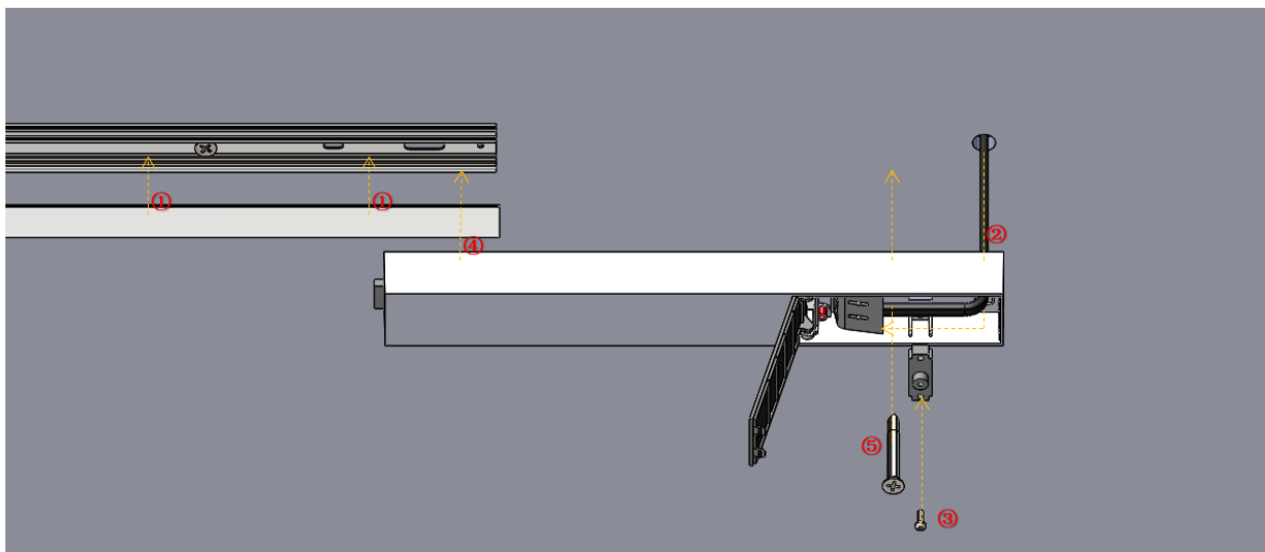

1. Install the magnetic strip onto the MFL Rail track.
2. Connect the mains supply wire to the terminal block inside the LED driver box.
3. Place the mains supply wire into the cord-anchorage and secure by tightening the screws.
4. Install the driver onto the track and lock by pressing the tab at the end of the LED driver box.
5. Install the screw through the back of the driver enclosure to secure it to the mounting surface.

Driver location – Option 2

Install the driver at the edge of the MFL Rain track

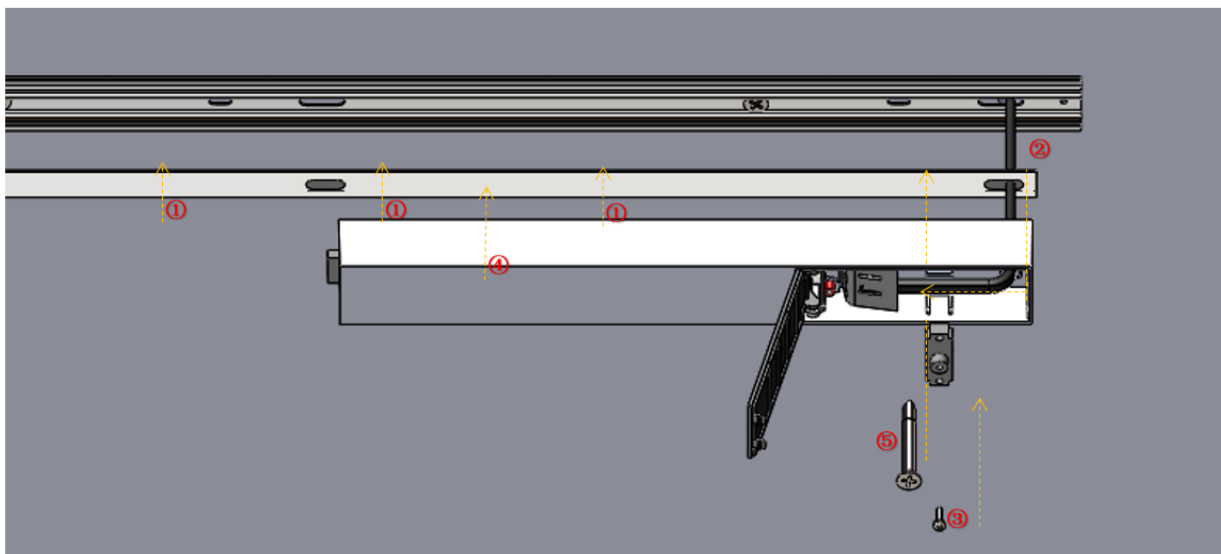

1. Install the magnetic strip onto the MFL Rail track.
2. Connect the mains supply wire to the terminal block inside the LED driver box.
3. Place the mains supply wire into the cord-anchorage and secure by tightening the screws.
4. Install the driver onto the track and lock by pressing the tab at the end of the LED driver box.
5. Install the screw through the back of the driver enclosure to secure it to the mounting surface.

Driver location – Option 3

Install the driver at the middle of the MFL Rail track

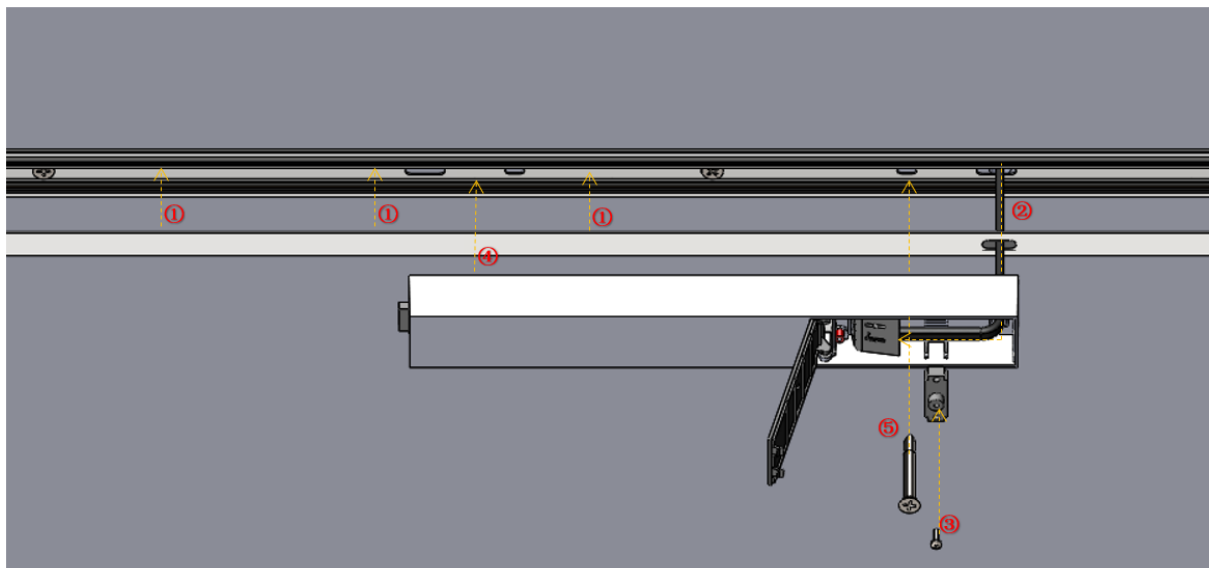

1. Install the magnetic strip onto the MFL Rail track.
2. Connect the mains supply wire to the terminal block inside the LED driver box.
3. Place the mains supply wire into the cord-anchorage and secure by tightening the screws.
4. Install the driver onto the track and lock by pressing the tab at the end of the LED driver box.
5. Install the screw through the back of the driver enclosure to secure it to the mounting surface.

Safety Tips

- Always ensure the power is OFF and the product has cooled down before performing any maintenance, cleaning or changing the lamp.
- To avoid injury or damage to the product, ensure that power leads and screws are secure before connecting the power.
- To clean, wipe with a soft damp cloth. Do NOT soak or immerse the product in water or other liquids.
- Ensure that the product does not come in contact with corrosive chemicals/solvents or abrasive cleaners etc.

Specifications

SKU #	147091
Rated Voltage	220-240V~ 50Hz
Protection Class	Class II
Kit Contents	1M track and cover: 2pcs Live joiner: 1pc 60W driver: 1pc