

## CUSTOM TRI-COLOUR LED DOWNLIGHT

SKU# 170010, 170011, 170012

Rated Voltage 220-240V~ 50Hz

Thank you for purchasing this quality Lucci product. To ensure correct function and safety, please read and follow all instructions carefully before assembly, installation and use. Please keep instructions for future reference.

### Warranty

- This LED downlight is covered by a 5-year warranty valid for in-store replacement or refund only. The warranty is from the date of purchase, not the date of installation. Please retain the proof of purchase.
- The use of non-compatible dimmers may damage your LED downlight and will void your warranty.
- Warranty will be void if there is any damage due to improper usage or modification to the LED downlight.
- Failure to comply with the instructions in this manual may increase the risk of damage or injury and will void the warranty.

### Installation Requirements

- Before installation, check the installation location in the ceiling has access to a socket outlet which is connected to a wall light switch and dimmer. If it does not, please contact a licensed electrician to arrange installation of the socket outlet, wall light switch before continuing.
- All wiring and installation of the luminaire must adhere to the latest local and national wiring rules. eg. AS/NZS 3000 Electrical installations. If unsure, please contact a licensed electrician.
- Select a suitable location for installation:
  - The mounting point must support 2 times the weight of the luminaire.
  - This luminaire is suitable for indoor use only.
  - Ensure the fitting is not installed in the direct line of an air vent/system.
  - If installing a fitting in an area prone to moisture, ensure that the area is well ventilated and an appropriately rated exhaust fan is used if required. Damage or corrosion caused by moisture is not a product fault, and as such is not covered under warranty.
- This LED downlight is dimmable and has been tested at the date of publication with the dimmers listed in the specification section. The use of a LED dimmer such as the Lucci LEDlux SKU# 290998, or SKU# 290997, SKU# 290992 or SKU# 290993, 290994 or Buster + Punch DIM-002 dimmer is highly recommended.
  - NOTE:** For the best dimming range, use the Lucci LEDlux SKU# 290998 dimmer and adjust the variable resistor at the minimum and maximum dimming positions on the dimmer during the installation.
  - NOTE:** It is recommended to adjust the dimming range of the dimmer via the variable resistor until the colour temperature of the installed luminaires is consistent at the minimum dimming position.
  - NOTE:** Dimming may cause buzzing sounds or a slight flicker. There may be slight delays with the LED downlight start-up or slight uneven light performance when more than one LED downlight is linked together, switched ON or dimmed. This is not a product fault and as such is not covered under warranty.
  - NOTE:** Some dimmers have a minimum load of 20W. Ensure the dimmer position is on the maximum setting before turning on the LED downlight and then adjust the dimmer down to your desired light level.
  - NOTE:** Testing cannot account for installation variables such as variation in mains supply voltage, cable capacitance, electrical noise, transients, surges and ripple control signals (commonly found in NSW & QLD).
  - NOTE:** The information provided is correct to the best of Beacon Lighting's knowledge at the date of publication.
- This luminaire has an insulating ceiling type IC-4 rating. Building insulation material can safely be exposed continuously to temperatures up to 90°C may abut and cover the luminaire. (Please refer to the Clearance Information section and the IC-4 Rating section in this instruction manual for further details.)

- The LED driver must be placed at least 100mm away from the LED downlight module to allow for cooling.
- The LED driver can be placed under the insulation. (Please refer to the Clearance Information section in this instruction manual for further details.)
- The LED downlight module is only suitable for use with Lucci LED Driver model#: Lucci DR-42V310-14W.
- The luminaire must not be used if the diffuser on the LED downlight module has been damaged or cracked.
- Take care not to pull any electrical wires during unpacking as this may damage the connection.
- Lay out all the components on a smooth surface and make sure no components are missing before assembling. If parts are missing, return the complete product to the place of purchase for inspection or replacement.
- Check whether the luminaire has been damaged during transport. Do not operate/install any product which appears damaged in any way. Return the complete product to the place of purchase for inspection, repair or replacement.
- Ensure power to the circuit you are working on has been switched OFF before commencing any electrical work.

## Installation Directions

Remove all packaging material from the product and be careful not to throw away accessories that may be hidden within the packaging material.

**NOTE:** Plug the luminaire into a socket outlet to ensure the LED downlight is working correctly before installation.

1. Cut an installation hole of Ø 90mm into the ceiling. (Fig.1)
2. Insert the luminaire plug into the socket outlet and ensure it is fully plugged in. (Fig.2)
3. Push the springs up and install the LED downlight module into the cut-out hole. (Fig.3)
4. Ensure all the clearance values are maintained during and after installation of the LED module, LED driver, thermal insulation, loose-fill insulation, loose combustible materials and any structural members.

**NOTE: Please refer to the Clearance Information section and the IC-4 section in this instruction manual for further details. Keep the luminaire 100mm away from the LED driver to allow for cooling. (Fig.4)**

5. Adjust the aiming angle of the downlight. The range of the aiming angle is 25° from the vertical line (Fig.5)
6. After the installation, switch on the luminaire to test all the lighting functions and enjoy your new lighting product.

**This product has a colour switching function (3000K - 5000K - 4000K):**

**NOTE: If the luminaire is installed with a dimmer, it is recommended to turn the dimmer to the highest position before adjusting the colour temperature as below.**

- Turn on the luminaire for the first time; the luminaire will switch to colour temperature 3000K.
- Turn off the luminaire, then turn it on again within 3 seconds; the luminaire will switch to colour temperature 5000K.
- Turn off the luminaire, then turn it on again within 3 seconds; the luminaire will switch to colour temperature 4000K.
- If the luminaire is turned off for more than 7 seconds, it will keep the same colour temperature as it was last on.
- The colour temperature will reset to 3000K if the switch is turned on/off quickly twice within 1 second. Repeat if it doesn't reset.

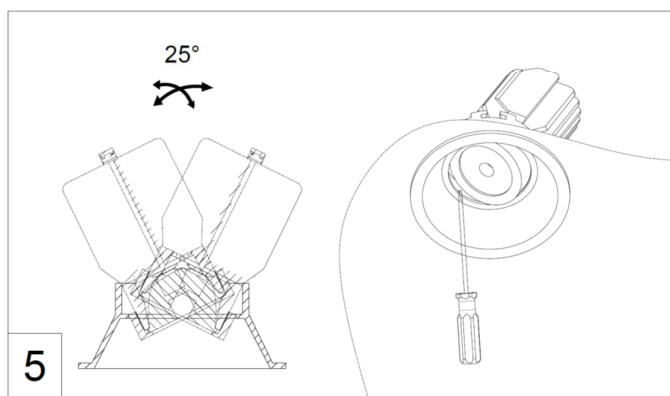
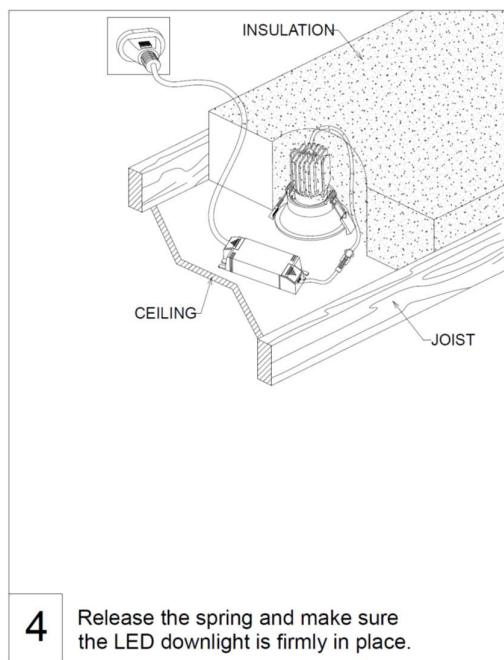
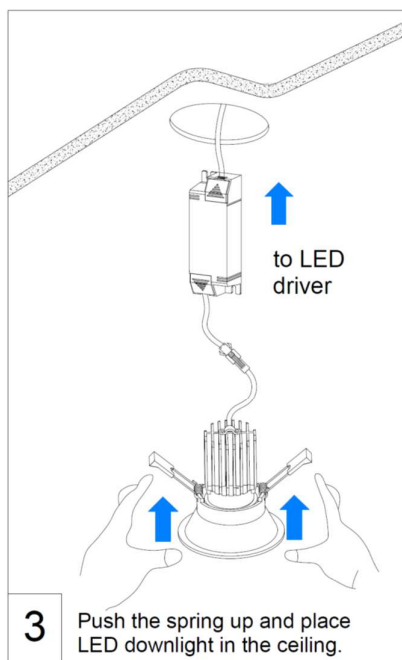
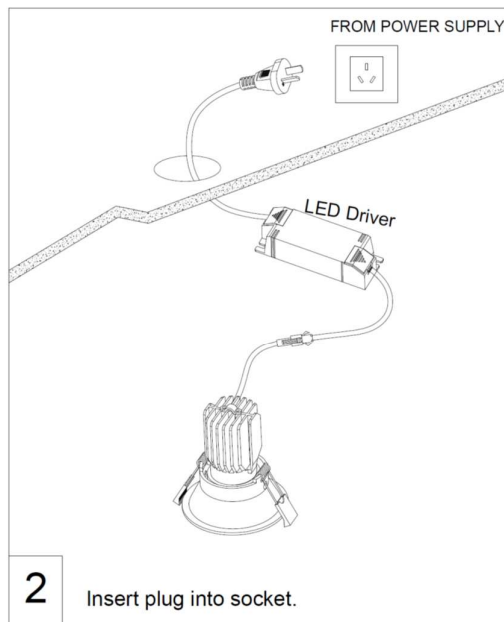
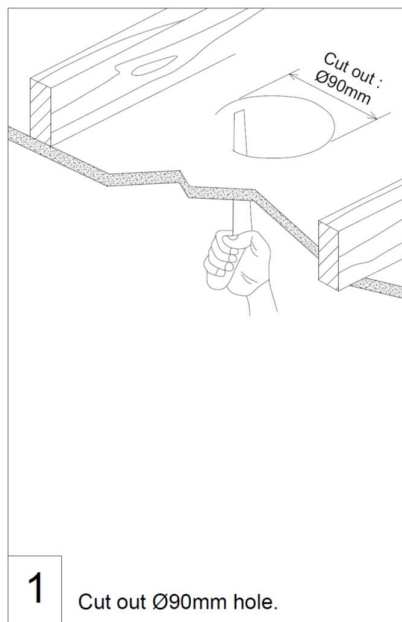

**Clearance Information – AS/NZS 3000:2018 Wiring Rules Figure 4.9**

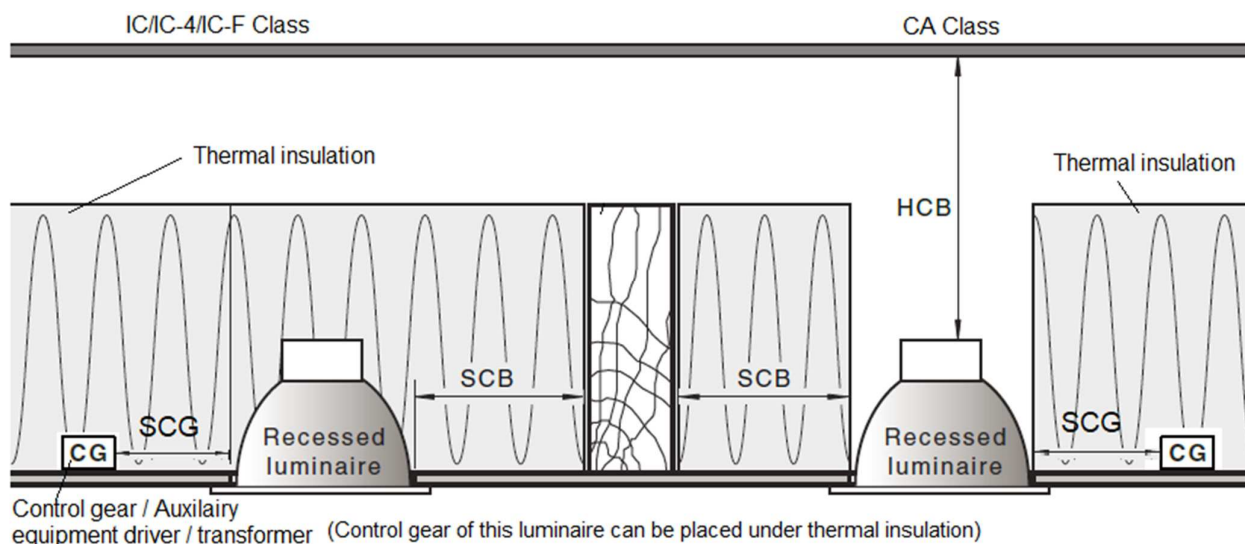

LOCATION	DISTANCE	DESCRIPTION
HCB	N/A (Minimum)	Clearance between the top of the recessed luminaire and any structural members, building elements or objects above it.
SCB	0 mm (Minimum)	Clearance between the side of the recessed luminaire and any structural members, building elements or objects.
SCI	0 mm (Abutted)	Insulation can be abutted against the side of the recessed luminaire and covered as per IC-4 Rating. See IC-4 Rating section for more details.
SCG	100mm	Auxiliary equipment/driver/transformer must be placed 100mm away from the luminaire. It can be placed under the thermal insulation and covered.

**IC Rating – AS/NZS 60598.2.2: 2016**

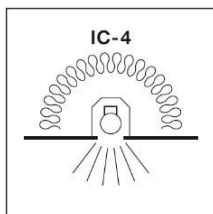

1. A closed luminaire that allows building insulation to come into contact with its sides and to cover it.
2. Type IC-4 recessed luminaire can be used together with building insulation that can safely be exposed continuously to temperatures up to 90°C may abut and cover the luminaire;
3. Building elements can be abutted against the recessed luminaire.

## Safety tips

- Always ensure the power is OFF and the luminaire has cooled down before performing any maintenance, cleaning or making any adjustment to the luminaire.
- The external flexible cable or cord of this luminaire cannot be replaced; if the cable or cord is damaged, the luminaire shall be destroyed.
- The light source of this luminaire is not replaceable; when the light source reaches its end of life the whole luminaire shall be replaced.
- To avoid injury or damage to the luminaire, ensure that power leads and screws are secure before connecting the power.
- Select a suitable location away from liquids and hazards.
- Ensure that the luminaire does not come in contact with corrosive chemicals, etc.
- To clean, wipe with a damp clean cloth. Never soak the luminaire with water.

## Troubleshooting

PROBLEM	POSSIBLE CAUSE	SUGGESTED SOLUTION
Does not work. (New installation)	Wiring loose or no power to the downlight.	Check your circuit breaker/safety switch box and turn on the power to your circuit.
		Unplug the downlight and test in a functional socket outlet with power. If the downlight does not switch on then contact your nearest Beacon Lighting store. If the downlight is working, have your licensed electrician check the wiring or socket outlet to the downlight.
Does not work. (Existing installation)	No power to the downlight.	Check your circuit breaker/safety switch box and turn on the power to your circuit.
		Contact your nearest Beacon Lighting store.
Flickers when dimming. (New installation)	Non-compatible dimmer used.	Check the dimmer used. Ensure the dimmer used is on the list of compatible dimmers in this manual.
	Some dimmers have a variable loading adjustment function. eg. Lucci LEDlux SKU# 290998 dimmer. This may not have been adjusted during the installation of the dimmer.	The variable resistor needs to be adjusted to suit the downlight load to reduce the flickering.
Flickers when dimming. (Existing installation)	Dimmer position on low.	Ensure the dimmer position is on the maximum setting before turning on the downlights and adjust the dimmer down to your desired light level.
Buzzing sound.	Non-compatible dimmer used.	Check the dimmer used. Ensure the dimmer used is on the list of compatible dimmers in this manual.

Uneven light start-up.	Dimmer position on low when switched on.	Ensure the dimmer position is on the maximum setting before turning on the downlights and adjust the dimmer down to your desired light level.
Lights are not all with the same brightness when dim down	Very low level dimming may result in inconsistent dimming level	When multiple luminaires are installed in one circuit, you may notice small difference in illumination and some may even appear off when they are dimmed very low level. This is a normal function due to the very small current, to achieve the very low light level but allow safe movement.

Specifications			
SKU #	170010	170011	170012
Colour	White	Black	Brass
Rated Voltage	INPUT: 220-240V~ 50Hz, OUPUT: 30 - 42VDC, 310mA, constant current		
Rated Wattage	14W		
LED Specs	3000K / 5000K / 4000K, CRI > 80, Dimmable 1050 lumens* (SKU#170010), 1000 lumens* (SKU#170011), 1050 lumens* (SKU# 170012) *The lumen value is based on colour temperature 4000K. The lumen value may slightly vary for other colour temperatures.		
Dimmer Information	Highly Recommended Dimmers		Compatible Dimmers
	Lucci LEDlux SKU# 290998, Lucci LEDlux SKU# 290997, 290992 Lucci LEDlux SKU# 290993, 290994 Buster + Punch DIM-002		DIGINET LED Smart MEDM; Clipsal 31E2RUDM, 32E450TM, 32E450UDM, 31E2PUDM and 32ELEDM; HPM: Cat. 400T
Weight	0.4kg		
Cut-out Size	Ø90mm		
IP Rating	IP20		
Dimensions	D:100mm x H:110mm		
Serviceable parts	LED downlight module and LED driver are both serviceable.		
LED Driver Model #	Lucci DR-42V310-14W		