

## SURFACE CNC SURFACE MOUNT DOWNLIGHT

SKU# 170330, 170331, 170332, 170336, 170337, 170338, 170367

Rated Voltage 220-240V~ 50Hz

Thank you for purchasing this quality Lucci product. To ensure correct function and safety, please read and follow all instructions carefully before assembly, installation and use of this luminaire. Please keep instructions for future reference.

### Warranty

- This luminaire is covered by a 5-year warranty. The warranty is from date of purchase, not the date of installation.
- If the luminaire is not assembled and installed by a licensed electrician, the warranty will be void.
- Please retain proof of purchase and evidence of installation by a licensed electrician for any warranty enquiries.
- The use of non-compatible dimmers may damage your LED luminaire and will void the warranty.
- Warranty will be void if there is any damage due to improper usage or modification to the luminaire.
- Failure to comply with the instructions in this manual may increase the risk of damage or injury and will void the warranty.

### Installation Requirements

- This luminaire must be assembled and installed by a licensed electrician.
- All wiring and installation of the luminaire must adhere to the latest local and national wiring rules. E.g. AS/NZS 3000 Electrical Installations.
- This luminaire is a Class I product and must be earthed during wiring and installation.
- This luminaire is rated IP44 and must be maintained during wiring and installation.
- Select a suitable location for installation:
  - This luminaire is suitable for indoor use only.
  - The mounting point must support 2 times the weight of the luminaire.
  - This luminaire is rated against water penetration to IP44 standards, which is water splashing from any direction.
- The colour shifting function will only operate with a mechanical or relay ON/OFF switch.
- The colour shifting function will not operate with a semi-conductor ON/OFF switch.
- This luminaire is dimmable and was tested with the dimmers listed in the specification table at the date of publication.
- The use of a LED dimmer such as the Lucci LEDlux SKU# 290998, or SKU# 290997, SKU# 290992 or SKU# 299043, or Buster + Punch DIM-002, dimmer is highly recommended.

**NOTE:** For the best dimming range, use with the Lucci LEDlux SKU# 290998 dimmer and adjust the variable resistor at the minimum and maximum dimming positions on the dimmer during the installation.

**NOTE:** Dimming may cause buzzing sounds or a slight flicker. There may be slight delays with the LED luminaire start up or slight uneven light performance when more than one LED luminaire is linked together, switched ON or dimmed. This is not a product fault and as such is not covered under warranty.

**NOTE:** Some dimmers have a minimum load of 20W. Ensure the dimmer position is on the maximum setting before turning on the luminaire and adjust the dimmer down to your desired light level.

**NOTE:** Testing cannot account for installation variables such as variation in mains supply voltage, cable capacitance, electrical noise, transients, surges and ripple control signals (commonly found in NSW & QLD).

**NOTE:** The information provided is correct to the best of Beacon Lighting's knowledge at the date of publication.

- Take care not to pull any electrical wires during unpacking as this may damage the connection.
- Lay out all the components on a smooth surface and make sure no components are missing before assembling. If parts are missing, return the complete product to the place of purchase for inspection or replacement.
- Check whether the luminaire has been damaged during transport. Do not operate/install any product which appears damaged in any way. Return the complete product to the place of purchase for inspection, repair or replacement.

## Installation Directions

**NOTE: Ensure power to the circuit you are working on has been switched OFF before commencing any electrical work.**

1. Remove all packaging material from the product and be careful not to throw away accessories that may be hidden within the packaging material. If assembly is required, place the luminaire on a smooth non-scratch surface.
2. Remove the mounting bracket (A) from the luminaire by loosening the grub screws (C) with the Allen key included.
3. Use the mounting bracket (A) as a template to mark the screw positions on to the ceiling and drill the holes. (Fig. 1)
4. Install the mounting bracket (A) onto the ceiling by using appropriately sized mounting screws (F), O-ring (E) and anchors (D). (Fig. 2 & 3)

**NOTE: Ensure the mounting screws (F), O-ring (E) and anchors (D) are suitable for the mounting surface and the surrounding environment.**

5. Connect the mains supply wire to the terminal block (B).

**Mains Supply Wire**

- Earth – Yellow/Green
- Neutral – Blue or Black
- Live – Brown or Red

**Luminaire Wire / Terminal Block**

- Yellow/Green
- Blue or N
- Brown or L

**NOTE: The luminaire is a Class I product and must be earthed during wiring and installation.**

6. Ensure the wires are secure and no bare wires are exposed.
7. Install the luminaire onto the mounting bracket (A) and secure by tightening the grub screws (C) with the Allen key.
8. After the installation is complete, switch on the luminaire to test and enjoy your new lighting product.
9. To operate the colour shifting function, use the wall switch.
  - While the luminaire is on, toggle the wall switch OFF and ON again within 3 seconds.
  - The colour shifting sequence will jump from 3000K – 4000K – 5000K.
  - For the colour shifting to memorise the colour temperature, leave the wall switch OFF for over 7 seconds.
 To reset the colour shifting, toggle the wall switch OFF and ON twice within 1 second. Repeat if it doesn't reset.

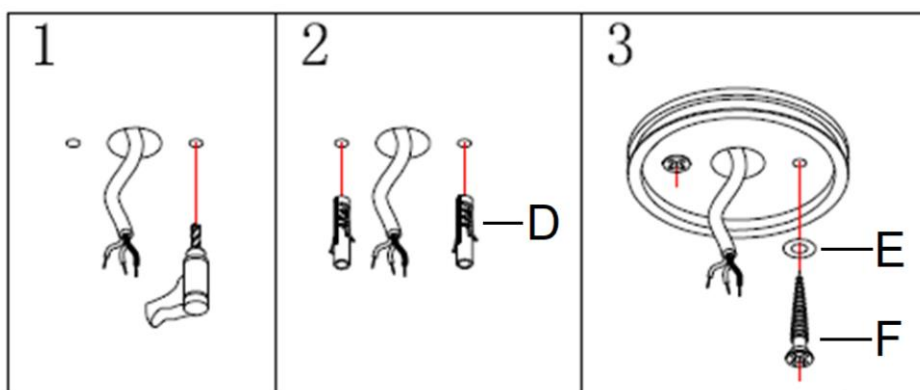
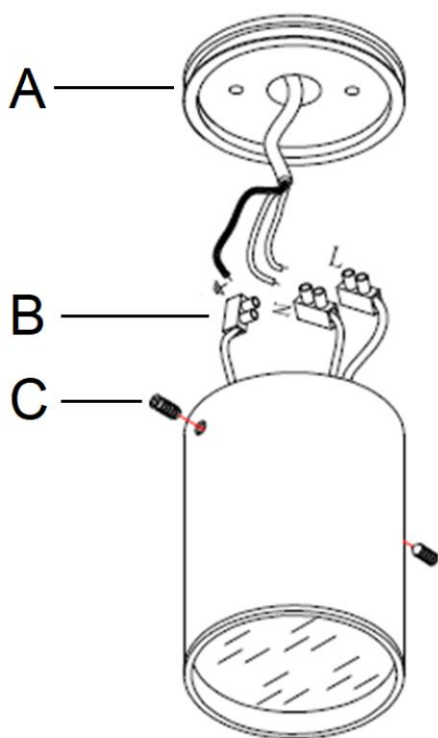

## Safety Tips

- Always ensure the power is OFF and the luminaire has cooled down before performing any maintenance, cleaning or making any adjustment to the luminaire.
- To avoid injury or damage to the luminaire, ensure that power leads and screws are secure before connecting the power.
- The light source of this luminaire is not replaceable; when the light source reaches its end of life the whole luminaire shall be replaced. There are no serviceable parts, do not attempt to dismantle or open the luminaire.
- The luminaire must not be used if the protective shield or shade has been cracked or damaged.
- To clean, wipe with a soft damp clean cloth. Do NOT soak or immerse the luminaire in water or other liquids.
- Ensure that the luminaire does not come in contact with corrosive chemicals/solvents or abrasive cleaners etc.

## Specifications

| SKU #                      | 170330  | 170336 | 170331   | 170337 | 170367       | 170332   | 170338 |
|----------------------------|---|--------|--|--------|--------------|--|--------|
| Colour                     | White   | Black  | White  | Black  | Brass Finish | White  | Black  |
| Rated Voltage              | 220-240V~ 50Hz  |        |  |        |              |  |        |
| Rated Wattage              | 9W  |        | 11W  |        |              | 11W  |        |
| Insulation Class           | Class I   |        |  |        |              |  |        |
| LED Specs                  | Colour Shifting LEDs*, Dimmable, CRI >90  |        |  |        |              |  |        |
| Lumens                     | 3000K – 630 lumens<br>4000K – 670 lumens<br>5000K – 650 lumens  |        | 3000K – 800 lumens<br>4000K – 850 lumens<br>5000K – 850 lumens |        |              | 3000K – 800 lumens<br>4000K – 850 lumens<br>5000K – 850 lumens |        |
| Highly Recommended Dimmers | Lucci LEDlux SKU# 290998.<br>Lucci LEDlux SKU# 290997, 290992.<br>Lucci LEDlux SKU# 299043.<br>Buster + Punch DIM-002.  |        |  |        |              |  |        |
| Compatible Dimmers         | Clipsal PDL354RDMLED-VW, 31E2RUDM, 32E450TM, 32E450UDM, 31E2PUDM, 32ELEDM.<br>DIGINET LED Smart MEDM.<br>HPM Cat. 400T. |        |  |        |              |  |        |
| IP Rating                  | IP44  |        |  |        |              |  |        |
| Weight                     | 0.5kg   |        | 0.5kg  |        |              | 0.6kg  |        |
| Luminaire Dimensions       | H:80mm Dia:90mm   |        | H:100mm Dia:90mm   |        |              | H:150mm Dia:90mm   |        |

**\* NOTE: The colour shifting function will only operate with a mechanical or relay ON/OFF switch.  
The colour shifting function will not operate with a semi-conductor ON/OFF switch.**