

LED RIBBON STRIP WITH SENSOR

SKU#170718

Rated Voltage 220-240V~ 50Hz

Thank you for purchasing this quality Lucci product. To ensure correct function and safety, please read and follow all instructions carefully before using the product. Please keep instructions for future reference.

Warranty

- This light fitting is covered by a 3 year warranty. The warranty is from date of purchase, not the date of installation. Please retain proof of purchase.
- Warranty will be void if there is any damage due to improper usage or modification to the fitting.
- Failure to comply with the instructions in this manual may increase the risk of damage or injury and will void warranty.

Installation requirements

- This fitting is a DIY (Do It Yourself) product. No electrical wiring connection or disconnection is required. It can be installed to the mains power socket outlet.
- All wiring and installation of the light fitting must adhere to local and national wiring rules.
eg. AS/NZS 3000:2007/Amendment 2:2012 Electrical installations.
- Select a suitable location for installation:
 - The ribbon is rated IP44 and is suitable for indoor and outdoor use.
 - The power adaptor, supply cable, sensor and connector must be installed indoors, or located away from rain or wet area.
- Take care not to pull any electrical wires during unpacking as this may damage the connection.
- Lay out all the components on a smooth surface and make sure there are no components missing before assembling. If parts are missing, return the complete product to the place of purchase for inspection or replacement.
- Check whether the fitting has been damaged during transport. Do not operate/install any product which appears damaged in any way. Return the complete product to the place of purchase for inspection, repair or replacement.
- Ensure power to the circuit you are working on has been switched OFF.

Installation directions

1. Find a suitable installation location for the power adaptor (refer to requirements above).
2. Clean the surface where the ribbon will be installed. Fig. 1

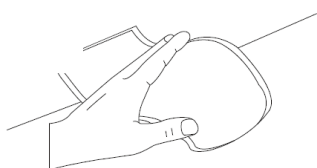

Fig. 1

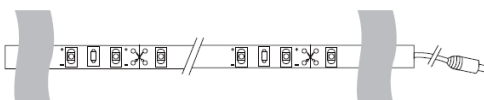

Fig.2

3. Secure the LED ribbon by using double sided tape or ribbon plastic anchorages. Fig. 2
4. Connect the LED ribbon to the sensor. Fig.3. Secure the sensor using double sided tape or screws. Fig. 4

NOTE: Choose a best installation position where the sensor can detect the body motion movement. The detection area is approximately 3.5m away, with a span of 100 degrees.

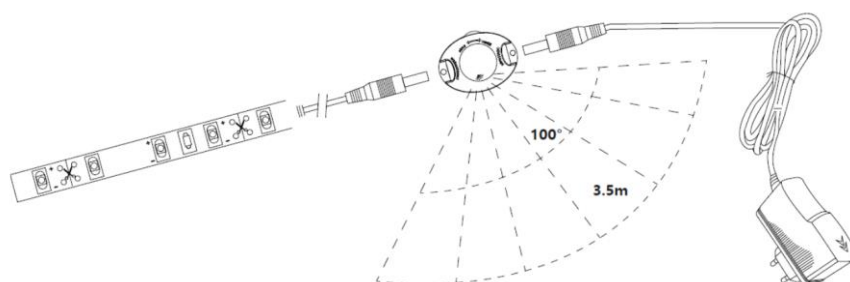

Fig. 3

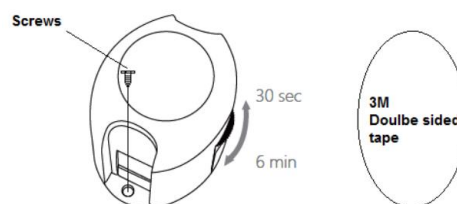

Fig. 4

5. Connect the power adaptor to the sensor. Fig. 3
6. Connect the power adaptor to the power supply.
7. Adjust the sensor timer via turning the knob. The ribbon can be set to light up for minimum 30 seconds and maximum 6 minutes. Fig. 4
8. You can cut the ribbon to your preferred length. Fig. 5

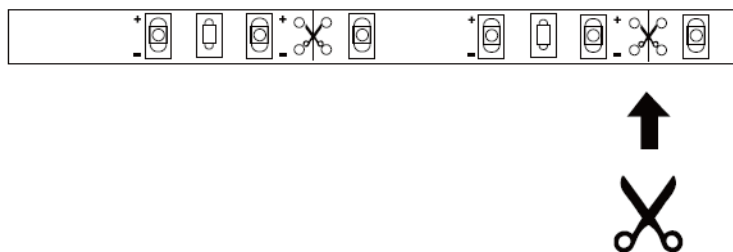

Fig.5

NOTE: If you want to test the detection area of the sensor, please wait for the ambient light level is below 3 Lux.

Safety tips

- Always ensure the power is OFF and the fitting has cooled down before performing any maintenance, cleaning or adjustment to the fitting.
- Ensure that the fitting does not come in contact with corrosive chemicals, etc.
- To clean, wipe with a damp clean cloth. Never soak the fitting with water.

Specifications

SKU #	170718
Description	LED RIBBON 1.2M WITH SENSOR
Insulation Class	Class II
Rated Voltage	220-240V~ 50Hz
Rated Wattage	3.5W
LEDs	250lm, 3000K
Weight	0.13kg
Ribbon Dimensions	1.2M
Charger	Model No.: XY-1200500-A Output voltage: 12VDC
IP Rating	IP20 for sensor and charger. IP44 for ribbon.