



LED Buddy Downlight Tri-colour

SKU# 18497L

Rated Voltage 220-240V~ 50Hz

Thank you for purchasing this quality LED product. To ensure correct function and safety, please read and follow all instructions carefully before assembly, installation and use. Please keep instructions for future reference.

Warranty

- This recessed luminaire is covered by a 3 year warranty, valid for in-store replacement or refund only.
- The warranty period starts from the date of purchase, not the date of installation. Please retain proof of purchase.
- The use of non-compatible dimmers may damage your recessed luminaire and will void your warranty.
- Warranty will be void if there is any damage due to improper usage or modification to the recessed luminaire.
- Failure to comply with the instructions in this manual may increase the risk of damage or injury and will void the warranty.

Installation Requirements

- Before installation, check the installation location in the ceiling has access to a socket outlet which is connected to a wall light switch. If it does not, please contact a licensed electrician to arrange installation of the socket outlet, wall light switch before continuing.
- All wiring and installation of the recessed luminaire must adhere to latest local and national wiring rules. eg. AS/NZS 3000 Electrical installations. If unsure, please contact a licensed electrician.
- This smart LED downlight is rated IP44. only after it is fully installed, this must be maintained during installation.
NOTE: The LED driver and the back part of the LED downlight module are rated IP40.
- Select a suitable location for installation:
- The mounting point must support 2 times the weight of the recessed luminaire.
- This recessed luminaire is suitable for indoor use, provided that, it is installed under cover or under eaves.
- This LED downlight luminaire has an insulating ceiling type IC-4 and IC-F rating. Building insulation material can safely be exposed continuously to temperatures up to 90°C may abut and cover the luminaire. (Please refer to the Clearance Information section and the IC-4/ IC-F Rating section in this instruction manual for further details.)
- This luminaire is dimmable and was tested with the dimmers listed in the specification section at the date of publication. The use of a LED dimmer such as the Lucci Power SKU# 290989, 290992, 290993, 290994, Lucci Connect SKU# 299043 or Buster + Punch DIM-002 dimmer is highly recommended.
NOTE: Dimming may cause buzzing sounds or a slight flicker. There may be slight delays with the LED luminaire start-up or uneven light performance when more than one LED luminaire is linked together, switched ON or dimmed. This is not a product fault and as such is not covered under warranty.
NOTE: Some dimmers have a minimum load of 20W. Ensure the dimmer position is on the maximum setting before turning on the LED light and adjust the dimmer down to your desired light level.
- The luminaire must not be used if the diffuser on the LED downlight module has been damaged or cracked.
- Take care not to pull any electrical wires during unpacking as this may damage the connection.
- Lay out all the components on a smooth surface and make sure there are no components missing before assembling. If parts are missing, return the complete product to the place of purchase for inspection or replacement.
- Check whether the recessed luminaire has been damaged during transport. Do not operate/install any product which appears damaged in any way. Return the complete product to the place of purchase for inspection, repair or replacement.
- Ensure power to the circuit you are working on has been switched OFF before commencing any electrical work.



Installation Directions

1. Remove all packaging material from the product and be careful not to throw away accessories that may be hidden within the packaging material.

NOTE: Plug the luminaire into a socket outlet to ensure the LED downlight is working correctly before installation.

2. Cut an installation hole of \varnothing 90mm into the ceiling. (Fig.1)
3. Select the desired colour temperature using the switch on the back of the luminaire (Figure 2).
4. Insert the luminaire plug into the socket outlet and ensure it is fully plugged in. (Fig.3)
5. Push the springs up and install the LED downlight module into the cut-out hole. (Fig.4)
6. Ensure all the clearance values are maintained during and after installation of the LED module, LED driver, thermal insulation, loose fill insulation, loose combustible materials and any structural members.

NOTE: Please refer to the Clearance Information section and the IC-4 section in this instruction manual for further details.

7. After the installation, switch on the luminaire to test all the lighting functions and enjoy your new lighting product.

NOTE: Low level dimming in the colour mode may result in inconsistent dimming levels.

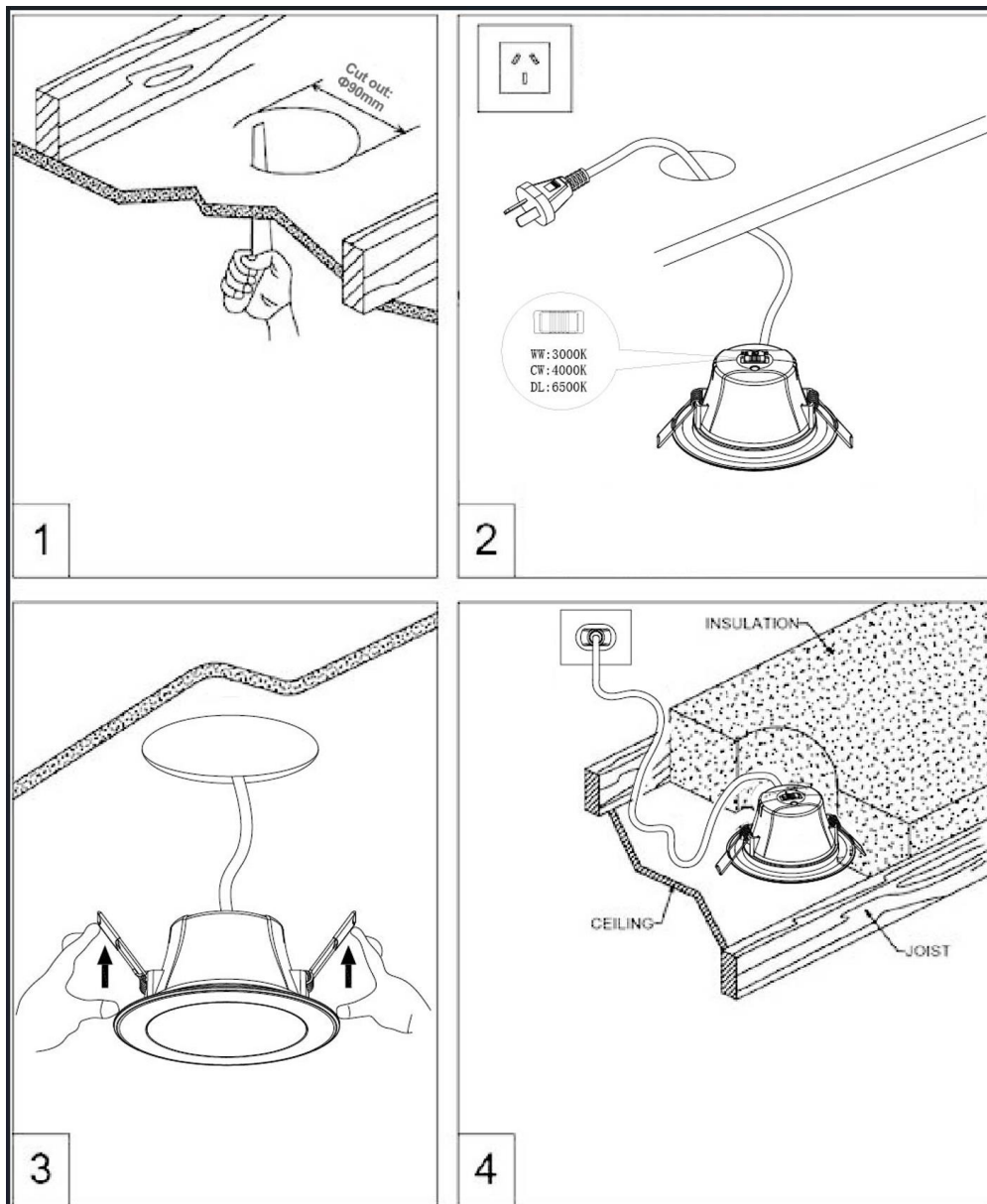



Clearance Information – AS/NZS 3000:2018 Wiring Rules Figure 4.9

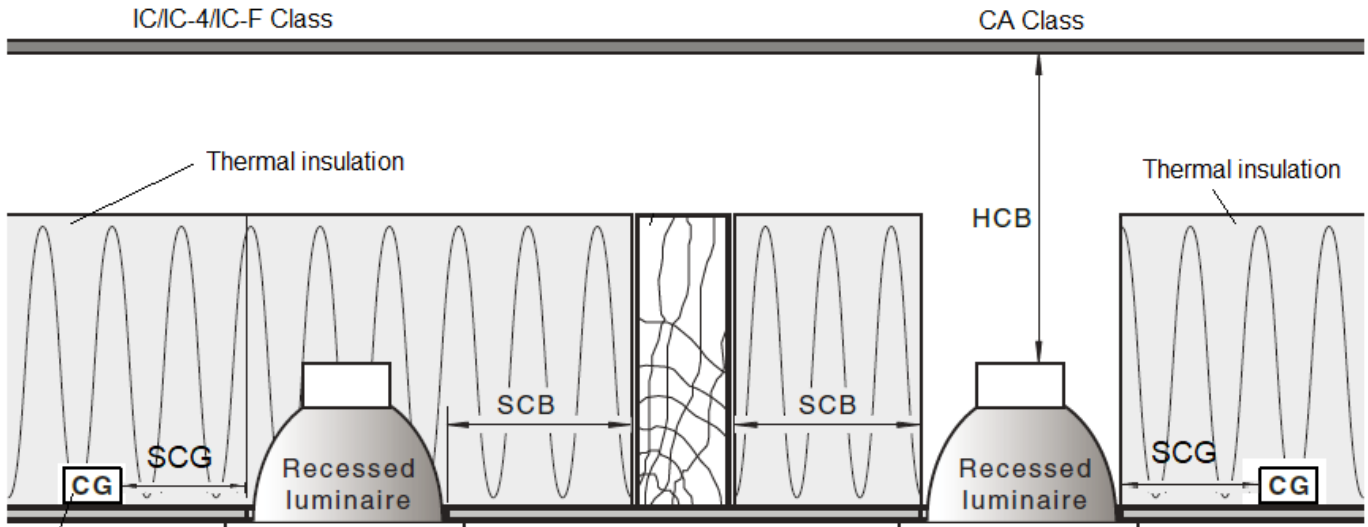

Control gear / Auxiliary equipment driver / transformer (Control gear of this luminaire can be placed under thermal insulation)

LOCATION	DISTANCE	DESCRIPTION AS/NZS 60598.2.2: 2016+A1:2017 (IC-4)
HCB	0 mm	(Height clearance to building element) Clearance between the top of the recessed luminaire and any structural members, building elements or objects above it.
MIC	0 mm	(Minimum insulation clearance) Minimum distance between the top of the recessed luminaire and the building insulation above it.
SCB	0 mm	(Side clearance to building element) Minimum distance between the side of the recessed luminaire and any building element as specified in AS/NZS 3000
SCI	0 mm	(Side clearance to insulation) Minimum distance between the recessed luminaire and any building insulation.
SCG	N/A	Auxiliary equipment/driver/transformer clearance requirement SCG is not applicable for this type of downlight construction.
LOCATION	DISTANCE	DESCRIPTION AS/NZS 60598.2.2: 2001/AMD A (IC-F)
HCB	0 mm	Clearance between the top of the recessed luminaire and any structural members, building elements or objects above it.
SCB	0 mm	Clearance between the side of the recessed luminaire and any structural members, building elements or objects.



IC Rating – AS/NZS 60598.2.2: 2016+A1:2017 (For Australia)

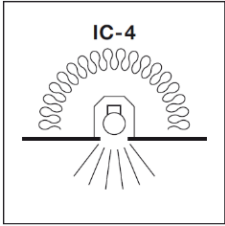

A recessed luminaire that can be abutted against normally flammable materials, including building insulation, and can be covered in normal use. Building elements, building insulation or debris have restricted access to the heated parts of the luminaire. This classification of recessed luminaire is effectively a sealed unit that has a restricted flow of air between the habitable room the luminaire emits light into and the void/space where the main body of the luminaire is located.

SCG for independent LED driver is Not Applicable.

RISK OF FIRE – WARNING — RISK OF OVERHEATING OR FIRE IF THE CLEARANCE DISTANCES ARE COMPROMISED.

IC-F Rating –AS/NZS 60598.2.2: 2001/AMD A (For New Zealand)



1. A closed luminaire that allows building insulation to come into contact with its sides and to cover it.
2. Type IC-F recessed luminaire can be used together with building insulation that can safely be exposed continuously to temperatures up to 90°C may abut and cover the luminaire;

RISK OF FIRE – Required clearance from structural members and building elements SCB/HCB = 0 mm

Safety tips

- Always ensure the power is OFF and the luminaire has cooled down before performing any maintenance, cleaning or making any adjustment to the luminaire.
- If the external flexible cable or cord of this luminaire is damaged, it shall be exclusively replaced by the manufacturer or his service agent or a similar qualified person in order to avoid a hazard.
- The light source of this luminaire is not replaceable; when the light source reaches its end of life the whole luminaire shall be replaced.
- To avoid injury or damage to the luminaire, ensure that power leads and screws are secure before connecting the power.
- Select a suitable location away from liquids and hazards.
- Ensure that the luminaire does not come in contact with corrosive chemicals/solvents or abrasive cleaners etc.
- To clean, wipe with a soft damp clean cloth. Do NOT soak or immerse the product in water or other liquids.



Specifications	
SKU #	18497L
Colour	Matt White
Rated Voltage	220-240V~ 50Hz, Max. 0.030A
Rated Wattage	6.5 W
LED Specs	LED 3000K - 4000K – 6500K, CRI > 80, 800 lumens*, Dimmable *Lumen results are shown when set at 4000K; It may slightly vary at different CCT.
Highly Recommended Dimmers	Lucci Power SKU# 290989, 290992, 290993, 290994, Lucci Connect SKU# 299043, BUSTER+ PUNCH: DIM-002
Compatible Dimmers	Lucci LEDlux SKU# 290997, 290998, Clipsal 31E2RUDM, 32E450TM, 32E450UDM, 31E2PUDM, 32ELEDM, PDL354RDMLD-VW LUMEX Load Smart LT1D450LS; DIGINET LED Smart MEDM, HPM Cat. 400T.
Weight	0.16kg
Cut-out Size	Ø90mm
IP Rating	IP44 below ceiling: IP40 inside ceiling;
Dimensions	D:115 mm x H58 mm
Recessed Luminaire Classification	IC-4 (Australia only) IC-F (New Zealand only)

GE is a trademark of General Electric Company and is under license by Light Source Solutions and Light Source Solutions New Zealand Ltd. of 140 Fulton Drive Derrimut Vic 3026 Australia.