

INFINITY RGBW CCT LED DOWNLIGHT

SKU# 170810

Rated Voltage 220-240V~ 50Hz

Thank you for purchasing this quality Lucci product. To ensure correct function and safety, please read and follow all instructions carefully before assembly, installation and use. Please keep instructions for future reference.

Warranty

- This luminaire is covered by a 2 year warranty. The warranty is from date of purchase, not the date of installation. Please retain proof of purchase.
- This luminaire is not suitable for use with dimmer switches. Warranty will be void if the luminaire is used on the same circuit which has a dimmer switch.
- Warranty will be void if there is any damage due to improper usage or modification to the luminaire.
- Failure to comply with the instructions in this manual may increase the risk of damage or injury and will void warranty.

Installation Requirements

- Before installation, check the installation location in the ceiling has access to a socket outlet which is connected to a wall light switch and dimmer. If it does not, please contact a licensed electrician to arrange installation of the socket outlet, wall light switch before continuing.
- All wiring and installation of the luminaire must adhere to latest local and national wiring rules. eg. AS/NZS 3000 Electrical installations. If unsure, please contact a licensed electrician.
- The LED downlight is rated IP44 only after it is fully installed, this must be maintained during installation.
NOTE: The LED driver and the back part of the LED downlight module are rated IP20.
- Select a suitable location for installation:
 - The mounting point must support 2 times the weight of the luminaire.
 - This luminaire is suitable for indoor or outdoor use, provided that it is installed under cover or under eaves.
- This luminaire has an insulating ceiling type IC-4 rating. Building insulation material can safely be exposed continuously to temperatures up to 90°C may abut and cover the luminaire. (Please refer to the Clearance Information section and the IC-4 Rating section in this instruction manual for further details.)
- The LED driver must be placed at least 100mm away from the LED downlight module to allow for cooling.
- The LED driver can be placed under the insulation. (Please refer to the Clearance Information section in this instruction manual for further details.)
- The LED downlight module is only suitable for use with Lucci LED Driver model#: TSZ11DR-HD.
- The luminaire must not be used if the diffuser on the LED downlight module has been damaged or cracked.
- Take care not to pull any electrical wires during unpacking as this may damage the connection.
- Lay out all the components on a smooth surface and make sure there are no components missing before assembling. If parts are missing, return the complete product to the place of purchase for inspection or replacement.
- Check whether the luminaire has been damaged during transport. Do not operate/install any product which appears damaged in any way. Return the complete product to the place of purchase for inspection, repair or replacement.
- Ensure power to the circuit you are working on has been switched OFF before commencing any electrical work.

Installation Directions

Remove all packaging material from the product and be careful not to throw away accessories that may be hidden within the packaging material.

NOTE: Plug the luminaire into a socket outlet to ensure the LED downlight is working correctly before installation.

1. Cut an installation hole of Ø 85mm into the ceiling. (Fig.1)
2. Insert the luminaire plug into the socket outlet and ensure it is fully plugged in. (Fig.2)
3. Push the springs up and install the LED downlight module into the cut-out hole. (Fig.3)
4. Ensure all the clearance values are maintained during and after installation of the LED module, LED driver, thermal insulation, loose fill insulation, loose combustible materials and any structural members.

NOTE: Please refer to the Clearance Information section and the IC-4 section in this instruction manual for further details. Keep the luminaire 100mm away from the LED driver to allow for cooling.

Switch on the power then set up the wireless & in-app control according to the 'Lucci CONNECT user guide'.

NOTE: Turn on the Bluetooth function of your mobile phone before setting up.

NOTE: Low level dimming in the colour mode may result in inconsistent dimming levels.

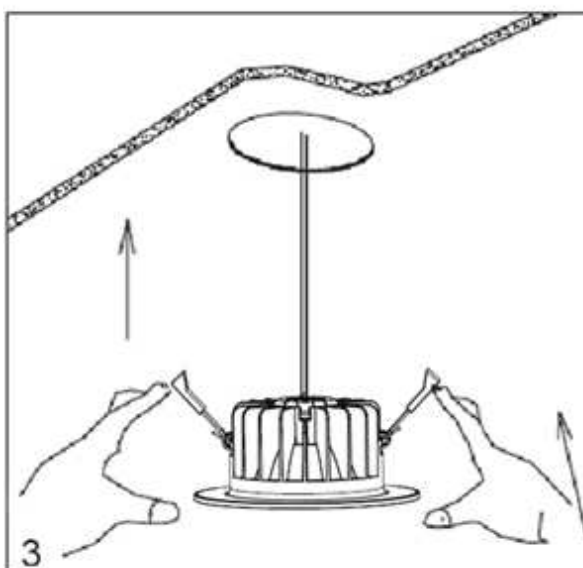
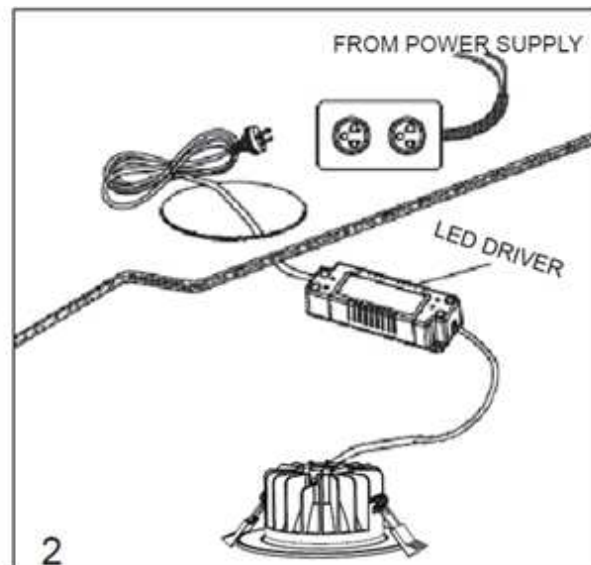
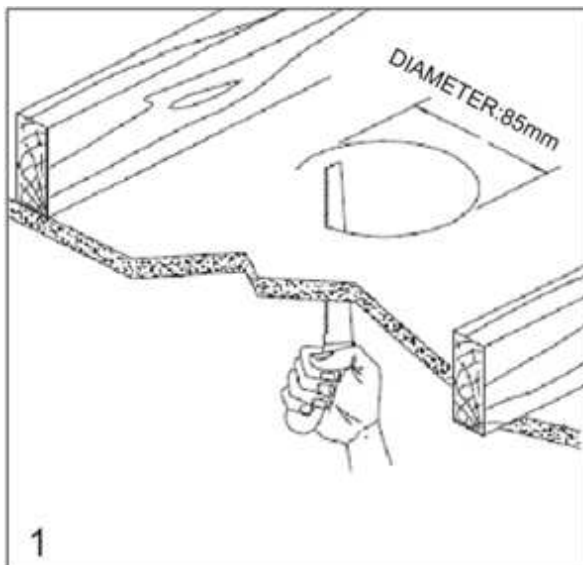

Clearance Information – AS/NZS 3000:2018 Wiring Rules Figure 4.9

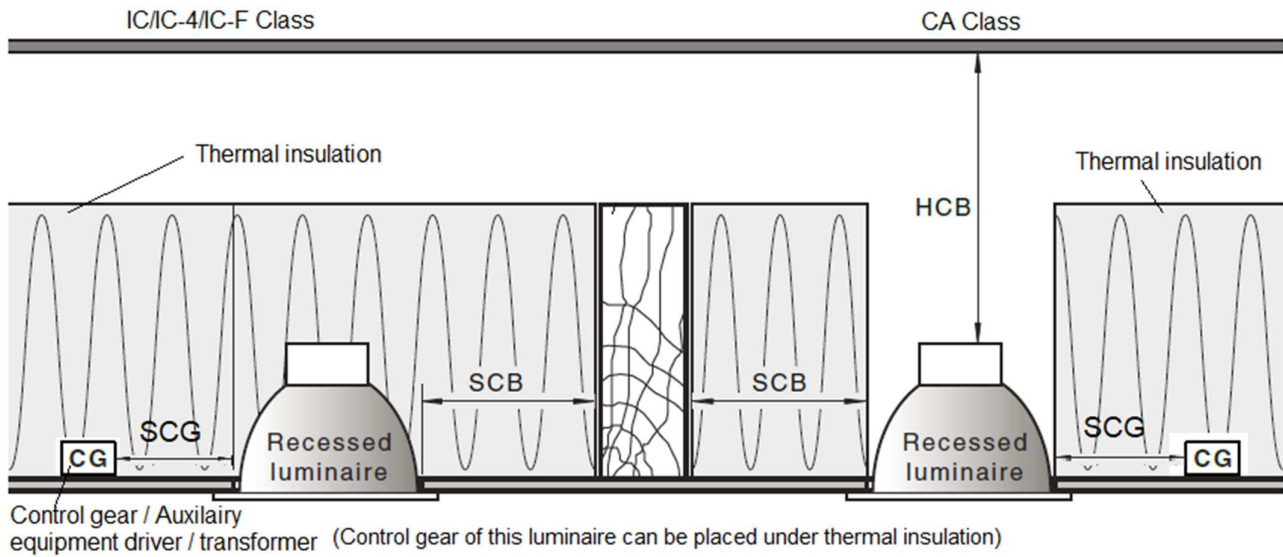

LOCATION	DISTANCE	DESCRIPTION
HCB	N/A (Minimum)	Clearance between the top of the recessed luminaire and any structural members, building elements or objects above it.
SCB	50 mm (Minimum)	Clearance between the side of the recessed luminaire and any structural members, building elements or objects.
SCI	0 mm (Abutted)	Insulation can be abutted against the side of recessed luminaire and covered as per IC-4 Rating. See IC-4 Rating section for more details.
SCG	100mm	Auxiliary equipment/driver/transformer must be placed 100mm away from the luminaire. It can be placed under the thermal insulation and covered.

IC Rating – AS/NZS 60598.2.2: 2016

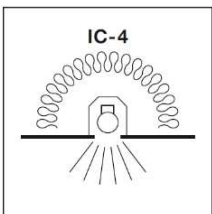

1. A closed luminaire that allows building insulation to come into contact with its sides and to cover it.
2. Type IC-4 recessed luminaire can be used together with building insulation that can safely be exposed continuously to temperatures up to 90°C may abut and cover the luminaire;

RISK OF FIRE – Required clearance from structural members and building elements
SCB = 50 mm

Safety tips

- Always ensure the power is OFF and the luminaire has cooled down before performing any maintenance, cleaning or making any adjustment to the luminaire.
- The external flexible cable or cord of this luminaire cannot be replaced; if the cable or cord is damaged, the luminaire shall be destroyed.
- The light source of this luminaire is not replaceable; when the light source reaches its end of life the whole luminaire shall be replaced.
- To avoid injury or damage to the luminaire, ensure that power leads and screws are secure before connecting the power.
- Select a suitable location away from liquids and hazards.
- Ensure that the luminaire does not come in contact with corrosive chemicals, etc.
- To clean, wipe with a damp clean cloth. Never soak the luminaire with water.

Specifications

SKU #	170810
Colour	Matt white
Rated Voltage	INPUT: 220-240V~ 50Hz, OUPUT: 33-36.5VDC, 240mA, constant current
Rated Wattage	11W
LED Specs	2700 – 6500K + RGB, CRI > 90, 750 lumens ¹⁾ , Dimmable ²⁾ 1) Lumen results are shown when set at 6500K, which may vary at different CCT & RGB setting. 2) Dimming via the Lucci Connect App, not suitable for use with dimmer switches.
Weight	0.30kg
Cut-out Size	Ø85mm
IP Rating	IP44 after installation
Dimensions	D:100mm x H:40mm
LED Driver Model #	Lucci TSZ11DR-HD
System Requirement	Android 5.0 or higher, IOS 8 or higher