

## OMEGA FLUSH MOUNT

SKU# 20289L, 20290L

Rated Voltage 220-240V~ 50Hz

To ensure correct function and safety, please read and follow all instructions carefully before assembly, installation and use of this luminaire. Please keep instructions for future reference.

### Warranty

- This luminaire is covered by a 3-year warranty. The warranty is from date of purchase, not the date of installation.
- If the luminaire is not installed by a licensed electrician, it will void the warranty.
- Please retain proof of purchase and evidence of installation by a licensed electrician for any warranty enquiries.
- This luminaire is not suitable for use with dimmer switches. The warranty will be void if this luminaire is used on the same circuit which has a dimmer switch.
- The warranty will be void if there is any damage due to improper usage or modification to the luminaire.
- Failure to comply with the instructions in this manual may increase the risk of damage or injury and will void the warranty.

### Installation Requirements

- This luminaire must be assembled and installed by a licensed electrician.
- All wiring and installation of the luminaire must adhere to latest local and national wiring rules.  
e.g. AS/NZS 3000 Electrical installations.
- This is a Class I luminaire and must be earthed during wiring and installation.
- Select a suitable location for installation:
  - This luminaire is suitable for indoor use only.
  - The mounting point must support 2 times the weight of the luminaire.
  - Ensure the luminaire is not installed in direct line of an air vent/system.
  - If installing a luminaire in an area prone to moisture, ensure that the area is well ventilated, and an appropriately rated exhaust fan is used if required. Damage or corrosion caused by moisture is not a product fault, and as such is not covered under warranty.
- This luminaire is not suitable for use with dimmer switches. The warranty will be void if this luminaire is used on the same circuit which has a dimmer switch.
- Take care not to pull any electrical wires during unpacking as this may damage the connection.
- Lay out all the components on a smooth surface and make sure no components are missing before assembling. If parts are missing, return the complete product to the place of purchase for inspection or replacement.
- Check whether the luminaire has been damaged during transport. Do not operate/install any product which appears damaged in any way. Return the complete product to the place of purchase for inspection, repair or replacement.
- Ensure power to the circuit you are working on has been switched OFF before commencing any electrical work.

## Installation Directions

Remove all packaging material from the product and be careful not to throw away accessories that may be hidden within the packaging material. If assembly is required, place the luminaire on a smooth non-scratch surface.

**WARNING: Ensure power to the circuit you are working on has been switched OFF before commencing any electrical work. (Fig. A)**

1. Loosen and remove the two screws from the side of the luminaire. (Fig. B)  
**NOTE:** Keep the screws aside in a safe place, they are required for re-installation later.
2. Twist and remove the shade from the luminaire. (Fig. B)
3. Use the luminaire as a template to mark the screw positions onto the ceiling. (Fig. C)
4. Install the luminaire onto the ceiling by using appropriately sized mounting screws and anchors. Ensure the mounting screws and anchors used are suitable for the mounting surface and the surrounding environment. (Fig. D)
5. Connect the mains supply wire to the terminal block. Ensure the mains supply wires are crimped, secure and no bare wires are exposed.

### Mains Supply Wire

Earth – Yellow/Green  
Neutral – Blue or Black  
Live – Brown or Red

### Luminaire Wire / Terminal Block

Yellow/Green or   
Blue or N  
Brown or L

**NOTE: The luminaire is a Class I luminaire and must be earthed during wiring and installation.**

6. Select the colour temperature by flicking the switch inside the luminaire. (Fig. F)
7. Install the shade back onto the luminaire and twist to hold in place. (Fig. G)
8. Secure the shade by installing and tightening the two screws on the side of the luminaire. (Fig. G)
9. After the installation, switch on the luminaire to test all the lighting functions and enjoy your new luminaire. (Fig. H)



LED

# Installation Instructions

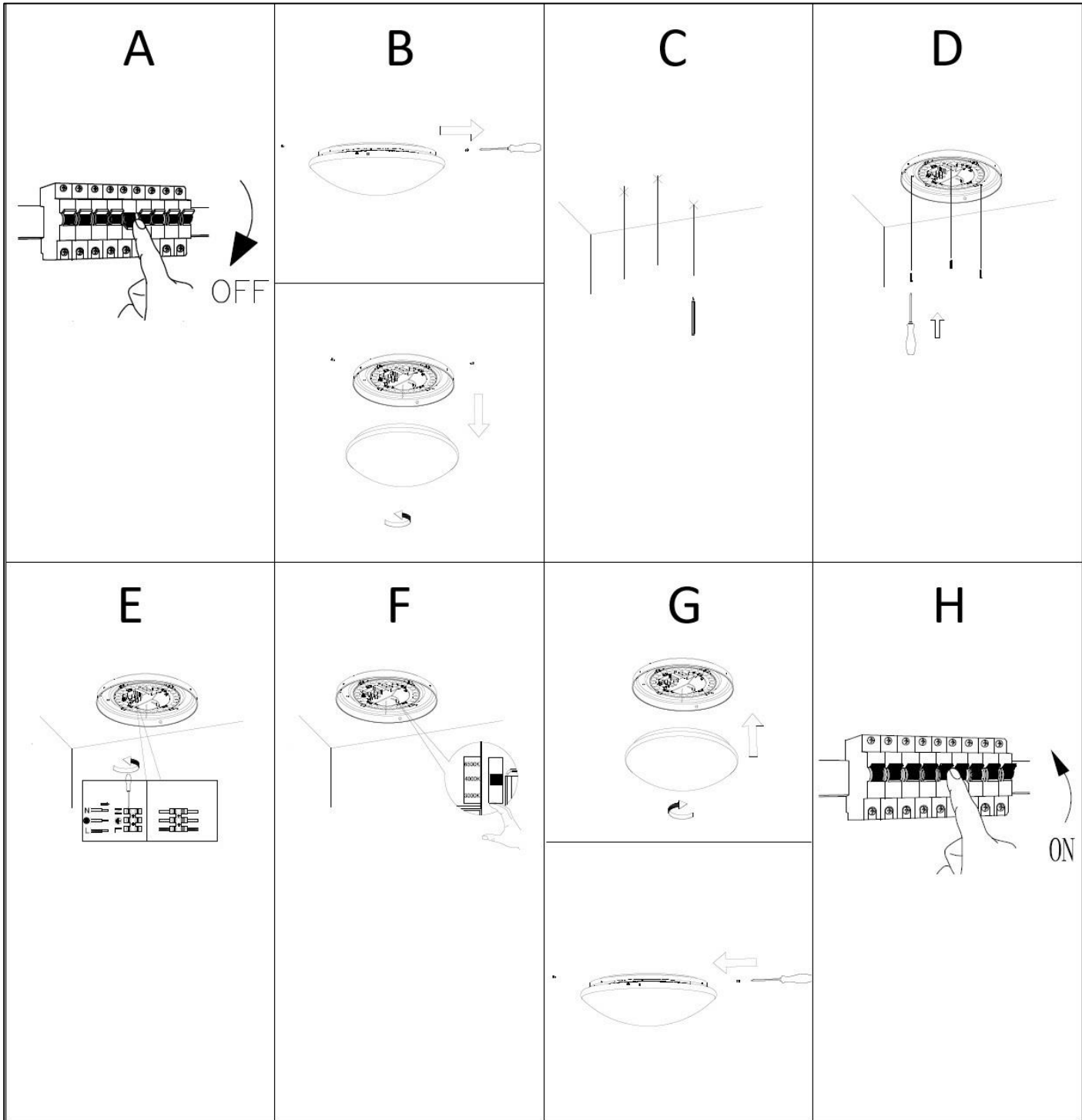



LED

# Installation Instructions

## Safety Tips

- Always ensure the power is OFF and the luminaire has cooled down before performing any maintenance, cleaning or making any adjustment to the luminaire.
- To avoid injury or damage to the luminaire, ensure that power leads and screws are secure before connecting the power.
- Select a suitable location away from liquids and hazards.
- To clean, wipe with a soft damp cloth. Do NOT soak or immerse the luminaire in water or other liquids.
- Ensure that the luminaire does not come in contact with corrosive chemicals/solvents or abrasive cleaners etc.
- The light source of this luminaire is not replaceable; when the light source reaches its end of life the whole luminaire shall be replaced. There are no serviceable parts, do not attempt to dismantle or open the product.

## Specifications

SKU #	20289L	20290L
Rated Voltage	220-240V~ 50Hz	
Rated Wattage	9W Max.	18W Max.
LED Specs	Non-dimmable, Colour switching LEDs*, CRI>80	
Rated Lumens	3000K/4000K/6500K 800 lumens Max.	3000K/4000K/6500K 1600 lumens Max.
Weight	0.4kg	0.5kg
Dimensions	H:90mm Dia:250mm	H:115mm Dia:350mm

GE is a trademark of General Electric Company and is under license by Light Source Solutions of 140 Fulton Drive, Derrimut, VIC, 3026, Australia.