

## JEDDA LED BATTEN

SKU# 189155, 189156

Rated Voltage 220-240V~ 50Hz

Thank you for purchasing this quality Bayside product. To ensure correct function and safety, please read and follow all instructions carefully before using the product, installation and use of this luminaire. Please keep instructions for future reference.

### Warranty

- This luminaire is covered by a 2 year warranty. The warranty is from date of purchase, not the date of installation.
- Please retain proof of purchase and evidence of installation by a licensed electrician for any warranty enquiries
- If the luminaire is not installed by a licensed electrician it will void the warranty.
- Warranty will be void if there is any damage due to improper usage or modification to the luminaire.
- This luminaire is not suitable for use with dimmer switches. Warranty will be void if the luminaire is used on the same circuit which has a dimmer switch.
- Failure to comply with the instructions in this manual may increase the risk of damage or injury and will void warranty.

### Installation requirements

- Must be assembled and installed by a licensed electrician.
- All wiring and installation of the luminaire must adhere to local and national wiring rules. eg. AS/NZS 3000:2007/Amendment 2:2012 Electrical installations.
- This is a CLASS I luminaire and must be earthed during installation.
- This luminaire is not suitable for use with dimmer switches and should not be used with a circuit which has a dimmer.
- Select a suitable location for installation:
  - This luminaire is suitable for indoor use only.
  - The mounting point must support 2 times the weight of the luminaire.
  - Ensure the luminaire is not installed in direct line of an air vent/system.
  - If installing a luminaire in an area prone to moisture, ensure that the area is well ventilated and an appropriately rated exhaust fan is used if required. Damage or corrosion caused by moisture is not a product fault, and as such is not covered under warranty.
- CAUTION: risk of electric shock . The light source of this luminaire is not replaceable; when the light source reaches its end of life the whole luminaire will require replacement.
- Take care not to pull any electrical wires during unpacking as this may damage the connection.
- Lay out all the components on a smooth surface and make sure there are no components missing before assembling. If parts are missing, return the complete product to the place of purchase for inspection or replacement.
- Check whether the luminaire has been damaged during transport. Do not operate/install any product which appears damaged in any way. Return the complete product to the place of purchase for inspection, repair or replacement.
- Ensure power to the circuit you are working on has been switched OFF, before commencing any electrical work.

### Installation directions

1. Remove all packaging material from the product and be careful not to throw away accessories that may be hidden within the packaging material. If assembly is required, place the luminaire on a smooth non-scratch surface.
2. Mark the screw position on the ceiling. Fig.1
3. Install the mounting brackets onto the ceiling using appropriated size mounting screws. Fig. 2  
Ensure the screws used are suitable for the mounting surface and the surrounding environment.

4. Remove the cover from the terminal box. Connect the main supply wire to the terminal block as following: (Fig. 3)

**Mains Supply Wire**

- Earth – Yellow/Green ⊕
- Neutral – Blue or Black
- Live – Brown or Red

**Fitting Wire**

- Yellow/Green ⊕
- Blue
- Brown

5. Ensure wires are secure and no bare wires are exposed.
6. Reposition the cover and secure the main supply by cord anchorage with the screws. Fig. 3
7. Press and fix the **luminaire** onto the mounting brackets. Fig.4
8. After the installation, switch on the **luminaire** to test and enjoy your new lighting product.

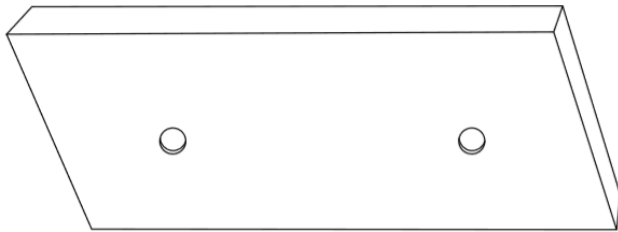

Figure 1

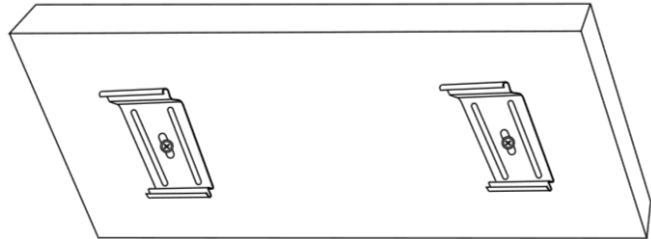

Figure 2

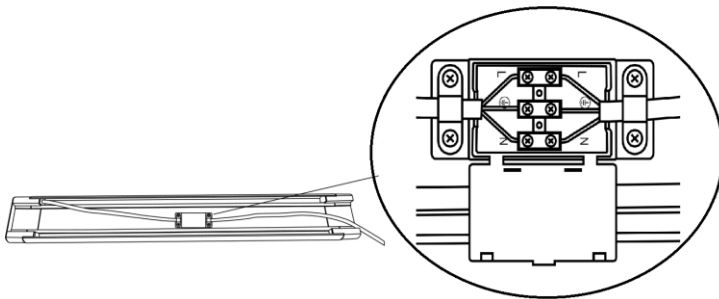

Figure 3

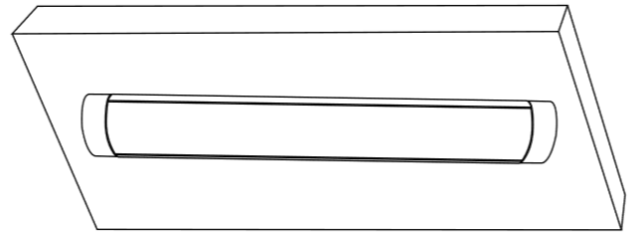

Figure 4

**Safety tips**

- Always ensure the power is OFF and the luminaire has cooled down before performing any maintenance, cleaning or adjustment to the luminaire.
- To avoid injury or damage to the luminaire, ensure that power leads and screws are secure before connecting the power.
- Select a suitable location away from liquids and hazards.
- Ensure that the luminaire does not come in contact with corrosive chemicals/solvents or abrasive cleaners etc.
- To clean, wipe with a soft damp cloth. Do NOT soak or immerse the product in water or other liquids.

**Specifications**

SKU #	189155	189156
Colour #	White	
Rated Voltage	220-240V~ 50Hz	
Rated Wattage	20W	36W
LED	Weixingxin LEDS, 4000K, 1800 lumens	Weixingxin LEDS ,4000K, 3200 lumens
Weight	0.54kg	1.0kg
IP Rating	IP20 (Whole luminaire), IP40 (light source cover)	
Dimensions	L:600mm W:80mm H:43mm	L:1200mm W:80mm H:43mm