

## KIYO 300mm LED Flush Mount with Sensor

SKU# 189256, 189257

Rated Voltage 220-240V~ 50Hz

To ensure correct function and safety, please read and follow all instructions carefully before assembly, installation and use of this product. Please keep instructions for future reference.

### Warranty

- This luminaire is covered by a 3-year warranty. The warranty is from date of purchase, not the date of installation.
- If the luminaire is not assembled and installed by a licensed electrician, the warranty will be void.
- Please retain the proof of purchase and evidence of installation by a licensed electrician for any warranty enquiries.
- This luminaire is not suitable for use with dimmer switches. The warranty will be void if this luminaire is used on the same circuit which has a dimmer switch.
- Warranty will be void if there is any damage due to improper usage or modification to the luminaire.
- Failure to comply with the instructions in this manual may increase the risk of damage or injury and will void the warranty.

### Installation Requirements

- This luminaire must be assembled and installed by a licensed electrician.
- All wiring and installation of the luminaire must adhere to the latest local and national wiring rules.  
e.g. AS/NZS 3000 Electrical Installations.
- This luminaire is a Class II product and must be maintained during wiring and installation.
- Select a suitable location for installation:
  - This luminaire is suitable for indoor or outdoor use.
  - This luminaire is suitable for ceiling mount ONLY.
  - This luminaire is NOT suitable for wall mount installations.
  - This luminaire is rated against water penetration to IP54 standards, which is water splashing from any direction.
  - The mounting point must support 2 times the weight of the luminaire.
- This luminaire is not suitable for use with dimmer switches. The warranty will be void if this luminaire is used on the same circuit which has a dimmer switch.
- Take care not to pull any electrical wires during unpacking as this may damage the connection.
- Lay out all the components on a smooth surface and make sure no components are missing before assembling.  
If parts are missing, return the complete product to the place of purchase for inspection or replacement.
- Check whether the luminaire has been damaged during transport. Do not operate/install any product which appears damaged in any way. Return the complete product to the place of purchase for inspection, repair or replacement.

### Installation Directions

**WARNING: Ensure power to the circuit you are working on has been switched OFF before commencing any electrical work. (Fig. A)**

1. Remove all packaging material from the product and be careful not to throw away accessories that may be hidden within the packaging material. Lay out all the components on a smooth surface and make sure no components are missing before assembling. If parts are missing, return the complete product to the place of purchase for inspection or replacement. (Fig. A)

2. Remove the shade from the luminaire by twisting it anti-clockwise (Fig. B).
3. Use the DIP switch to select the colour temperature you desire (Fig. C):  
 WW – Warm White  
 NW – Neutral White  
 CW – Cool White

**NOTE: When switching the colour temperature, ensure the luminaire is turned OFF. If the luminaire is not turned off, it may damage the LED driver when switching the colour temperature.**

4. Use the DIP switches to set the detection distance, duration and lux levels for the luminaire to operate. (Fig. D)

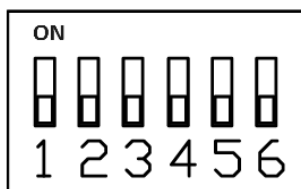

DIP Switch		DETECTION DISTANCE SETTING	
1	2	(Installation height at 3M)	
ON	ON	100%	6-8 metre detection distance.
OFF	ON	75%	4-6 metre detection distance.
ON	OFF	50%	2-4 metre detection distance.
OFF	OFF	0%	Light is always on. Sensor function has been disabled.

DIP Switch		LIGHT UP DURATION SETTING	
3	4	(If there is continuous movement detected, the luminaire will remain ON)	
ON	ON	30 seconds duration.	When there is movement detected, the luminaire will be at 100% brightness for 30 seconds. When the movement has stopped, it will reduce to 10% brightness for 30 seconds and then turn OFF.
OFF	ON	3 minutes duration.	When there is movement detected, the luminaire will be at 100% brightness for 3 minutes. When the movement has stopped, it will reduce to 10% brightness for 3 minutes and then turn OFF.
ON	OFF	5 minutes duration.	When there is movement detected, the luminaire will be at 100% brightness for 5 minutes. When the movement has stopped, it will reduce to 10% brightness for 5 minutes and then turn OFF.
OFF	OFF	10 minutes duration.	When there is movement detected, the luminaire will be at 100% brightness for 10 minutes. When the movement has stopped, it will reduce to 10% brightness for 10 minutes and then turn OFF.

DIP Switch		LUX LEVEL SETTING	
5	6		
ON	ON	10 lux.	When the surrounding light levels is more than 10 lux, the luminaire will not turn ON.
OFF	ON	30 lux.	When the surrounding light levels is more than 30 lux, the luminaire will not turn ON.
ON	OFF	50 lux.	When the surrounding light levels is more than 50 lux, the luminaire will not turn ON.
OFF	OFF	0 lux.	Day or night, the luminaire will turn ON when there is movement detected.

5. Use the luminaire as a template to mark the screw hole positions on the ceiling. (Fig. E)

**NOTE: This luminaire is suitable for ceiling mount ONLY.**

**NOTE: This luminaire is NOT suitable for wall mount installations.**

6. Install the luminaire onto the ceiling by using appropriately sized mounting screws, grommets, and anchors. Ensure the screws and anchors used are suitable for the mounting surface and the surrounding environment. (Fig. E)

**NOTE: Ensure the grommets are used to maintain the IP54 rating. (Fig. E)**

7. Connect the mains supply wire to the terminal block. (Fig. F)

## Mains Supply Wire

Neutral – Blue or Black

Live – Brown or Red

## Luminaire Wire / Terminal block

Blue or N

Brown or L

**NOTE: This luminaire is a Class II product and must be maintained during wiring and installation.**

8. Ensure the wires are secure, and no bare wires are exposed. (Fig. F)

9. Install the cover over the terminal block. (Fig. G)

**NOTE: Ensure the terminal block cover is secure and has locked into luminaire. (Fig. G)**

10. Install the shade back onto the luminaire and ensure it is secure to maintain the IP54 rating. (Fig. G)

11. After the installation, switch on the luminaire to test and enjoy your new lighting product.

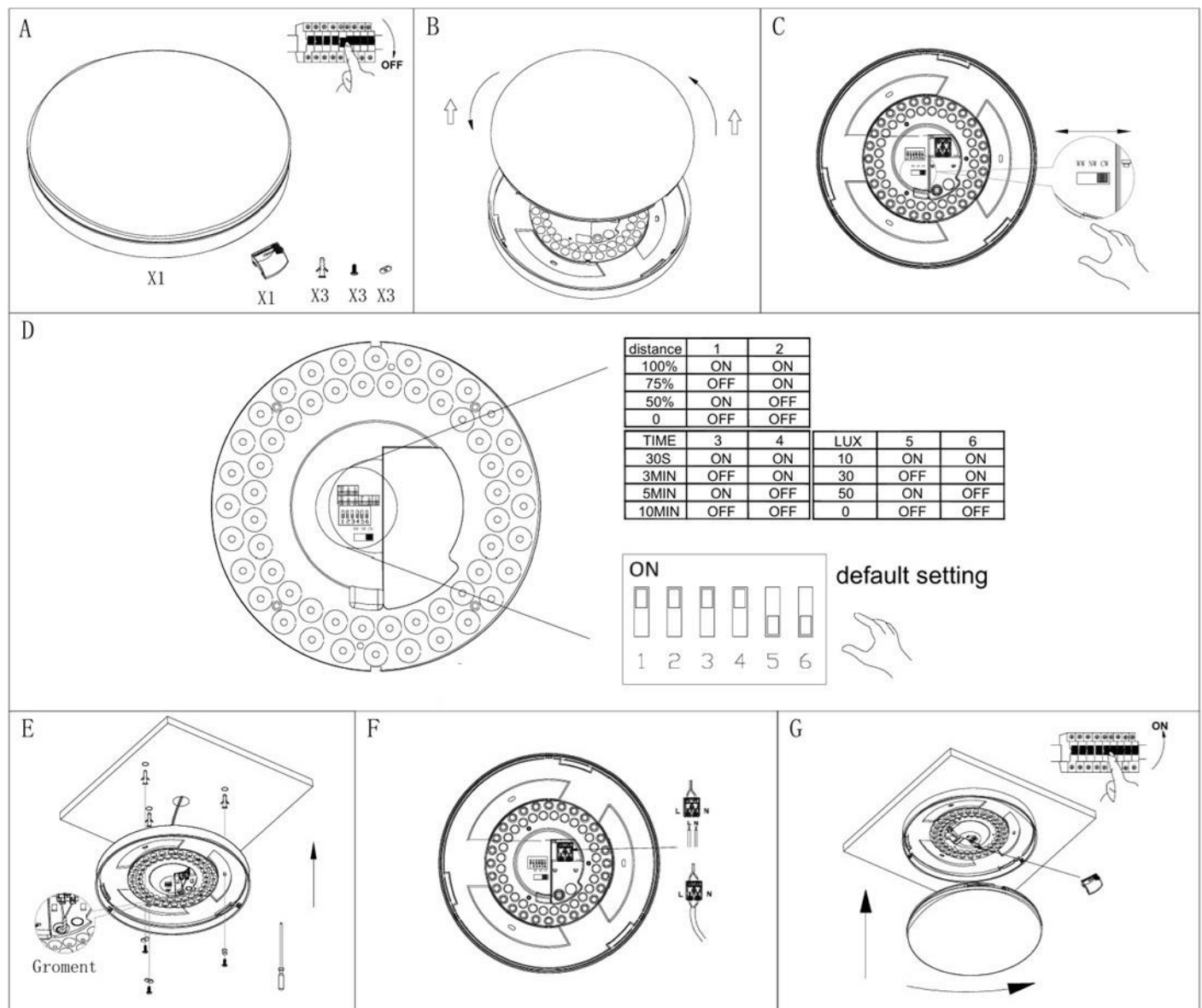

Safety Tips

- Always ensure the power is OFF and the luminaire has cooled down before performing any maintenance, cleaning, or making any adjustment to the luminaire.
- There are no serviceable parts, do not attempt to dismantle or open the luminaire.
- The light source of this luminaire is not replaceable; when the light source reaches its end of life, the whole luminaire shall be replaced.
- To avoid injury or damage to the luminaire, ensure that power leads and screws are secure before connecting the power.
- To clean wipe with a soft damp cloth. Do NOT soak or immerse the luminaire in water or other liquids.
- Ensure that the luminaire does not come in contact with corrosive chemicals/solvents or abrasive cleaners etc.

SKU #	189256	189257
Colour	White	Black
Rated Voltage	220-240V~ 50Hz	
Rated Wattage	15W Max.	
Protection Class	Class II	
LED Specs	Non-Dimmable, Colour switching LEDs, CRI≥80	
Lumens	3000K – 1300 lumens 4000K – 1500 lumens 5000K – 1400 lumens	
IP Rating	IP54	
Weight	0.5kg	
Luminaire Dimensions	H:55mm Dia:300mm	