



LED RIKER DUAL-WATT 1200MM BATTEN TRI-COLOUR

SKU# 18508L

Rated Voltage 220-240V~ 50Hz

To ensure correct function and safety, please read and follow all instructions carefully before assembly, installation and use of this product. Please keep instructions for future reference.

Warranty

- This luminaire is covered by a 3-year warranty. The warranty is from the date of purchase, not the date of installation.
- If the luminaire is not assembled and installed by a licensed electrician, the warranty will be void.
- Please retain the proof of purchase and evidence of installation by a licensed electrician for any warranty enquiries.
- Warranty will be void if there is any damage due to improper usage or modification to the luminaire.
- This luminaire is not suitable for use with dimmer switches. Warranty will be void if the luminaire is used on the same circuit, which has a dimmer switch.
- Failure to comply with the instructions in this manual may increase the risk of damage or injury and will void the warranty.

Installation Requirements

- This luminaire must be assembled and installed by a licensed electrician.
- All wiring and installation of the luminaire must adhere to the latest local and national wiring rules.
E.g. AS/NZS 3000 Electrical Installations.
- This luminaire is a Class I product and must be maintained during wiring and installation.
- Select a suitable location for installation:
 - This luminaire is suitable for indoor use only.
 - This luminaire is suitable for ceiling mount ONLY.
 - This luminaire is NOT suitable for wall mount installations.
 - The mounting point must support 2 times the weight of the luminaire.
 - Ensure the luminaire is not installed in the direct line of an air vent/system.
 - If installing a luminaire in an area prone to moisture, ensure that the area is well ventilated, and an appropriately rated exhaust fan is used if required. Damage or corrosion caused by moisture is not a product fault, and as such is not covered under warranty.
 - The luminaire is not suitable to use with dimmer switches and must not be used with a circuit which has a dimmer.
- Take care not to pull any electrical wires during unpacking as this may damage the connection.
- Lay out all the components on a smooth surface and make sure no components are missing before assembling. If parts are missing, return the complete product to the place of purchase for inspection or replacement.
- Check whether the luminaire has been damaged during transport. Do not operate/install any product which appears damaged in any way. Return the complete product to the place of purchase for inspection, repair or replacement.



Installation Directions

1. **WARNING: Ensure power to the circuit you are working on has been switched OFF, before commencing any electrical work.**

Remove all packaging material from the product and be careful not to throw away accessories that may be hidden within the packaging material.

2. Pull the LED batten away from the luminaire base at both ends.
Push the springs back from the bracket on the luminaire base at both ends to release.
Disconnect terminal A to separate the LED batten from the luminaire base.
3. Remove the terminal block cover by loosening the screw with a screwdriver (not included).
4. Use the luminaire base to mark the screw hole positions on the ceiling.
Install the luminaire onto the ceiling by using appropriately sized mounting screws.
Ensure the screws used are suitable for the mounting surface and the surrounding environment.

NOTE: This luminaire is suitable for ceiling mount ONLY.

NOTE: This luminaire is NOT suitable for wall mount installations.

5. Connect the mains supply wire to the terminal block.

Mains Supply Wire

Earth – Yellow/Green
Neutral – Blue or Black
Live – Brown or Red

Luminaire Wire / Terminal block

Yellow/Green or 
Blue or N
Brown or L

NOTE: This luminaire is a Class I product and must be maintained during wiring and installation.

Ensure the mains supply wire is double insulated.

The basic insulation is no longer than 30mm \pm 3mm.

The terminals are no longer than 8mm \pm 2mm.

Refer to diagram in figure 5.

Install the terminal block cover back over the terminal block and secure it using the screw.

6. Use the switch to select the colour temperature you desire.

30 is 3000K - Warm White

40 is 4000K - Cool White

65 is 6500K – Daylight

NOTE: The luminaire must be turned OFF before selecting the colour temperature.

If the luminaire is ON and the colour temperature is changed, this may damage the LED driver or LED chips and the warranty will be void.

Use the DIP switch located on the LED driver to select the power of the luminaire. It can be set to either 36W or 17W. After selecting the power for the luminaire, the installing licensed electrician must tick on the product rating label the corresponding wattage.

NOTE: The installing licensed electrician must select the power of the luminaire and tick off on the product rating label. This must NOT be done by non-qualified people.

7. On the LED batten, push the springs together and insert the springs into the bracket on the luminaire base.
Connect terminal A from the LED batten with the luminaire base.
8. After the installation is complete, switch on the luminaire to test and enjoy your new lighting product.

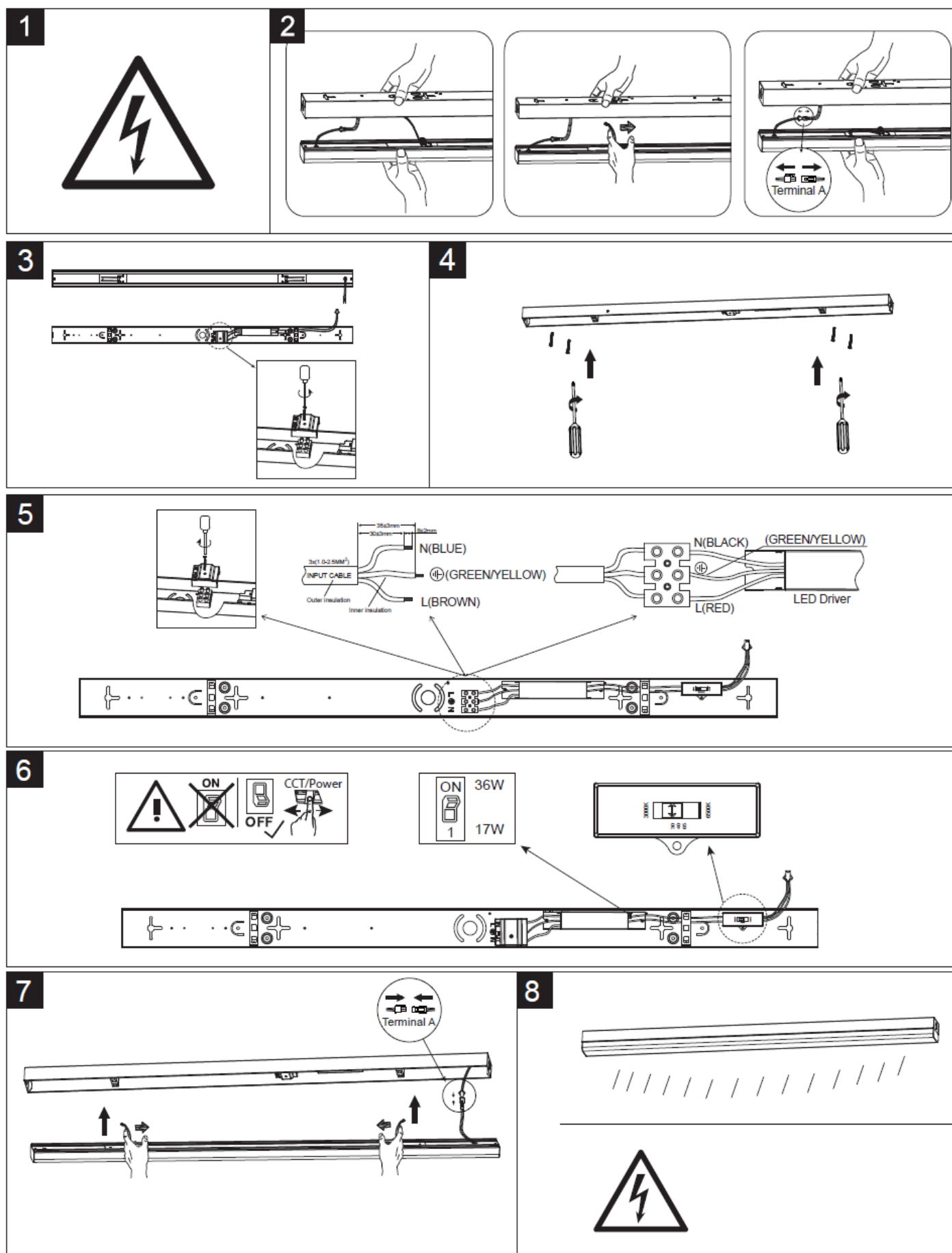



Safety Tips

- Always ensure the power is OFF and the luminaire has cooled down before performing any maintenance, cleaning or making any adjustment to the luminaire.
- To avoid injury or damage to the luminaire, ensure that power leads and screws are secure before connecting the power.
- Select a suitable location away from liquids and hazards.
- To clean, wipe with a soft damp cloth. Do NOT soak or immerse the luminaire in water or other liquids.
- Ensure that the luminaire does not come in contact with corrosive chemicals/solvents or abrasive cleaners etc.
- The light source of this luminaire is not replaceable; when the light source reaches its end of life, the whole luminaire shall be replaced.
- There are no serviceable parts, do not attempt to dismantle or open the luminaire.

Specifications

SKU #	18508L
Rated Voltage	220-240V~ 50Hz
Rated Wattage*	17W or 36W
LED Specs	Colour switching LEDs, Non-Dimmable, CRI≥80
Lumens at 17W	3000K – 2150 lumens 4000K – 2350 lumens 6500K – 2300 lumens
Lumens at 36W	3000K – 4150 lumens 4000K – 4550 lumens 6500K – 4250 lumens
Weight	1.6kg
Dimensions	H:70mm L:1200mm W:68mm

*** NOTE: The installing licensed electrician must select the power of the luminaire and tick off on the product rating label.**



is a trademark of General Electric Company and is under license by Light Source Solutions of 140 Fulton Drive Derrimut Vic 3026 Australia.