

VARILLA LED SUNSET DIMMING PENDANT

SKU# 190676, 190677

Rated Voltage 220-240V~ 50Hz

To ensure correct function and safety, please read and follow all instructions carefully before assembly, installation and use of this luminaire. Please keep instructions for future reference.

Warranty

- This luminaire is covered by a 3-year warranty. The warranty is from date of purchase, not the date of installation.
- If the luminaire is not assembled and installed by a licensed electrician, the warranty will be void.
- Please retain the proof of purchase and evidence of installation by a licensed electrician for any warranty enquiries.
- Warranty will be void if there is any damage due to improper usage or modification to the luminaire.
- Failure to comply with instructions in this manual may increase the risk of damage or injury and will void the warranty.

Installation Requirements

- This luminaire must be assembled and installed by a licensed electrician.
- All wiring and installation of the luminaire must adhere to the latest local and national wiring rules.
e.g. AS/NZS 3000 Electrical Installations.
- This luminaire is a Class I product and must be maintained during wiring and installation.
- This luminaire is rated IP44 and must be maintained during wiring and installation.
- Select a suitable location for installation:
 - This luminaire is suitable for indoor or outdoor use.
 - The mounting point must support 2 times the weight of the luminaire.
 - This luminaire is rated against water penetration to IP44 standards, which is water splashing from any direction.
- The use of a LED dimmer is strongly recommended. Please see **Highly Recommended Dimmers** Section of the Specifications on Page 4 for a list of SKUs that have been specifically designed & tested for use with this luminaire.
NOTE: Dimming may cause buzzing sounds or a slight flicker. There may be slight delays with the LED luminaire start-up or uneven light performance when more than one LED luminaire is linked together, switched ON or dimmed. This is not a product fault and as such is not covered under warranty.
NOTE: Some dimmers have a minimum load of 20W. Ensure the dimmer position is on the maximum setting before turning on the LED light and adjust the dimmer down to your desired light level.
NOTE: Testing cannot account for installation variables such as variation in mains supply voltage, cable capacitance, electrical noise, transients, surges and ripple control signals (commonly found in NSW & QLD).
NOTE: The information provided is correct to the best of Beacon Lighting's knowledge at the date of publication
- Take care not to pull any electrical wires during unpacking as this may damage the connection.
- Lay out all the components on a smooth surface and make sure no components are missing before assembling. If parts are missing, return the complete product to the place of purchase for inspection or replacement.
- Check whether the luminaire has been damaged during transport. Do not operate/install any product which appears damaged in any way. Return the complete product to the place of purchase for inspection, repair or replacement.

Installation Directions

WARNING: Ensure power to the circuit you are working on has been switched OFF before commencing any electrical work.

1. Remove all packaging material from the product and be careful not to throw away accessories that may be hidden within the packaging material. If assembly is required, place the luminaire on a smooth non-scratch surface.
2. Use the mounting bracket (B) as a template to mark the screw hole positions on the ceiling.
3. Install the mounting bracket (B) onto the ceiling by using appropriately sized mounting screws (C) and anchors (A). Ensure the screws (C) and anchors (A) used are suitable for the mounting surface and the surrounding environment.
4. Connect the mains supply wire to the terminal block (D).

Mains Supply Wire

Earth – Yellow/Green

Neutral – Blue or Black

Live – Brown or Red

Luminaire Wire / Terminal Block

Yellow/Green or 

Blue or N

Brown or L

NOTE: This luminaire is a Class I product and must be earthed during wiring and installation.

5. Ensure the wires are secure and no bare wires are exposed.

ADJUSTING THE CORD SUSPENSION LENGTH

To adjust the cord suspension length, remove the cover plate (I) from the canopy by loosening the screws (H). Follow the steps below, depending on how much you want to reduce the cord suspension length.

IF ADJUSTING THE CORD SUSPENSION LENGTH LESS THAN 15CM (Page 4 - Figure A1 – A4)

- A1. Loosen the screws from the cord anchorage in the canopy.
- A2. Pull the cord suspension up into the canopy to the desired height.
- A3. Place the cord into the cord anchorage and tighten the screws to secure the cable.
- A4. Check and ensure the cable has some slack and is not under tension.

IF ADJUSTING THE CORD SUSPENSION LENGTH MORE THAN 15CM (Page 4 - Figure B1 – B7)

- B1. Loosen the screws from the cord anchorage in the canopy.
- B2. Pull the cord suspension up into the canopy to the desired height.
- B3. Disconnect the cord from the connector.
- B4. Cut off the excess length. **NOTE: the suspension length cannot be increased again, after it has been cut.**
- B5. Insert the cord back into the connector.
- B6. Place the cord into the cord anchorage and tighten the screws to secure the cable.
- B7. Check and ensure the cable has some slack and is not under tension.

6. Join the mounting bracket (B) and luminaire together using the quick connector (E).
7. Install the luminaire onto the mounting bracket (B) and secure by tightening the grub screws (G) with an allen key (F).
8. Install the shade/diffuser (I) onto the luminaire body (H).
9. After the installation is complete, switch on the luminaire to test and enjoy your new lighting product.

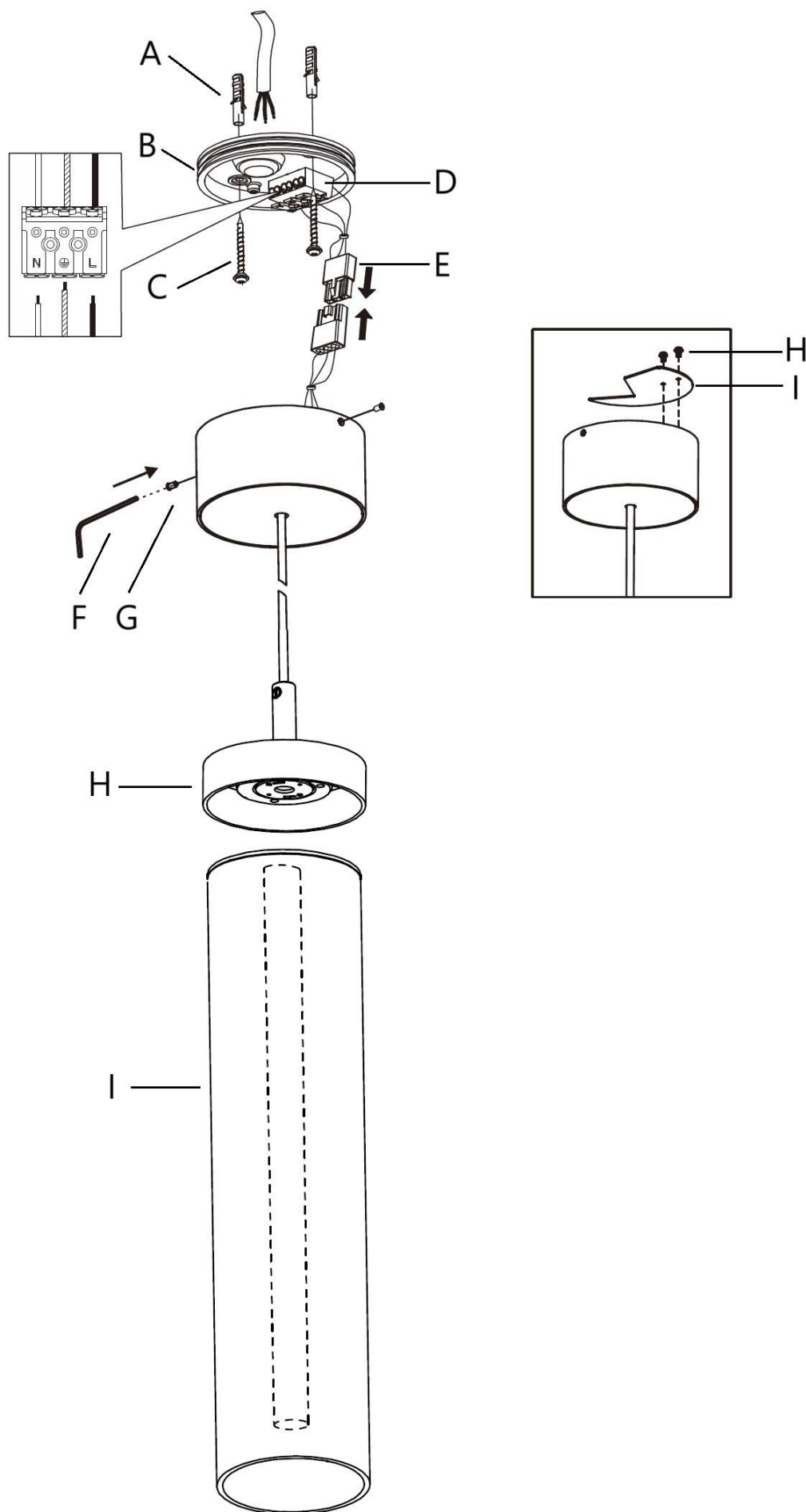

Adjusting the cord suspension <15cm

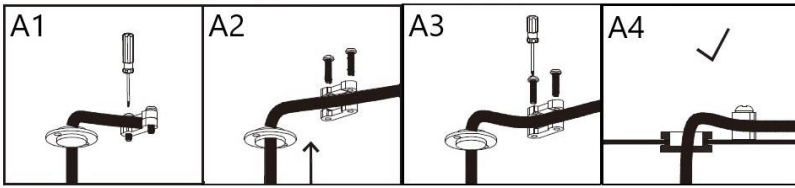

Adjusting the cord suspension >15cm

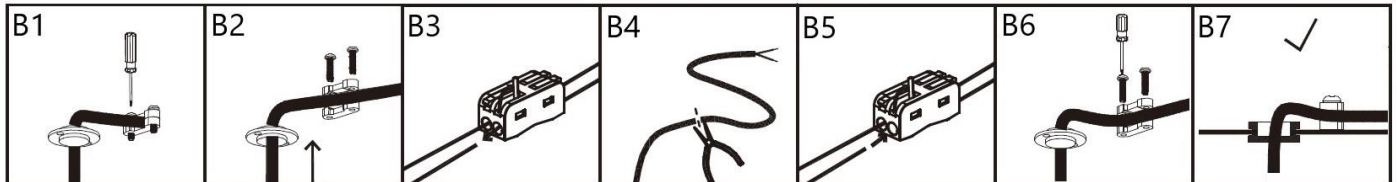

Safety Tips

- Always ensure the power is OFF and the luminaire has cooled down before performing any maintenance, cleaning or making any adjustment to the luminaire.
- To avoid injury or damage to the luminaire, ensure that power leads and screws are secure before connecting power.
- The light source of this luminaire is not replaceable; when the light source reaches its end of life, the whole luminaire shall be replaced.
- There are no user serviceable parts, do not attempt to dismantle or open the luminaire.
- To clean, wipe with a soft damp cloth. Do NOT soak or immerse the luminaire in water or other liquids.
- Ensure that the luminaire does not come in contact with corrosive chemicals/solvents or abrasive cleaners etc.

Specifications

SKU#	190676	190677
Colour	Black	White
Rated Voltage	220-240V~ 50Hz	
Rated Wattage	11.5W Max.	
Protection Class	Class I	
IP Rating	IP44	
LED Specs	600 lumens 3000K – 2000K (sunset dimming colour)	700 lumens 3000K – 2000K (sunset dimming colour)
Highly Recommended Dimmers	Lucci Power SKU# 290989, 290992, 290993, 290994. MFL Artisan SKU# 197015, 197016, 197017, 197018. Lucci Connect SKU# 299043	
Compatible Dimmers	Buster + Punch DIM-002. DIGINET LED Smart MEDM. Clipsal 31E2PUDM, 31E2RUDM, 32E450UDM, 41E300PBUD2SM-VW, 42E350RLD2MVW. HPM CAT. 400L, Cat. 400T. Lumex LT1D450LS	
Weight	1.3kg	
Dimensions	H:409mm Dia:85mm Suspension:1500mm	