

## ARTISAN G9 SURFACE LIGHT

SKU# 197027

Rated Voltage 220-240V~ 50Hz

To ensure correct function and safety, please read and follow all instructions carefully before assembly, installation and use of this luminaire. Please keep instructions for future reference.

### Warranty

- This luminaire is covered by a 12-month warranty. The warranty is from date of purchase, not the date of installation.
- If the luminaire is not assembled and installed by a licensed electrician, the warranty will be void.
- Please retain the proof of purchase and evidence of installation by a licensed electrician for any warranty enquiries.
- Warranty will be void if there is any damage due to improper usage or modification to the luminaire
- Failure to comply with the instructions in this manual may increase the risk of damage or injury and will void the warranty.

### Installation Requirements

- This luminaire must be assembled and installed by a licensed electrician.
- All wiring and installation of the luminaire must adhere to the latest local and national wiring rules.  
e.g. AS/NZS 3000 Electrical Installations.
- This luminaire is a Class I product and must be earthed during wiring and installation.
- This luminaire is rated IP44 and must be maintained during wiring and installation.

**NOTE: The front of the luminaire is rated IP44, only after it is fully installed with a compatible Artisan shade (sold separately).**

**NOTE: The back of the luminaire (recessed parts) is rated IP20.**

- Select a suitable location for installation:
  - This luminaire is suitable for indoor use only.
  - This luminaire is only suitable to be installed onto the wall. Do not install onto the ceiling.
  - This luminaire is rated against water penetration to IP44 standards, which is water splashing from any direction.
  - The mounting point must support 2 times the weight of the luminaire and a compatible Artisan shade (sold separately).
- The luminaire must not be used if the compatible Artisan shade (sold separately) has been cracked or damaged.
- Take care not to pull any electrical wires during unpacking as this may damage the connection.
- Lay out all the components on a smooth surface and make sure there are no components missing before assembling. If parts are missing, return the complete product to the place of purchase for inspection or replacement.
- Check whether the luminaire has been damaged during transport. Do not operate/install any product which appears damaged in any way. Return the complete product to the place of purchase for inspection, repair or replacement.
- Ensure power to the circuit you are working on has been switched OFF before commencing any electrical work.

## Installation Directions

**WARNING: Ensure power to the circuit you are working on has been switched OFF before commencing any electrical work.**

1. Remove all packaging material from the product and be careful not to throw away accessories that may be hidden within the packaging material.
2. Cut an installation hole of Ø30mm into the wall.
3. Use the luminaire as a template to mark the screw hole positions onto the wall.
4. Drill the mounting holes onto the wall and install any anchors if required. Ensure the anchors used are suitable for the mounting surface and the surrounding environment. Pull the mains supply wire out from the wall.
5. Connect the mains supply wires together with the luminaire wires.

### Mains Supply Wire

Earth – Yellow/Green  
Neutral – Blue or Black  
Live – Brown or Red

### Luminaire Wires

Yellow/Green or   
Blue or N  
Brown or L

**NOTE: Check and ensure the water-proof gasket is in place between the luminaire and the wall.**

**NOTE: This luminaire is a Class I product and must be earthed during wiring and installation.**

**NOTE: This luminaire is rated IP44 and must be maintained during wiring and installation.**

**NOTE: The front of the luminaire is rated IP44, only after it is fully installed with a compatible Artisan shade (sold separately). The back of the luminaire (recessed parts) is rated IP20**

6. Install the luminaire onto the wall. Ensure the screws used are suitable for the mounting surface and the surrounding environment.

## **INSTALLING DECORATIVE PLATE AND SHADE (both sold separately) - Figure 7a, 8a, 9a, 10a.**

- 7a. Install the compatible Artisan decorative plate (sold separately) onto the luminaire and secure by tightening the decorative lock ring. Compatible Artisan Plates listed below:

- Single Round plates: SKU# 197002, 197004, 197006, 197008, 197038.
- Single Oval plates: SKU# 197003, 197005, 197007, 197009.
- Double Oval plates: SKU# 197023, 197024, 197025, 197026.
- Single Dish plates: SKU# 197056, 197057.

- 8a. Install a LED globe (not included) into the lamp holder. Do not exceed the maximum rated wattage.

- 9a. Install the compatible Artisan shade (sold separately) onto the luminaire.

**NOTE: Ensure to add 1 piece of the water-proof gasket in place between the luminaire and the shade.**

Compatible Artisan shades with this installation method: SKU# 197010, 197011, 197054.

## **INSTALLING SHADE ONLY (sold separately) - Figure 7b, 8b.**

- 7b. Install a LED globe (not included) into the lamp holder. Do not exceed the maximum rated wattage.

- 8b. Install the compatible Artisan shade (sold separately) onto the luminaire.

**NOTE: Ensure to add 2 pieces of the water-proof gasket in place between the luminaire and the shade.**

Compatible Artisan shades with this installation method: SKU# 197053, 197059.

After the installation, switch on the luminaire to test all the lighting functions and enjoy your new lighting product.

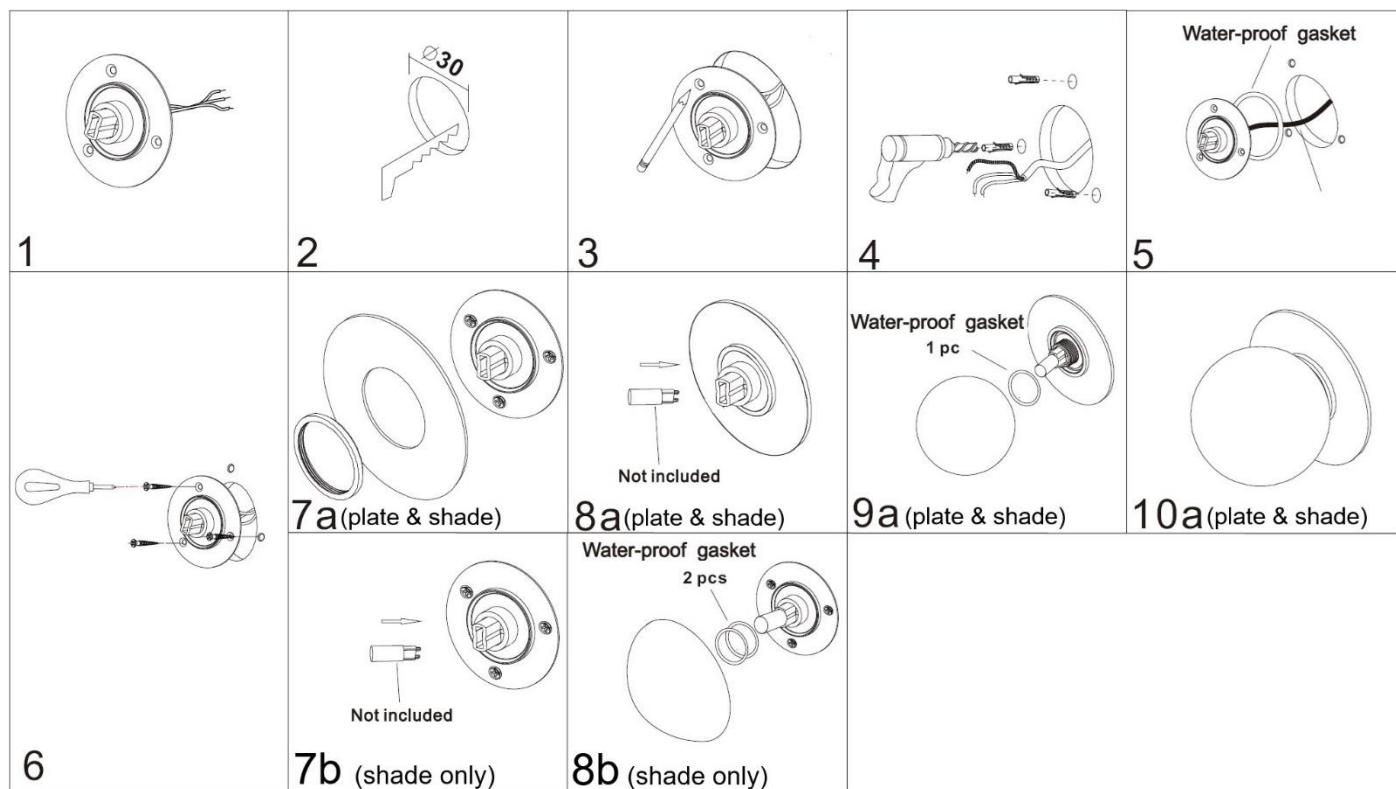

## Safety Tips

- Always ensure the power is OFF and the luminaire has cooled down before performing any maintenance, cleaning, changing the globe or making any adjustment to the luminaire.
- To avoid injury or damage to the luminaire, ensure that power leads and screws are secure before connecting power.
- To clean, wipe with a soft damp cloth. Do NOT soak or immerse the luminaire in water or other liquids.
- Ensure that the luminaire does not come in contact with corrosive chemicals/solvents or abrasive cleaners etc.

## Specifications

SKU #	197027
Rated Voltage	220-240V~ 50Hz
Rated Wattage	5W Max.
Lamp Holder	G9
Weight	0.07kg
Cut-out Size	Ø30mm
IP Rating	IP44 for the front of the luminaire (after installation with compatible Artisan shade – sold separately) IP20 for the back of the luminaire (recessed parts)
Dimensions	H:32mm Dia:84mm (not including plate or shade – both sold separately)
Compatible Decorative Plate (Sold Separately)	Round plate: SKU# 197002, 197004, 197006, 197008, 197038. Oval plate: SKU# 197003, 197005, 197007, 197009, 197023, 197024, 197025, 197026. Dish plate: SKU# 197056, 197057. Shades that are compatible with Decorative Plate Installation: SKU# 197010, 197011, 197054.
Compatible Shade (Sold Separately)	SKU#: 197010 (0.22kg), 197011 (0.53kg), 197053 (0.46kg), 197054 (0.12kg), 197059 (0.99kg).