

## ARTISAN PEBBLE SHADE

SKU# 197045, 197046

Shade only, luminaire is sold separately

To ensure correct function and safety, please read and follow all instructions carefully before assembly, installation and use. Please keep instructions for future reference.

### Warranty

- This product is covered by a 12-month warranty valid for in-store replacement or refund only.
- The warranty period starts from the date of purchase. Please retain the proof of purchase.
- Warranty will be void if there is any damage due to improper usage or modification to the product.
- Failure to comply with instructions in this manual may increase the risk of damage or injury and will void the warranty.

### Installation Requirements

- This installation instruction is for the shade only, if unsure please contact a licensed electrician.
- The luminaire (sold separately) must be installed by a licensed electrician.
- The compatible luminaire (sold separately) is rated IP44 only after a compatible Artisan shade and washer have been fully installed.
- The luminaire (sold separately) must not be used if the lamp shade has been damaged or cracked. Replace the lamp shade before using the luminaire (sold separately).
- Lay out all the components on a smooth surface and make sure there are no components missing before assembling. If parts are missing, return the complete product to the place of purchase for inspection or replacement.
- Check whether the shade has been damaged during transport. Do not operate/install any product which appears damaged in any way. Return the complete product to the place of purchase for inspection, repair or replacement.
- Ensure power to the circuit you are working on has been switched OFF.

### Luminaire Compatibility

This shade is compatible with the following luminaire (sold separately):

MFL Artisan recessed wall light – SKU# 197000, 197001.

MFL Artisan dot – SKU# 197019, 197020, 197021, 197022.

MFL Artisan wall bracket – SKU# 197028, 197029, 197030, 197034, 197035, 197040, 197041, 197042.

MFL Artisan pendant – SKU# 197031, 197032, 197033, 197036, 197037.

MFL Artisan G9 surface light – SKU# 197027

## Installation Directions for:

MFL Artisan recessed wall light – SKU# 197000, 197001 (sold separately)

### **ATTENTION: Switch OFF the mains power before installation.**

1. Remove all packaging material from the product and be careful not to throw away accessories that may be hidden within the packaging material.
2. Install the shade & washer onto the luminaire. Take care not to overtighten, as it may crack or damage the shade.

**NOTE: Ensure the washer forms a tight seal around the rim of the shade and luminaire to maintain the IP rating.**

3. After the installation, switch on the luminaire to test all the lighting functions and enjoy your new lighting product.

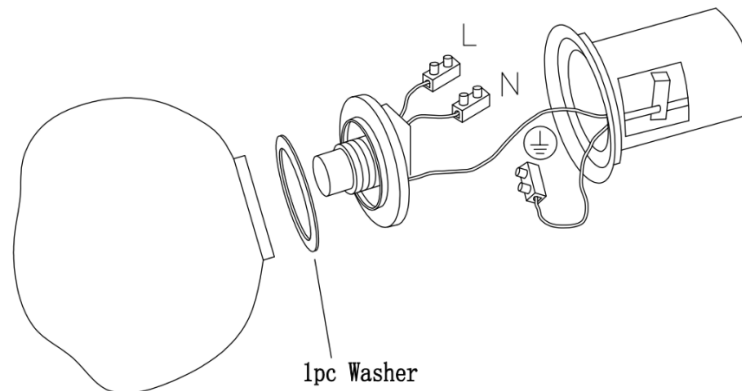

## Installation Directions for:

MFL Artisan dot – SKU# 197019, 197020, 197021, 197022. (sold separately)

MFL Artisan wall bracket – SKU# 197028, 197029, 197030, 197034, 197035, 197040, 197041, 197042. (sold separately)

MFL Artisan pendant – SKU# 197031, 197032, 197033, 197036, 197037. (sold separately)

### **ATTENTION: Switch OFF the mains power before installation.**

1. Remove all packaging material from the product and be careful not to throw away accessories that may be hidden within the packaging material.
2. Install the shade & washer onto the luminaire. Take care not to overtighten, as it may crack or damage the shade.

**NOTE: Ensure the washer forms a tight seal around the rim of the shade and luminaire to maintain the IP rating.**

3. After the installation, switch on the luminaire to test all the lighting functions and enjoy your new lighting product.

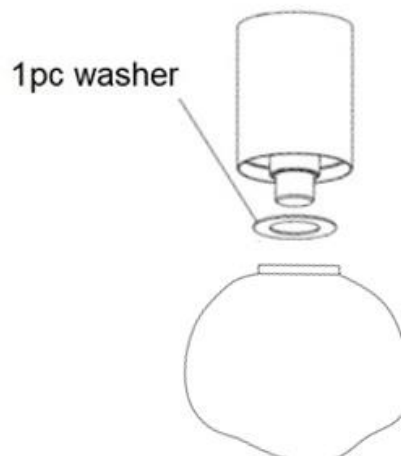

## Installation Directions for:

MFL Artisan G9 surface light – SKU#197027 (sold separately)

**ATTENTION: Switch OFF the mains power before installation.**

1. Remove all packaging material from the product and be careful not to throw away accessories that may be hidden within the packaging material.

2. Install the shade & washer onto the luminaire. Take care not to overtighten, as it may crack or damage the shade.

**NOTE: Ensure the washer forms a tight seal around the rim of the shade and luminaire to maintain the IP rating.**

3. After the installation, switch on the luminaire to test all the lighting functions and enjoy your new lighting product.

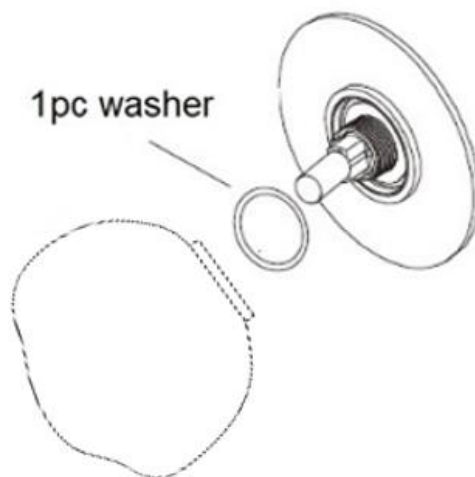

## Safety Tips

- Always ensure the power is OFF and the luminaire has cooled down before performing any maintenance, cleaning or making any adjustment to the luminaire.
- The luminaire (sold separately) must not be used if the lamp shade has been cracked or damaged. Replace the lamp shade before using the luminaire (sold separately).
- To avoid injury or damage to the luminaire, ensure that power leads and screws are secure before connecting power.
- Handle the luminaire and shade with care to avoid any damage or breakage.
- Select a suitable location away from liquids and hazards.
- To clean, wipe with a soft damp cloth. Do NOT soak or immerse the product in water or other liquids.
- Ensure that the fitting does not come in contact with corrosive chemicals/solvents or abrasive cleaners etc.

## Specifications

SKU #	197045	197046
Colour	Milk Glass	Gloss Opal Glass
Luminaire Compatibility	MFL Artisan recessed wall light – SKU# 197000, 197001. MFL Artisan dot – SKU# 197019, 197020, 197021, 197022. MFL Artisan wall bracket – SKU# 197028, 197029, 197030, 197034, 197035, 197040, 197041, 197042. MFL Artisan pendant – SKU# 197031, 197032, 197033, 197036, 197037. MFL Artisan G9 surface light – SKU#197027	
Weight	0.36kg	
Dimensions	H:140mm Dia:140mm	