

## BASILICA LIGHT KIT

SKU# 210276, 210277, 210278

Rated Voltage 220-240V~ 50Hz

To ensure correct function and safety, please read and follow all instructions carefully before assembly, installation and use of the product. Please keep the instructions for future reference.

### Warranty

- This product is covered by a 12 month warranty. Please retain proof of purchase.
- Warranty will be void if there is any damage due to improper usage or modification to the product.
- Failure to comply with the instructions in this manual may increase the risk of damage or injury and will void warranty.

### Installation requirements

- **NOTE: This light kit must only be installed onto the Lucci AIR BASILICA Fan – SKU# 210236, 210237, 210238. It must NOT be used for any other purpose.**
- Must be installed by a licensed electrician.
- All wiring and installation of the light fitting must adhere to local and national wiring rules.  
eg. AS/NZS 3000 Electrical installations in Australia.
- Do not exceed the maximum wattage rating.
- Select a suitable location for installation;
  - This product is suitable for indoor use only.
  - Ensure the fitting is not installed next to any air vents and is not in any moist or damp areas.
- Lay out all the components on a smooth surface and make sure there are no components missing before assembling. If parts are missing, return the complete product to the place of purchase for inspection or replacement.
- Check whether the luminaire has been damaged during transport. Do not operate/install any product which appears damaged in any way. Return the complete product to the place of purchase for inspection, repair or replacement.
- Ensure power to the circuit you are working on has been switched OFF before commencing any electrical work.

# Installation Instructions

## Installation directions

Remove all packaging material from the product and be careful not to throw away accessories that may be hidden within the packaging material.

1. Remove the bottom cover of the fan adaptor by turning anti-clockwise. (Fig. 1)
2. Remove the adaptor from the fan bracket by loosening the screws (Fig.2)

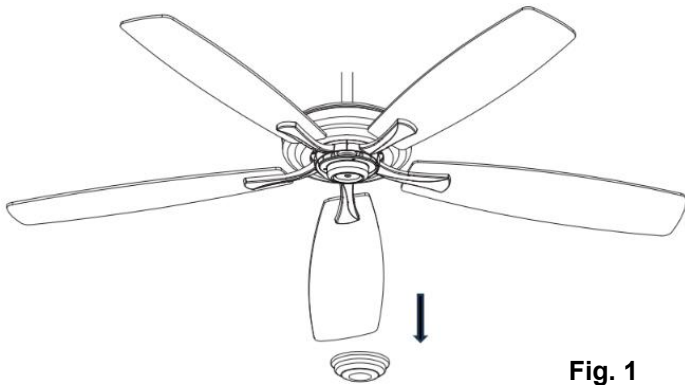

Fig. 1

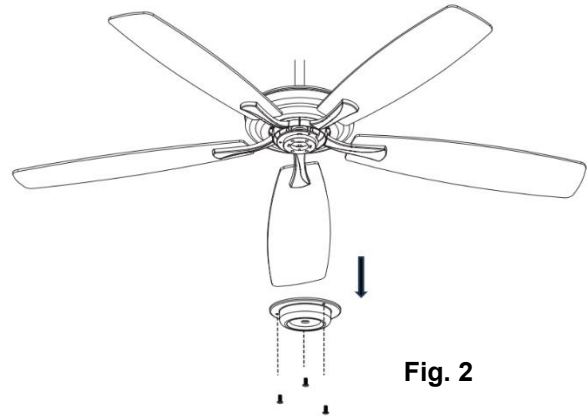

Fig. 2

3. Align the two slot screws with the keyhole slots (2) of the light kit plate. (Fig. 3)
4. Turn the light kit plate counterclockwise until the slot screws are firmly at the end of the slots (2).
5. Secure screw (1) to the light kit plate. Tighten all three screws. Do not over-tighten.

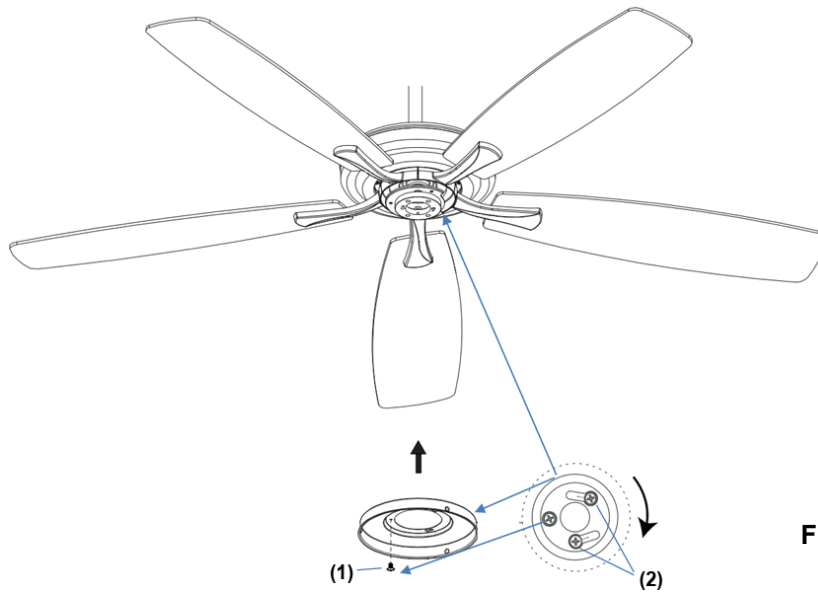

Fig.3

6. Install the GX53 lamp on the fan assembly then secure it by turning clockwise. (Fig. 4)

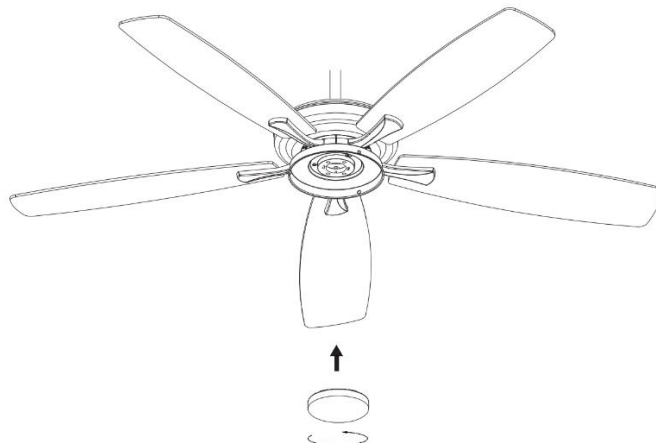

Fig.4

# Installation Instructions

7. Install the glass shade on the light kit plate then secure it by turning clockwise. (Fig. 5)

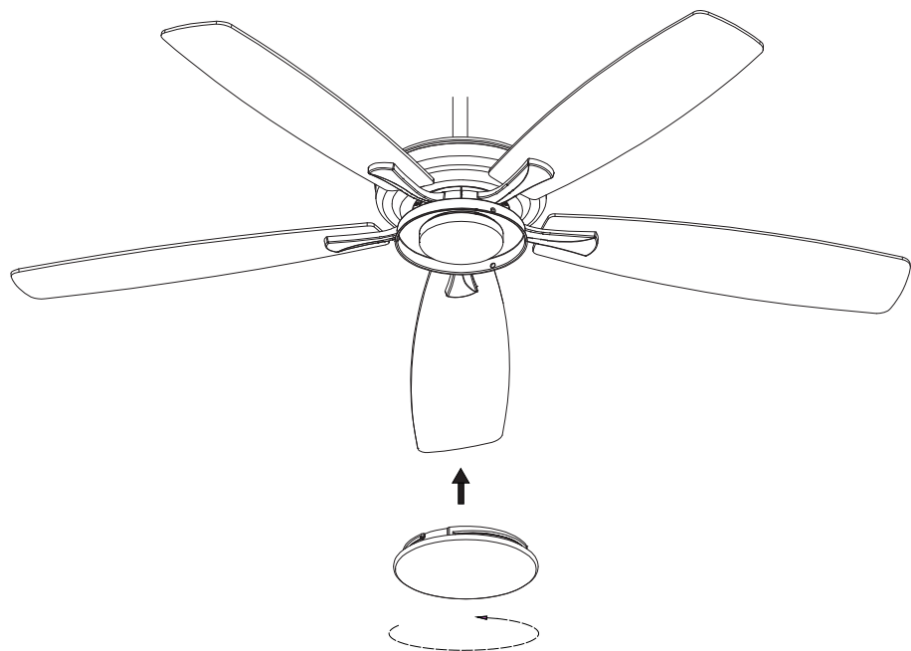

Fig. 5

## Safety tips

- Always ensure the power is OFF and the luminaire has cooled down before performing any maintenance, cleaning, or making any adjustment to the luminaire.
- To avoid injury or damage to the luminaire, ensure that power leads and screws are secure before connecting the power.
- Select a suitable location according to the installation requirements.
- Ensure that the luminaire does not come in contact with corrosive chemicals etc.
- To clean, wipe with a damp clean cloth. Do NOT soak or immerse the product in water or other liquids.

Specifications			
SKU #	210276	210277	210278
Color	White	Brass Finish	Bronze
Rated Voltage	220-240V~ 50Hz		
Rated Wattage	SKU# 121354: GX53,12W, 1100lm, 3000K, 3 step-dim Also compatible with SKU# 121359: GX53,12W, 1100lm, 4000K, 3 step-dim (not included)		
Lamp Holder	GX53		
Weight	0.8kg		
Dimensions	H:58.2mm    Dia:211mm		