

HARBOUR LARGE BOLLARD with VERSION 2 connector

SKU# 220465

Rated Voltage 12V

NOTE: This installation instruction applies to the 12V side of the luminaire only.
This luminaire is rated 12V and is classified as ELV (Extra Low Voltage).
This luminaire can be DIY and does not require any electrical connection or disconnection.
Do not plug this luminaire directly into 240V.
When working with 240V, a licensed electrician is required.
The assistance of a technical person with the correct tools may be required to complete the install.
The Lucci wiring kit (SKU# 220826, 220827) and Lucci transformer (SKU# 220818, 220819, 220829) are sold separately.

Thank you for purchasing this quality Lucci product. To ensure correct function and safety, please read and follow all instructions carefully before assembly, installation and use of this luminaire. Please keep instructions for future reference.

Warranty

- This luminaire is covered by a 5 year warranty. The warranty is from date of purchase, not the date of installation.
- Please retain proof of purchase for any warranty enquiries.
- Warranty will be void if there is any damage due to improper usage or modification to the luminaire.
- Failure to comply with the instructions in this manual may increase the risk of damage or injury and will void warranty.
- Warranty will be void if the cabling is installed underground without suitable protection from water or damp conditions.

Installation Requirements

- All wiring and installation of the luminaire must adhere to the latest local and national wiring rules. eg. AS/NZS 3000 Electrical installations. If unsure, please contact a licensed electrician.
- Do not exceed the maximum wattage rating.
- Replace any cracked protective lamp shade to maintain IP rating when using this luminaire.
- Select a suitable location for installation:
 - This luminaire is protected against water penetration to IP44 standards, which is splashing water in all directions.
 - The wiring kit and connectors are not suitable for underground installation without protection from water or damp conditions. It is not designed to be immersed in water.
 - The installation location may require a gravel substrate to help with water drainage, to prevent the wiring kit and connectors being submerged in water after heavy rain or from watering the garden.
- Take care not to pull any electrical wires during unpacking as this may damage the connection.
- Lay out all the components on a smooth surface and make sure there are no components missing before assembling. If parts are missing, return the complete product to the place of purchase for inspection or replacement.
- Check whether the luminaire has been damaged during transport. Do not operate/install any product which appears damaged in any way. Return the complete product to the place of purchase for inspection, repair or replacement.
- Ensure power to the circuit you are working on has been switched OFF, before commencing any electrical work.

Installation Directions

1. Remove all packaging material from the product and be careful not to throw away accessories that may be hidden within the packaging material.
2. Attach the spike to the bottom of the bollard by twisting it clockwise. (Fig. 1)
3. Loosen the nut at the top and side to remove the shade bracket and glass. (Fig. 2)
4. Install a globe (not included) into the lamp holder. Do not exceed the maximum wattage rating. Do not touch the globe with bare hands, use clean gloves or tissue. Using bare hands may reduce the life of the globe. (Fig. 3).
5. Install the glass, shade bracket, shade, washer and nuts back onto the bollard (Fig. 3).
6. Select a suitable location for installation, see the installation requirements on page 1. (Fig. 4)
Ensure there is adequate space for the luminaire and wiring.

USING LUCCI WIRING KIT AND LUCCI TRANSFORMER (both sold separately)

7. Remove the cover from the connector on the wiring kit (SKU# 220826, 220827 – sold separately).
Connect the luminaire to the wiring kit. **NOTE: The wiring kit is rated for a 80VA load only.** (Fig. 5)
8. Connect the Lucci wiring kit (SKU# 220826, 220827 – sold separately) to the Lucci transformer (SKU# 220818, 220819, 220829 – sold separately). **NOTE: Do not exceed the load of the Lucci wiring kit and Lucci transformer which are rated 80VA, 28VA and 10VA load respectively.** (Fig. 5)

USING OTHER WIRING AND TRANSFORMER (not included)

7. Remove the 12V bi-pin connector from the cable for hard wiring or alternative wiring method and power supply system.
8. Ensure that the wires are secure and no bare wires are exposed. Ensure all wiring and the transformer used are appropriately rated and suitable for the location used. If unsure please contact a licensed electrician.
9. Turn ON the power to the luminaire. (Fig. 6)

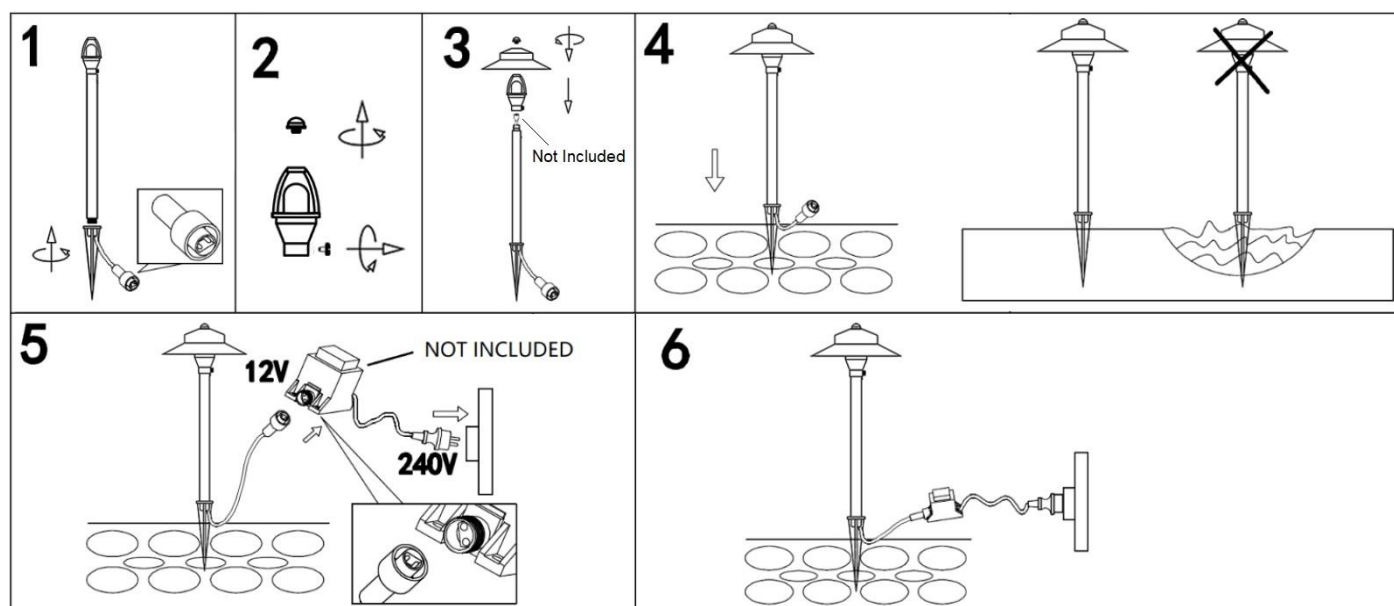

Safety Tips

- Always ensure the power is OFF and the luminaire has cooled down before performing any maintenance, cleaning, changing the globe or making any adjustment to the luminaire.
- The external flexible cable or cord of this luminaire cannot be replaced; if the cable or cord is damaged, the luminaire shall be destroyed.
- To avoid injury or damage to the luminaire, ensure that power leads and screws are secure before connecting the power.
- The luminaire must not be used if the protective shield has been cracked. Replace any cracked protective shield before using the luminaire.
- Ensure that the luminaire does not come in contact with corrosive chemicals/solvents or abrasive cleaners etc.
- To clean, wipe with a damp clean cloth. Do NOT soak or immerse the luminaire in water or other liquids.

Specifications

SKU #	220465
Connector Type	Version 2
Rated Voltage	12V
Rated Wattage	20W Max
Lamp Holder	G4
Weight	0.9kg
IP Rating	IP44
Dimensions	H:710mm Dia:215mm