

## LEDlux 3-Way Cable Splitter

SKU# 220850

Rated Voltage 12V

Rated Current 10A

Thank you for purchasing this quality Lucci product. To ensure correct function and safety, please read and follow all instructions carefully before assembly, installation and use of the product. Please keep instructions for future reference.

### Warranty

- This item is covered by a 12 month warranty. Please retain proof of purchase.
- Warranty will be void if there is any damage due to improper usage or modification to this item.

### Installation requirements

- All wiring and installation of the light fitting must adhere to local and national wiring rules. eg. AS/NZS 3000:2007/Amendment 2:2012 Electrical installations.
- Do not exceed the maximum rated voltage and current.
- This product is only to be used with LEDlux LED wiring kits (SKU# 220826 and 220827 – sold separately).
- Select a suitable location for installation;
  - The cable splitter is protected against water penetration to IP44 standards, which is splashing in every direction.
  - The cable splitter is not suitable for underground installation without protection from water or damp conditions. It is not designed to be immersed in water. If unsure please contact a licensed electrician.
- Lay out all the components on a smooth surface and make sure there are no components missing before assembling. If parts are missing, return the complete product to the place of purchase for inspection or replacement.
- Check whether the item has been damaged during transport. Do not operate/install any product which appears damaged in any way. Return the complete product to the place of purchase for inspection, repair or replacement.
- Ensure power to the circuit you are working on has been switched OFF.

### Installation directions

1. Remove all packaging material from the product.  
Remove the covers from both ends of the cable splitter.
2. Connect the transformer to the input end of the cable splitter. Take note of the 10A rated current of the cable splitter.
3. Connect either LEDlux LED wiring kits (SKU# 220826 & 220827 – sold separately) or LEDlux fittings (sold separately) to the output end of the cable splitter. Take note of the 10A rated current of the cable splitter. Each connection can take approximately 3A load.
4. Ensure all connections have been done up tightly.
5. Select a suitable location for installation and ensure that there is adequate space for the cable splitter and wiring. The cable splitter is rated IP44 which is splashing in every direction and not designed to be immersed in water. There must be adequate drainage to ensure water does not “pool” around the cable splitter. If unsure please contact a licensed electrician.

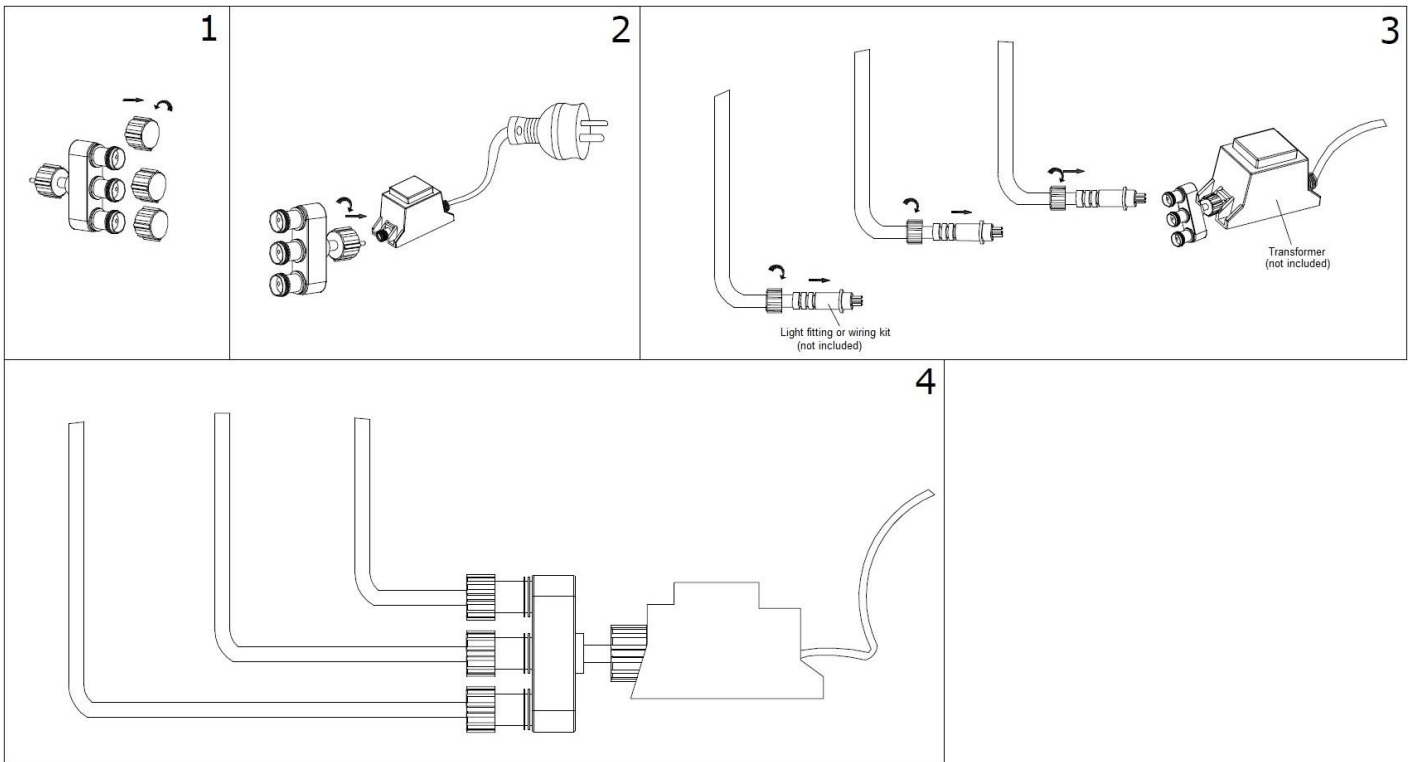

## Safety tips

- Always ensure the power is OFF and has cooled down before performing any maintenance, cleaning or adjustment.
- To avoid injury or damage to the item, ensure that power leads and screws are secure before connecting the power.
- Ensure that the item does not come in contact with corrosive chemicals, etc.
- To clean, wipe with a damp clean cloth. Never soak the item with water.

## Specifications

SKU #	220850
Rated Voltage	12V
Rated Current	10A
IP Rating	IP44
Dimensions	L:55mm W:15mm H:52mm