

Seaford

SKU# 229035, 229036

Rated Voltage 220-240V~ 50Hz

Thank you for purchasing this quality Lucci product. To ensure correct function and safety, please read and follow all instructions carefully before assembly, installation and use. Please keep the instructions for future reference.

Warranty

- This light fitting is covered by a 5 year warranty; please retain proof of purchase and evidence of installation by a licensed electrician.
- If the fitting is not installed by a licensed electrician the warranty will be void.
- Warranty will be void if there is any damage due to improper usage or modification to the fitting.
- Failure to comply with the instructions in this manual may increase the risk of damage or injury and will void warranty.

Installation requirements

- Must be installed by a licensed electrician.
- All wiring and installation of the light fitting must adhere to local and national wiring rules.
eg. AS/NZS 3000:2007/Amendment 2:2012 Electrical installations.
- Do not exceed the maximum wattage rating.
- This fitting is rated IP54. This must be maintained during installation
- Select a suitable location for installation;
 - The mounting point must support 2 times the weight of the fitting.
 - This fitting is protected against water penetration to IP54 standards, which is splashing water in every direction.
- Take care not to pull any electrical wires during unpacking as this may damage the connection.
- Lay out all the components on a smooth surface and make sure there are no components missing before assembling. If parts are missing, return the complete product to the place of purchase for inspection or replacement.
- Check whether the fitting has been damaged during transport. Do not operate/install any product which appears damaged in any way. Return the complete product to the place of purchase for inspection, repair or replacement.
- Ensure power to the circuit you are working on has been switched OFF before commencing any electrical work.

Installation directions

1. Remove all packaging material from the product and be careful not to throw away accessories that may be hidden within the packaging material.
2. Remove the mounting bracket at the bottom of the fitting by loosening the screws with the allen key provided. Remove the top cover from the fitting by twisting it in an anticlockwise direction. Remove the cover plate by loosening the nuts with a spanner (not included).
3. Install a globe (not included) into the lamp holder. Do not exceed the maximum wattage rating. An energy saving globe must be used, such as a CFL or LED globe. Install the cover plate back onto the fitting and ensure the screws are done up tightly to ensure water does not enter the fitting. Install the top cover back onto the fitting.
4. Use the mounting bracket as a template to mark the screw positions onto the ground.
5. Install the mounting bracket onto the ground by using appropriately sized mounting screws and anchors. Ensure the screws and anchors used are suitable for the mounting surface and the surrounding environment.

6. Remove the cover from the terminal block by loosening the 4 screws and connect the mains supply wire.

Mains Supply Wire

- Earth – Yellow/Green
- Neutral – Blue or Black
- Live – Brown or Red

Fitting Wire

- Yellow/Green \oplus
- Blue
- Brown

Ensure the wires are secure and no bare wires are exposed. Install the cover back over the terminal block.

Ensure the terminal block is not sitting at the bottom of the fitting in case any water ‘pools’ around the fitting during the rain. Install the fitting back onto the mounting bracket by tightening the screws with the allen key provided.

7. Check all screws and that the fitting is secure before turning the power back onto the circuit.

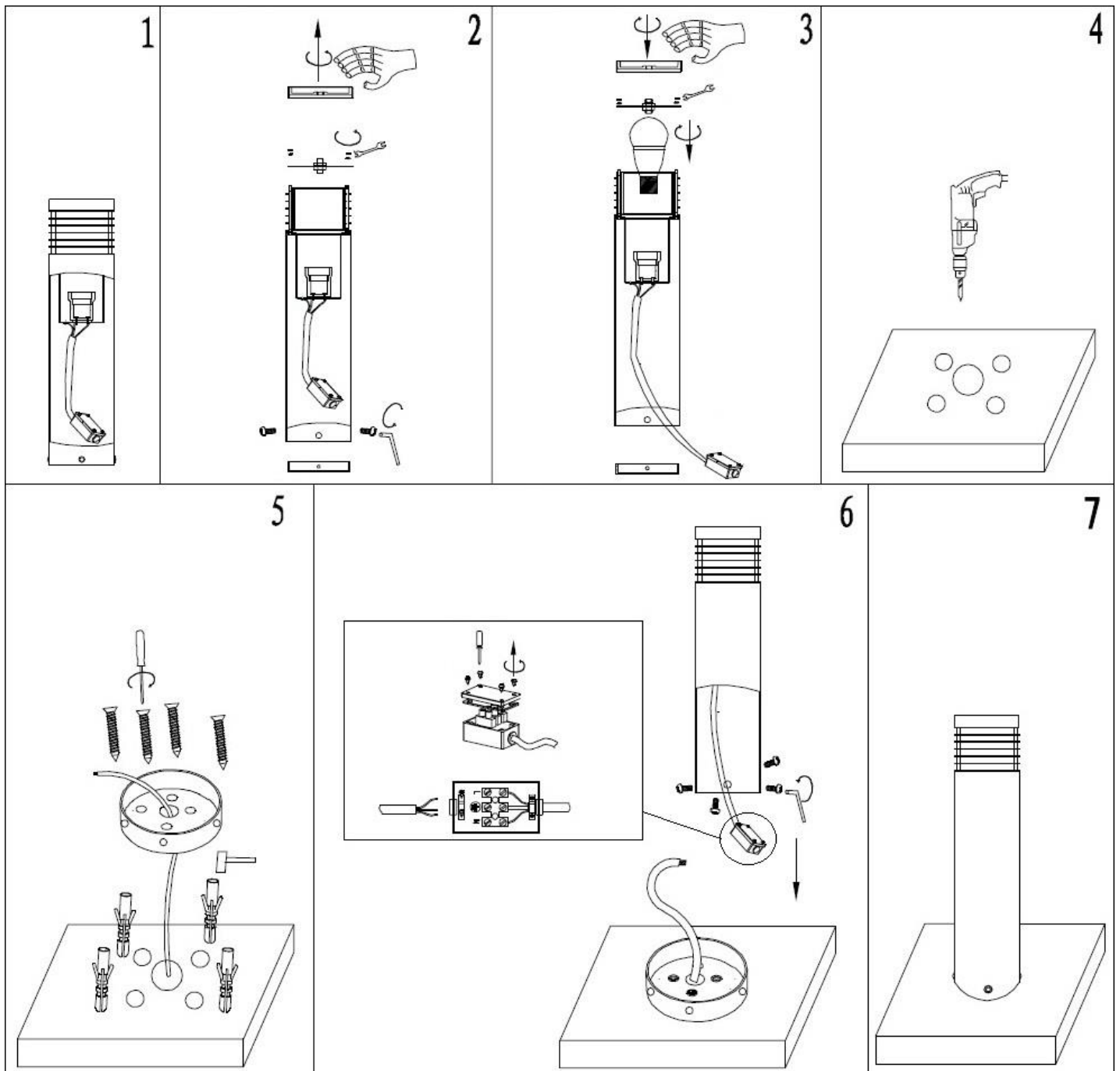

Safety tips

- Always ensure the power is OFF and the fitting has cooled down before performing any maintenance, cleaning, changing the globe or adjustment to the fitting.
- To avoid injury or damage to the fitting, ensure that power leads and screws are secure before connecting the power.
- Select a suitable location away from liquids and hazards.
- Ensure that the fitting does not come in contact with corrosive chemicals, etc.
- To clean, wipe with a damp clean cloth. Never soak the fitting with water.

Specifications

SKU #	229035	229036
Rated Voltage	220-240V~ 50Hz	
Rated Wattage	Max. 20W (Energy saving CFL or LED globe only)	
Lamp Holder	ES / E27	
IP Rating	IP54	
Weight	1.3kg	2.4kg
Dimensions	H:300mm Dia:100mm	H:755mm Dia:100mm