

## **12V LED RIBBON STRIP with VERSION 2 connector**

SKU# 229135, 229136, 229137, 229138, 229139, 229140

Rated Voltage 12V

**NOTE: This installation instruction applies to the 12V side of the luminaire only.**  
**This luminaire is rated 12V and is classified as ELV (Extra Low Voltage).**  
**This luminaire can be DIY and does not require any electrical connection or disconnection.**  
**Do not plug this luminaire directly into 240V.**  
**When working with 240V, a licensed electrician is required.**  
**The assistance of a technical person with the correct tools may be required to complete the install.**  
**The Lucci wiring kit (SKU# 220826, 220827) and Lucci transformer (SKU# 220818, 220819, 220829) are sold separately.**

Thank you for purchasing this quality Lucci product. To ensure correct function and safety, please read and follow all instructions carefully before assembly, installation and use of this product. Please keep instructions for future reference.

### Warranty

- This luminaire is covered by a 3 year warranty. The warranty is from date of purchase, not the date of installation.
- Please retain proof of purchase for any warranty enquiries.
- This luminaire is not suitable for use with dimmer switches.
- Warranty will be void if the luminaire is used on the same circuit which has a dimmer switch.
- Warranty will be void if there is any damage due to improper usage or modification to the luminaire.
- Failure to comply with the instructions in this manual may increase the risk of damage or injury and will void warranty.

### Installation Requirements

- All wiring and installation of the luminaire must adhere to the latest local and national wiring rules. eg. AS/NZS 3000 Electrical installations. If unsure, please contact a licensed electrician.
- Select a suitable location for installation:
  - This luminaire is protected against water penetration to IP67 standards, which is immersion in water for 30mins only. The luminaire is not designed to be immersed in water for longer periods. This must be maintained during wiring and installation
  - The wiring kit and connectors are not suitable for underground installation without protection from water or damp conditions. Ensure they are positioned in a location where the water can be easily drained away. They are not designed to be immersed in water.
  - The installation location may require a gravel substrate to help with water drainage, to prevent the wiring kit and connectors being submerged in water after heavy rain or from watering the garden.
  - The mounting point must support 2 times the weight of the luminaire.
- Take care not to pull any electrical wires during unpacking as this may damage the connection.
- Lay out all the components on a smooth surface and make sure there are no components missing before assembling. If parts are missing, return the complete product to the place of purchase for inspection or replacement.
- Check whether the luminaire has been damaged during transport. Do not operate/install any product which appear damaged in any way. Return the complete product to the place of purchase for inspection, repair or replacement.
- Ensure power to the circuit you are working on has been switched OFF, before commencing any electrical work.

## Installation Directions

1. Remove all packaging material from the product and be careful not to throw away accessories that may be hidden within the packaging material.
2. Measure and determine the length required for your LED ribbon kit.
3. If you require a shorter distance, the ribbon can be cut along the solid lines which are marked with a pair of scissors. (Fig. 1). Do not cut the ribbon in any other positions.  
After the ribbon has been cut, the supplied cap must be placed over the cut ribbon end and covered with a waterproof glue to fix into place, followed by covering it all with a heat shrink wrap. (Fig. 2) This is required to maintain its IP67 rating.
4. Peel the tape from the back of the ribbon or use the supplied mounting brackets and screws to hold the ribbon in position. (Fig. 3)

### **USING LUCCI WIRING KIT AND LUCCI TRANSFORMER (both sold separately)**

5. Remove the cover from the connector on the wiring kit (Fig. 4B - SKU# 220826, 220827 – sold separately). Connect the luminaire (Fig. 4C) to the wiring kit (Fig. 4B). **NOTE: The wiring kit is rated for a 80VA load only.** Ensure the connector is fully tightened.
6. Connect the Lucci wiring kit (Fig. 4B) to the Lucci transformer (Fig. 4A - SKU# 220818, 220819, 220829 – sold separately). **NOTE: Do not exceed the load of the Lucci wiring kit and Lucci transformer which are rated 80VA, 28VA and 10VA load respectively.**  
Insert the transformer plug (not included) into mains power socket outlet (not included) and ensure it is fully plugged in.

Proceed to step 7

### **USING OTHER WIRING AND TRANSFORMER (not included)**

5. Remove the 12V bi-pin connector from the cable for hard wiring or alternative wiring method and power supply system.
6. Ensure that the wires are secure and no bare wires are exposed. Ensure all wiring and the transformer used is appropriately rated and suitable for the location used. If unsure please contact a licensed electrician.

Proceed to step 7

7. Switch on the luminaire to test all the lighting functions and enjoy your new luminaire.

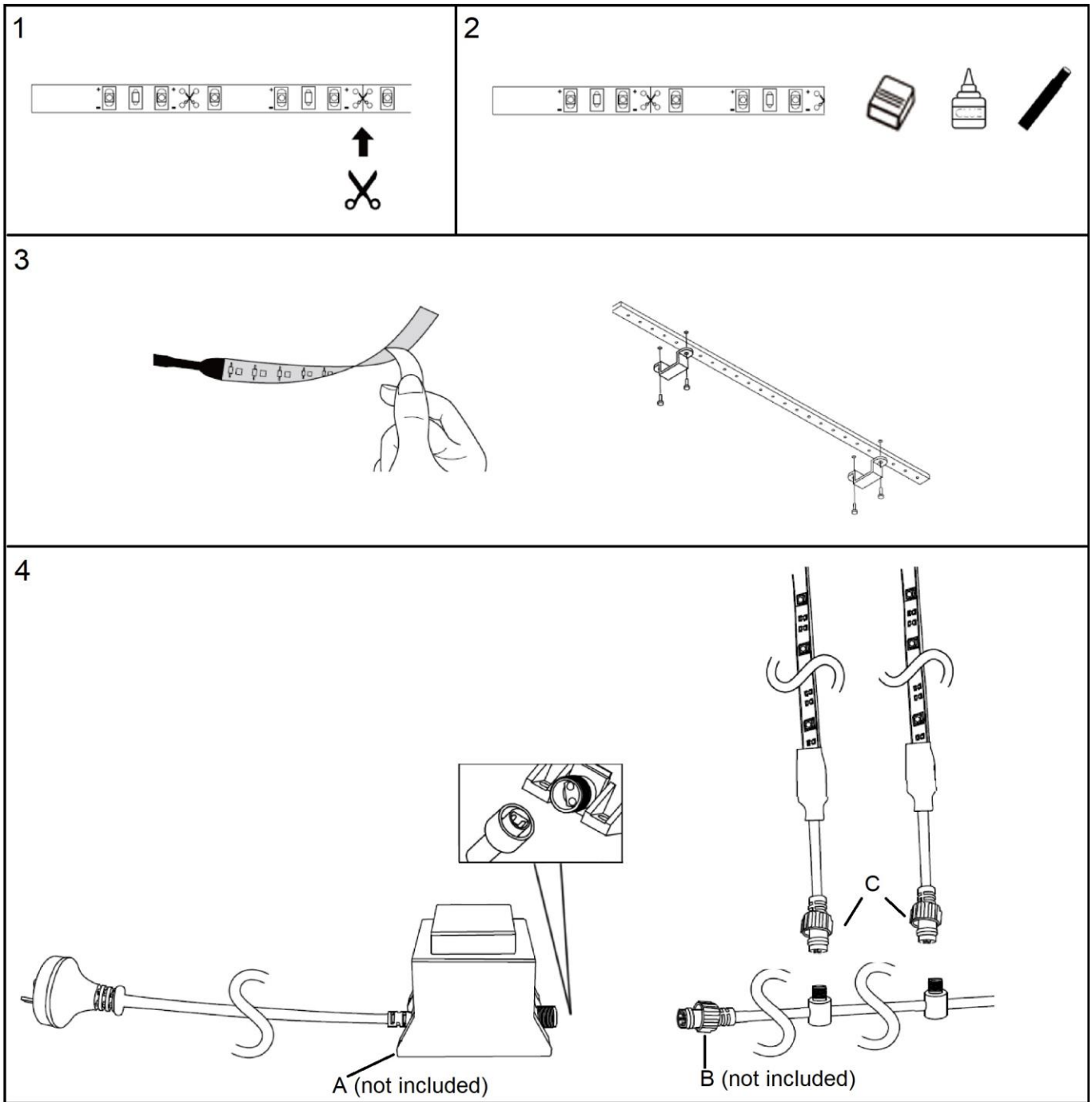

## Safety Tips

- Always ensure the power is OFF and the luminaire has cooled down before performing any maintenance, cleaning or adjustment to the luminaire.
- The external flexible cable or cord of this luminaire cannot be replaced; if the cable or cord is damaged, the luminaire shall be destroyed.
- The luminaire must not be used if the protective shield has been cracked. Replace any cracked protective shield before using the luminaire.
- The light source of this luminaire is not replaceable; when the light source reaches its end of life the luminaire shall be replaced. There are no serviceable parts, do not attempt to dismantle or open the luminaire.
- To avoid injury or damage to the luminaire, ensure that power leads and connectors are secure before connecting the power.
- To clean, wipe with a soft damp cloth. Do NOT soak or immerse the luminaire in water or other liquids.
- Ensure that the luminaire does not come in contact with corrosive chemicals/solvents or abrasive cleaners etc

## Specifications

SKU #	229135	229136	229137	229138	229139	229140
Description	1m kit		3m kit		5m Kit	
Connector Type	Version 2					
Insulation Class	Class III					
IP Rating	IP67					
Rated Voltage	12V					
Rated Wattage	8W		20W		26W	
LED Specs	3000K Warm White 350 lumens	4000K Cool White 450 lumens	3000K Warm White 850 lumens	4000K Cool White 1000 lumens	3000K Warm White 1200 lumens	4000K Cool White 1400 lumens
Weight	0.17kg		0.24kg		0.33kg	
Dimensions	L:1000mm W:12mm D:4mm		L:3000mm W:12mm D:4mm		L:5000mm W:12mm D:4mm	