

WANAKA 1 LIGHT BOLLARD

SKU# 229407

Rated Voltage 220-240V~ 50Hz

To ensure correct function and safety, please read and follow all instructions carefully before assembly, installation and use of this luminaire. Please keep instructions for future reference.

Warranty

- This luminaire is covered by a 5-year warranty. The warranty is from date of purchase, not the date of installation.
- Please retain proof of purchase for any warranty enquiries.
- Warranty will be void if there is any damage due to improper usage or modification to the luminaire.
- Failure to comply with the instructions in this manual may increase the risk of damage or injury and will void warranty.

Installation Requirements

- This luminaire must be assembled and installed by a licensed electrician.
- All wiring and installation of the luminaire must adhere to the latest local and national wiring rules.
eg. AS/NZS 3000 Electrical installations.
- Do not exceed the maximum wattage rating.
- This luminaire is rated IP65. This must be maintained during installation.
- **The connector is rated IP68, and the recommended cable size/type is H05RN-F.**
- This luminaire is a Class II product and must be maintained during wiring and installation.
- Select a suitable location for installation:
 - This luminaire is suitable for outdoor use only.
 - A solid flat mounting surface.
 - This luminaire is protected against water penetration to IP65 standards, which is against low pressure jets of water from all practicable directions. This must be maintained during installation.
 - The installation location may require a gravel substrate to help with water drainage, to prevent the wiring kit and connectors being submerged in water after heavy rain or from watering the garden.
- This luminaire must not be used if the shade has been cracked or damaged. Replace the shade before using the luminaire.
- Take care not to pull any electrical wires during unpacking as this may damage the connection.
- Lay out all the components on a smooth surface and make sure there are no components missing before assembling. If parts are missing, return the complete product to the place of purchase for inspection or replacement.
- Check whether the luminaire has been damaged during transport. Do not operate/install any product which appears damaged in any way. Return the complete product to the place of purchase for inspection, repair or replacement.
- Ensure power to the circuit you are working on has been switched OFF before commencing any electrical work.

Installation Directions

- 1. Remove all packaging material from the product and be careful not to throw away accessories that may be hidden within the packaging material. If assembly is required, place the luminaire on a smooth non-scratch surface.
- 2. Select a suitable location for installation, see the requirements on Page 1. Check the wiring path and mounting surface, if there are any rough or sharp edges please clean up the surface with sand paper to ensure it doesn't cut or damage the wiring.
- 3. Turn off the main supply before installation (Fig.1)
- 4. Remove the shade from the bollard (Fig.2)
- 5. Install the globe (not included) into the lamp holder. Do not exceed the maximum wattage rating .Install the shade back onto the bollard (Fig.3)
- 6. Drill holes into the solid flat mounting surface (Fig.4)
- 7. Depending on the mounting surface, install the appropriate type of anchors into the holes (Fig.5)
- 8. Loosen the waterproof gland nuts on the sides of connector and insert the main supply wires into gland and then to the connector. Connect the main supply wires to the connector terminals and secure the connectors by tightening waterproof gland nuts on the sides. Ensure the wires are secure and no bare wires are exposed . (Fig.6)

Mains Supply Wire	Luminaire Wire / Terminal label
Neutral – Blue or Black	Blue or N
Live – Brown or Red	Brown or L

NOTE: This luminaire is a Class II product and must be maintained during the wiring and installation.

NOTE: The connector is rated IP68, and the recommended cable size/type is H05RN-F.

Note: The strand needs to be strip back to 6mm. Refer figure (a)

NOTE: THE INSTALLING ELECTRICIAN MUST ENSURE THE SUPPLY WIRE MAINTAINS DOUBLE INSULATION AFTER CONNECTING TO THE CONNECTOR TERMINALS

- 9. Insert the wires and connectors inside the bollard .Install the bollard onto the solid flat mounting surface and secure using the screws (Fig.6)

NOTE: This luminaire is rated IP65 this must be maintained during wiring and installation.

- 10.After the installation is complete, turn the power to the circuit ON and test all the lighting functions of the bollard. (Fig. 7)

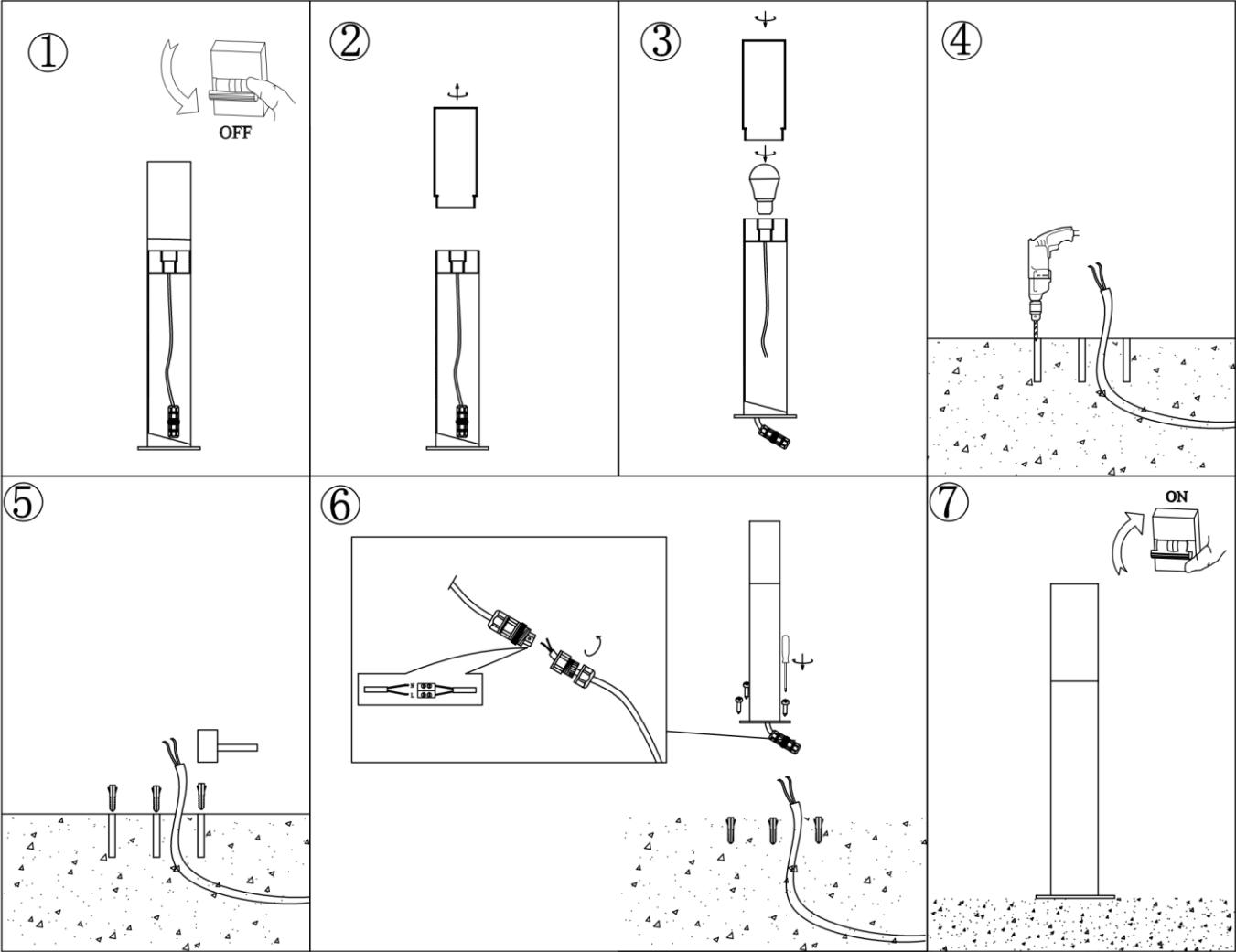

Figure (a)

Safety Tips

- Always ensure the power is OFF and the luminaire has cooled down before performing any maintenance, cleaning, or making any adjustment to the luminaire.
- To avoid injury or damage to the luminaire, ensure that power leads and screws are secure before connecting the power.
- The luminaire must not be used if the shade has been cracked. Replace any cracked shade before using the luminaire.
- Ensure that the luminaire does not come in contact with corrosive chemicals/solvents or abrasive cleaners etc.
- To clean, wipe with a damp clean cloth. Do NOT soak or immerse the luminaire in water or other liquids.

Specifications

SKU #	229407
Rated Voltage	220-240V~ 50Hz
Rated Wattage	15 W Max.
Lamp Holder	ES/ E27
IP Rating	IP65
Weight	1.0 kg
Dimensions	D: 115 mm H: 800mm