

## LED DAY NIGHT SENSOR

SKU# 229421

Rated Voltage 12V AC/DC, 50Hz

**NOTE:** This installation instruction applies to the 12V side of the product only.

**This product is rated 12V and is classified as ELV (Extra Low Voltage).**

**This product can be DIY and does not require any electrical connection or disconnection.**

**Do not plug this product directly into 240V.**

**When working with 240V, a licensed electrician is required.**

**The assistance of a technical person with the correct tools may be required to complete the install.**

**The Lucci wiring kit (SKU# 220826, 220827 and 220850) and Lucci transformer (SKU# 220818, 220819, 220843, 220844, 220829) are sold separately.**

To ensure correct function and safety, please read and follow all instructions carefully before assembly, installation and use of this product. Please keep instructions for future reference.

### Warranty

- This product is covered by a 12 months warranty valid for in-store replacement or refund only.
- The warranty period starts from the date of purchase. Please retain the proof of purchase for any warranty enquiries.
- Warranty will be void if there is any damage due to improper usage or modification to the product.
- Failure to comply with the instructions in this manual may increase the risk of damage or injury and will void the warranty.

### Installation Requirements

- All wiring and installation of the product must adhere to the latest local and national wiring rules. E.g. AS/NZS 3000 Electrical installations. If unsure, please contact a licensed electrician.
- Select a suitable location for installation:
  - This product is protected against water penetration to IP68 standards, which is against low-pressure jets of water from all practicable direction; this must be maintained during installation.
  - The quick connector and wiring kit (sold separately) are not suitable for underground installation without protection from water or damp conditions. Ensure it is positioned in a location where the water can be easily drained away. They are not designed to be immersed in water.
  - The installation location may require a gravel substrate to help with water drainage, to prevent the quick connector and wiring kit (sold separately) being submerged in water after heavy rain or from watering the garden.
  - The mounting point must support 2 times the weight of the product.
- Take care not to pull any electrical wires during unpacking as this may damage the connection.
- Lay out all the components on a smooth surface and make sure no components are missing before assembling. If parts are missing, return the complete product to the place of purchase for inspection or replacement.
- Check whether the product has been damaged during transport. Do not operate/install any product which appears damaged in any way. Return the complete product to the place of purchase for inspection, repair or replacement.
- Do not plug into the mains power socket outlet before or during assembly. Only do so after the product is fully assembled and is ready to use for the first time.

## Installation Directions

1. Ensure power to the circuit you are working on has been switched OFF before commencing any electrical work.
2. Remove all packaging material from the product and be careful not to throw away accessories that may be hidden within the packaging material.
3. Select a suitable location for installation. See the installation requirements above.
4. Use the product as a template to mark the screw positions on the mounting surface (Fig 1).
5. Install the product onto the mounting surface by using appropriately sized mounting screws. Ensure the mounting screws used are suitable for the mounting surface and the surrounding environment (Fig 1).
6. Use the quick connector to connect the product to the Lucci wiring kit (SKU# 220826, 220827 and 220850- sold separately). Ensure the connector fully tightened (Fig 2).

**NOTE: The Lucci wiring kit rated for Max. 80VA/120VA load only.**

7. Connect the Lucci wiring kit (SKU# 220826, 220827 and 220850- sold separately) to the Lucci transformer (SKU# 220818, 220819, 220843, 220844, 220829- sold separately) (Fig 2).

**NOTE: Do not exceed the load of the Lucci wiring kit and Lucci transformer which are rated 80VA, 28VA ,150VA, 200VA and 120VA load, respectively.**

8. Insert the Lucci transformer plug (not included) into mains power socket outlet (not included) and ensure it is fully plugged in. Switch on the product to test all the lighting functions and enjoy your new product (Fig 3).
9. When the installation complete, the day night sensor can be switch on once ambient illuminance reaches 5-10 lux.

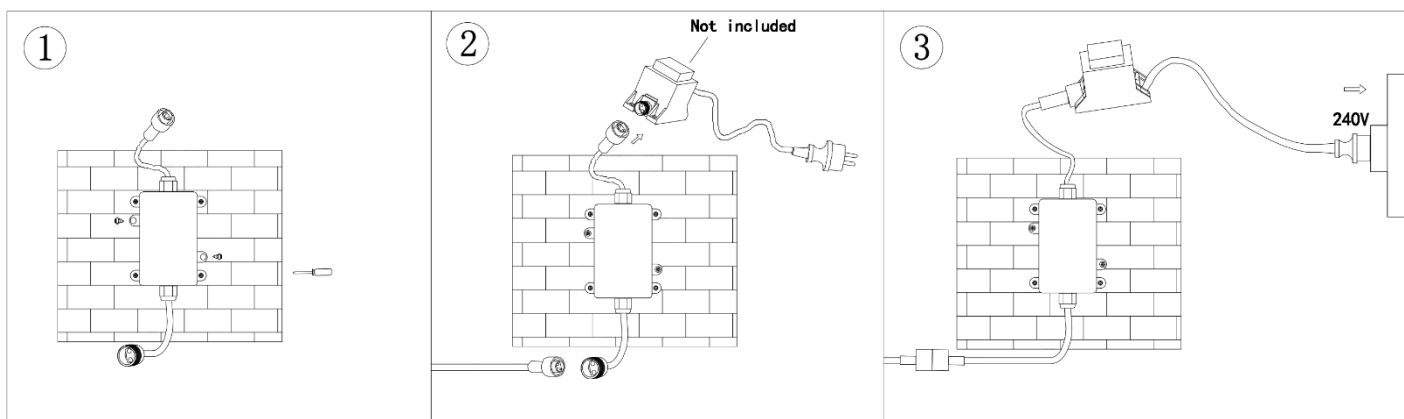

## Safety Tips

- Always ensure the power is OFF and the product has cooled down before performing any maintenance, cleaning, changing the globe or making any adjustment to the product.
- The external flexible cable or cord of this product cannot be replaced; if the cable or cord is damaged, the product shall be destroyed.
- To avoid injury or valid. Damage to the product, ensure that power leads and screws are secure before connecting the power.
- Select a suitable location away from liquids and hazards.
- To clean, wipe with a soft damp cloth. Do NOT soak or immerse the product in water or other liquids.
- Ensure that the product does not come in contact with corrosive chemicals/solvents or abrasive cleaners etc..

Specifications	
SKU #	229421
Rated Voltage	12V AC/DC, 50Hz
Rated Wattage	60W Max
IP Rating	IP68
Weight	0.2 kg
Specifications	Day night sensor can be ON/OFF automatically based on ambient illuminance. Ambient illuminance: 5-10LUX
Dimensions	H:40mm L:620mm W: 53mm