

GALLERY LED CCT ROUND WALL BRACKET

SKU# 231415

Rated Voltage 220-240V~ 50Hz

To ensure correct function and safety, please read and follow all instructions carefully before assembly, installation and use of this luminaire. Please keep instructions for future reference.

Warranty

- This luminaire is covered by a 5-year warranty. The warranty is from date of purchase, not the date of installation.
- If the luminaire is not assembled and installed by a licensed electrician, the warranty will be void.
- Please retain the proof of purchase and evidence of installation by a licensed electrician for any warranty enquiries.
- The luminaire is non-dimmable. The use of dimmers may damage your recessed luminaire and will void your warranty.
- Warranty will be void if there is any damage due to improper usage or modification to the luminaire.
- Failure to comply with the instructions in this manual may increase the risk of damage or injury and will void the warranty.

Installation Requirements

- This luminaire must be assembled and installed by a licensed electrician.
- All wiring and installation of the luminaire must adhere to the latest local and national wiring rules. E.g. AS/NZS 3000 Electrical Installations.
- This luminaire is a Class II product and must be maintained during wiring and installation.
- This luminaire is rated IP65, this must be maintained during wiring and installation
- Select a suitable location for installation:
 - The mounting point must support 2 times the weight of the luminaire.
 - This luminaire is protected against water penetration to IP65 standards, which is against low-pressure jets of water from all practicable directions.
- The luminaire must not be used if the protective shield has cracked. Replace any cracked protective shield before using the luminaire.
- This luminaire is not suitable for dimming and should not be used with a circuit which has a dimmer. Warranty will be void if the luminaire is used on the same circuit which has a dimmer switch.
- The light source contained in this luminaire shall only be replaced by the manufacturer or his service agent or a similar qualified person.
- Take care not to pull any electrical wires during unpacking as this may damage the connection.
- Lay out all the components on a smooth surface and make sure no components are missing before assembling. If parts are missing, return the complete product to the place of purchase for inspection or replacement.
- Check whether the luminaire has been damaged during transport. Do not operate/install any product which appears damaged in any way. Return the complete product to the place of purchase for inspection, repair or replacement.
- Ensure power to the circuit you are working on has been switched OFF before commencing any electrical work.

Installation Directions

1. Remove all packaging material from the product and be careful not to throw away accessories that may be hidden within the packaging material.
2. Ensure power to the circuit you are working on has been switched OFF before commencing any electrical work. (Fig.1)
3. Remove the decorative ring from the luminaire. (Fig. 2)
4. Remove the luminaire base from the luminaire body by loosening the screws on the sides. (Fig. 3)
5. Use the luminaire base as a template to mark the screw positions on the wall.
6. Install the luminaire base onto the wall by using appropriately sized mounting screws and anchors. Ensure the screws and anchors used are suitable for the mounting surface and the surrounding environment. (Fig. 4)

NOTE: A non-corrosive bead of silicon MUST be applied before installation onto the wall, ensuring that no water can run down into the cabling.

7. Install the decorative ring back onto the luminaire. (Fig. 4)
8. Use the toggle switch in the luminaire body to select your desired colour temperature. (Fig. 4)
WW – 3000K / NW – 4000K / CW – 5000K
9. Connect the mains supply wire to the terminal block. Ensure the wires are secure and no bare wires are exposed. (Fig. 5)

Mains Supply Wire	Luminaire Wire / Terminal label
Neutral – Blue or Black	Blue or N
Live – Brown or Red	Brown or L

NOTE: This is a Class II luminaire and must be maintained during wiring and installation.

10. Install the luminaire body back onto the luminaire base and secure by tightening the screws on the side. (Fig. 6)
11. Install the Gallery disc (not included, sold separately) onto the luminaire. (Fig. 7)

NOTE: Compatible with Gallery discs (not included, sold separately) as below:

Gallery small discs: SKU# 231416, 231417, 231418

Gallery large discs: SKU# 231419, 231420, 231421

12. After the installation, switch on the luminaire to test all the lighting functions and enjoy your new luminaire.

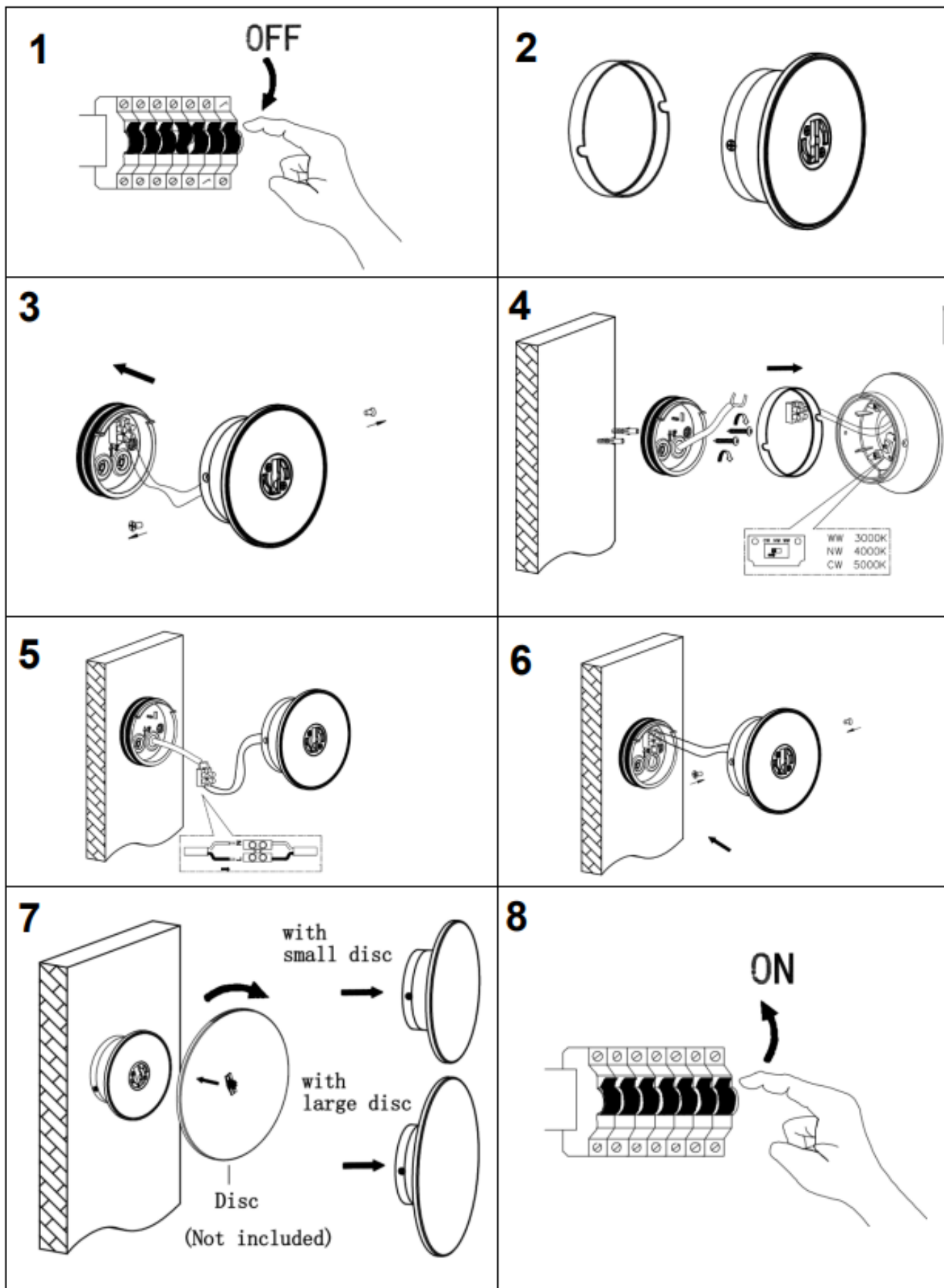

Safety Tips

- Always ensure the power is OFF and the luminaire has cooled down before performing any maintenance, cleaning, changing the globe or making any adjustment to the luminaire.
- To avoid injury or damage to the luminaire, ensure that power leads and screws are secure before connecting the power.
- To clean, wipe with a soft damp cloth. Do NOT soak or immerse the luminaire in water or other liquids.
- Ensure that the luminaire does not come in contact with corrosive chemicals/solvents or abrasive cleaners etc.
- The luminaire must not be used if the protective shield has cracked. Replace any cracked protective shield before using the luminaire again.
- The light source contained in this luminaire shall only be replaced by the manufacturer or his service agent or a similar qualified person.

Specifications

SKU #	231415
Colour	White
Rated Voltage	220-240V~ 50Hz
Rated Wattage	9W
LED Specs	Non-dimmable, Colour Switching*, CRI > 80
Colour Temperature and Lumens	3000K 4000K 5000K 650 lumens
IP Rating	IP65
Weight	0.2kg
Dimensions	Dia:130mm H:50mm

* Use the toggle switch in the luminaire body to select the colour temperature - 3000K or 4000K or 5000K.