

## FLINDERS SQUARE UP/DOWN WALL SCORE

SKU# 238020, 238021, 238022

Rated Voltage 220-240V~ 50Hz

To ensure correct function and safety, please read and follow all instructions carefully before assembly, installation and use of this product. Please keep instructions for future reference.

### Warranty

- This luminaire is covered by a 5 year warranty. The warranty is from date of purchase, not the date of installation.
- If the luminaire is not assembled and installed by a licensed electrician the warranty will be void.
- Please retain proof of purchase and evidence of installation by a licensed electrician.
- Warranty will be void if there is any damage due to improper usage or modification to the luminaire.
- Failure to comply with the instructions in this manual may increase the risk of damage or injury and will void warranty.

### Installation requirements

- This luminaire must be assembled and installed by a licensed electrician.
- All wiring and installation of the luminaire must adhere to the latest local and national wiring rules.  
E.g. AS/NZS 3000 Electrical Installations.
- This luminaire is a Class I product and must be earthed during wiring and installation.
- This luminaire is rated IP65, this must be maintained during wiring and installation.
- This luminaire must be used with GU10 LED lamps only. Do not exceed the maximum wattage rating.
- Select a suitable location for installation:
  - The mounting point must support 2 times the weight of the luminaire.
  - This luminaire is protected against water penetration to IP65 standards, which is against low pressure jets of water from all practicable direction. This must be maintained during installation.
- This luminaire must not be used if the protective shield has been cracked. Replace any cracked protective shield before using the luminaire.
- Take care not to pull any electrical wires during unpacking as this may damage the connection
- Lay out all the components on a smooth surface and make sure there are no components missing before assembling. If parts are missing, return the complete product to the place of purchase for inspection or replacement.
- Check whether the luminaire has been damaged during transport. Do not operate/install any product which appears damaged in any way. Return the complete product to the place of purchase for inspection, repair or replacement.
- Ensure power to the circuit you are working on has been switched OFF before commencing any electrical work.

### Installation directions

1. Ensure power to the circuit you are working on has been switched OFF before commencing any electrical work.
2. Remove all packaging material from the product and be careful not to throw away accessories that may be hidden within the packaging material.
3. Remove the mounting bracket (B) by loosening the screws (D) on the top and bottom of the luminaire (P).
4. Use the mounting bracket (B) as a template to mark the screw hole positions on the wall.
5. Install the mounting bracket (B) onto the wall by using appropriately sized mounting screws (C) and anchors (A). Ensure the screws (C) and anchors (A) used are suitable for the mounting surface and the surrounding environment.
6. Remove the terminal box cover (F) by loosening the screws (E) from the terminal box (H).
7. Loosen the water proof gland nuts (I) on both sides of the sides of the terminal box (H). Insert the main supply wires through the gland nuts (I) and then to terminal box (H)

8. Connect the mains supply wire to the terminal block (G). Ensure the wires are secure and no bare wires are exposed.

**Mains Supply Wire**

Earth – Yellow/Green

Neutral – Blue

Live – Brown

**Luminaire Wire / Terminal Block**

Yellow/Green or 

Blue or N

Brown or L

**NOTE: This luminaire is a Class I product and must be earthed during the wiring and installation.**

**NOTE: It is recommended a non-corrosive bead of silicon MUST be applied before installation onto the wall, ensuring that no water can run down into the cabling.**

9. Install the terminal box cover (F) back by tightening with the screws (E) and secure the terminal box (H) by tightening the water proof gland nuts (I) on both sides.

10. Install the luminaire (P) back onto the mounting bracket (B) and secure by tightening the screws on the top and bottom of the luminaire.

**NOTE: This luminaire is rated IP65, this must be maintained during wiring and installation**

11. Remove the cover (K) by loosening the screws (J) and then the glass cover (L) followed by the washer (M).

12. Install globes (N-not included) into the lamp holders (O). Do not exceed the maximum wattage rating.

**NOTE: This luminaire must be used with GU10 LED lamps only. Do not exceed the maximum wattage rating.**

13. Install the washer (M), followed by the glass cover (L) and the cover (K) back onto the luminaire (P) and secure by tightening with the screws (J).

14. After the installation, switch on the luminaire to test and enjoy your new lighting product.

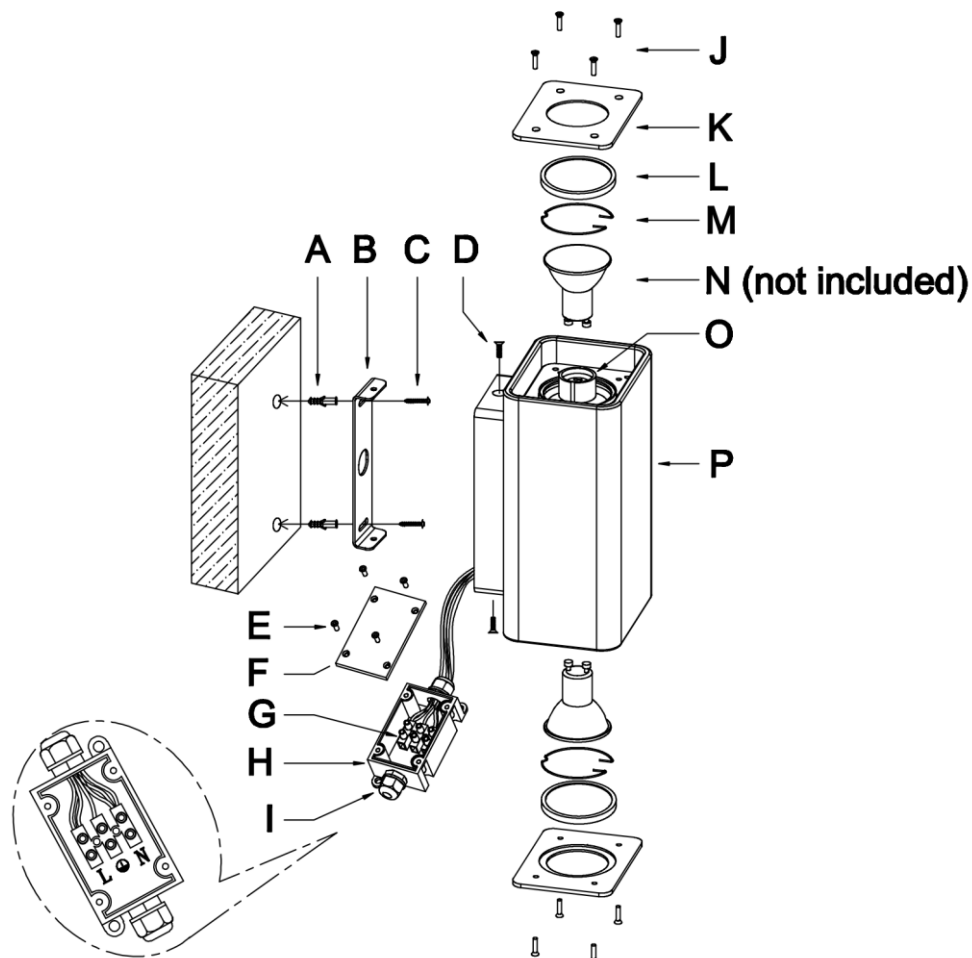

## Safety tips

- Always ensure the power is OFF and the luminaire has cooled down before performing any maintenance, cleaning, changing the globe or making any adjustment to the luminaire.
- To avoid injury or damage to the luminaire, ensure that power leads and screws are secure before connecting the power.
- The luminaire must not be used if the shade has been cracked. Replace any cracked protective shield before using the luminaire.
- Select a suitable location away from liquids and hazards.
- Ensure that the luminaire does not come in contact with corrosive chemicals/solvents or abrasive cleaners etc.
- To clean, wipe with a damp clean cloth. Do NOT soak or immerse the product in water or other liquids.

## Specifications

SKU #	238020	238021	238022
Colour	Green	White	Black
Rated Voltage	220-240V~ 50Hz		
Rated Wattage	20W Max. (Use 2 x Max.10W globes, LED Only)		
Lamp Holder	GU10		
IP Rating	IP65		
Weight	1.6kg		
Dimensions	H:200mm W:115mm E:115mm		