

Nuvo

SKU# 261105, 261106

Rated Voltage 220-240V~ 50Hz

Thank you for purchasing this quality Lucci product. To ensure correct function and safety, please read and follow all instructions carefully before assembly, installation and use. Please keep the instructions for future reference.

Warranty

- This fitting is covered by a 12 month warranty from the date of purchase. Please retain proof of purchase.
- Warranty will be void if there is any damage due to improper usage or modification to the fitting.
- Failure to comply with the instructions in this manual may increase the risk of damage or injury and will void warranty.

Installation requirements

- Select a suitable location for this light fitting;
 - Ensure it is on a flat and stable surface.
 - This product is suitable for indoor use only.
 - Do not place flammable material near or over the fitting.
 - Ensure the fitting is not installed next to any air vents and is not in any moist or damp areas.
- Do not exceed the maximum wattage rating.
- Take care not to pull any electrical wires during unpacking as this may damage the connection.
- Lay out all the components on a smooth surface and make sure there are no components missing before assembling. If parts are missing, return the complete product to the place of purchase for inspection or replacement.
- Check whether the fitting has been damaged during transport. Do not operate/install any product which appears damaged in any way. Return the complete product to the place of purchase for inspection, repair or replacement.
- Do not plug into the mains power socket outlet before or during assembly. Only do so after the portable lamp is fully assembled with the globe installed and is ready to use for the first time.

Installation directions

1. Remove all packaging material from the product and loosen the locking nut (A). (figure 1)
2. Raise and reposition the upper arm (B). (figure 2)
3. Loosen the locking nut (C) and lower the lamp holder (D). (figure 3)
4. Check and ensure the upper arm (B) is positioned over the stopper pin. (figure 4)
5. Remove the lamp holder ring (F) from the lamp holder. (figure 5)
6. Secure the lamp shade (E) onto the lamp holder using the lamp holder ring (F). (figure 5)
7. To adjust the angle of the arms and shade, no tool is required. Loosen the locking nuts at each joint and adjust to the desired angle. Never adjust the arms and shade without first loosening the locking nuts on the fitting. See figure 6 on page 4 for the maximum adjustment angles for the shade and each arm. Do not force or adjust the shade and each arm more than these maximum angles. It may damage the product and the wiring.
NOTE: If the locking nuts are not loosened first and the arms and shade are adjusted, this may damage the locking nuts and the warranty will be void.
NOTE: During normal operation the shade may be hot to touch. Always ensure the power is OFF and the fitting has cooled down before performing any maintenance, cleaning, changing the globe or adjustment to the fitting.
8. After adjusting the lamp, check that the fitting is balanced and does not tip over easily.
9. Install a globe (G - not included) into the lamp holder. Do not exceed the maximum rated wattage.
A fancy round globe is recommended. (figure 5)
10. Insert the plug into the socket outlet and ensure it is fully plugged in. Turn power on at the mains power socket outlet.
11. Use the cord line switch to turn the lamp on/off.

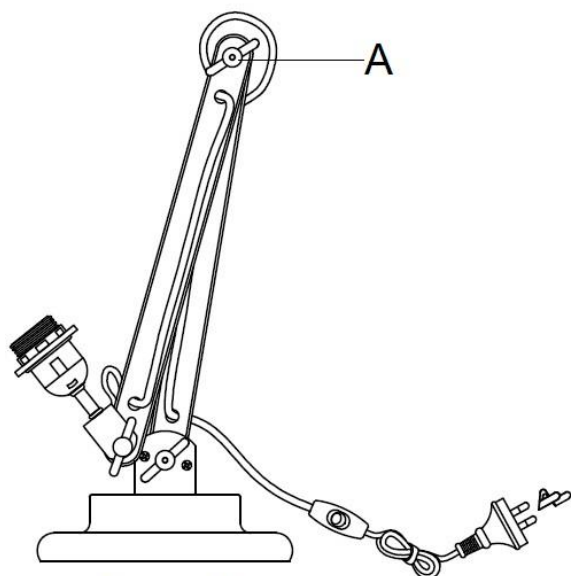

Figure 1

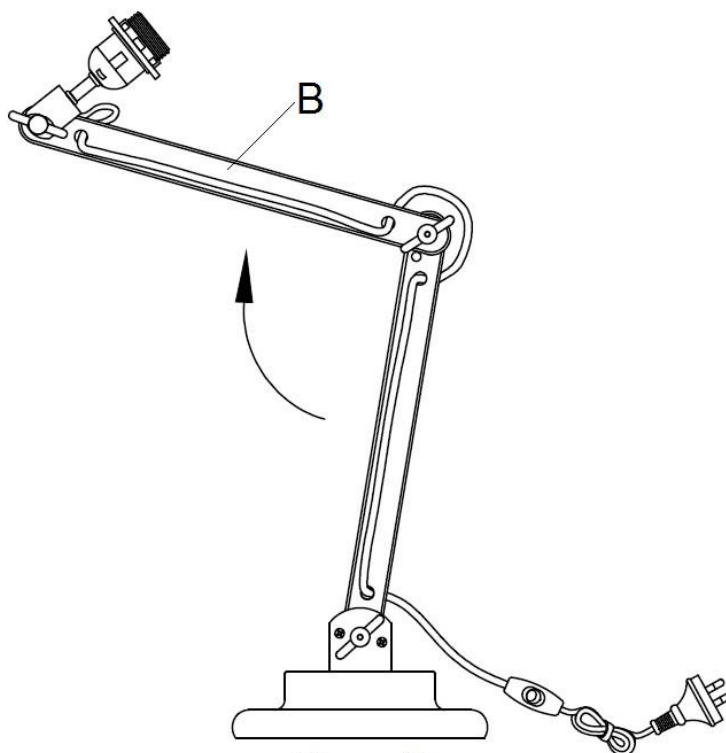

Figure 2

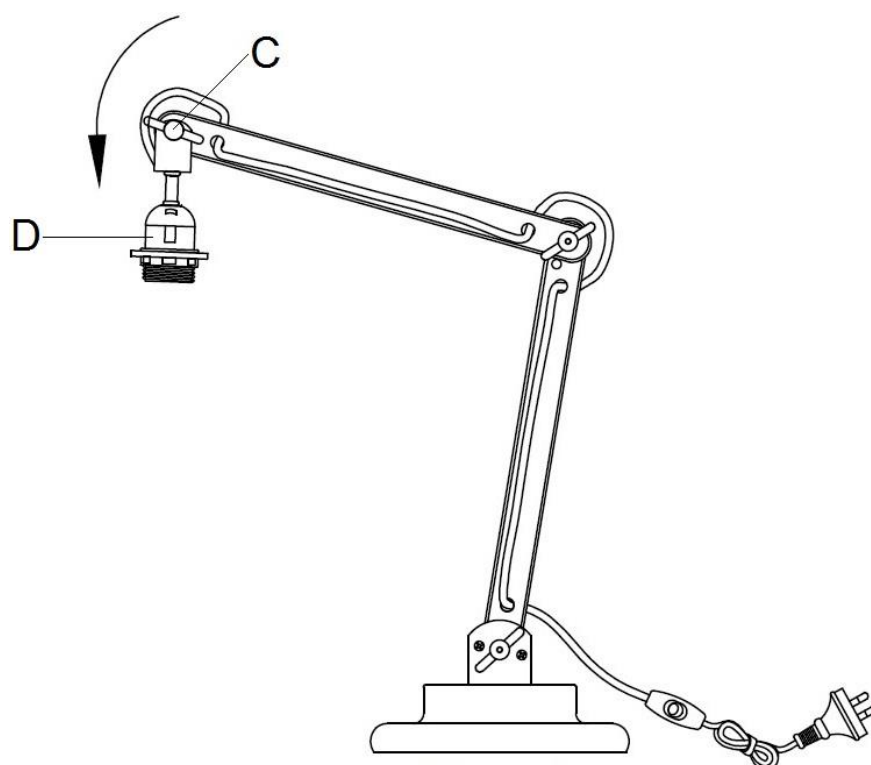

Figure 3

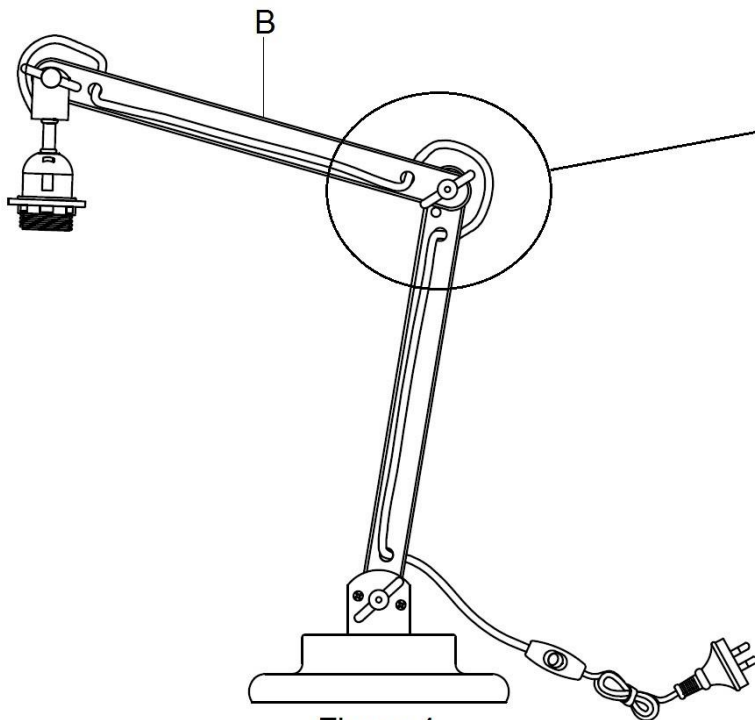

Figure 4

NOTE: THE UPPER ARM (B) POSITION MUST BE ABOVE THE STOPPER PIN AS SHOWN HERE.

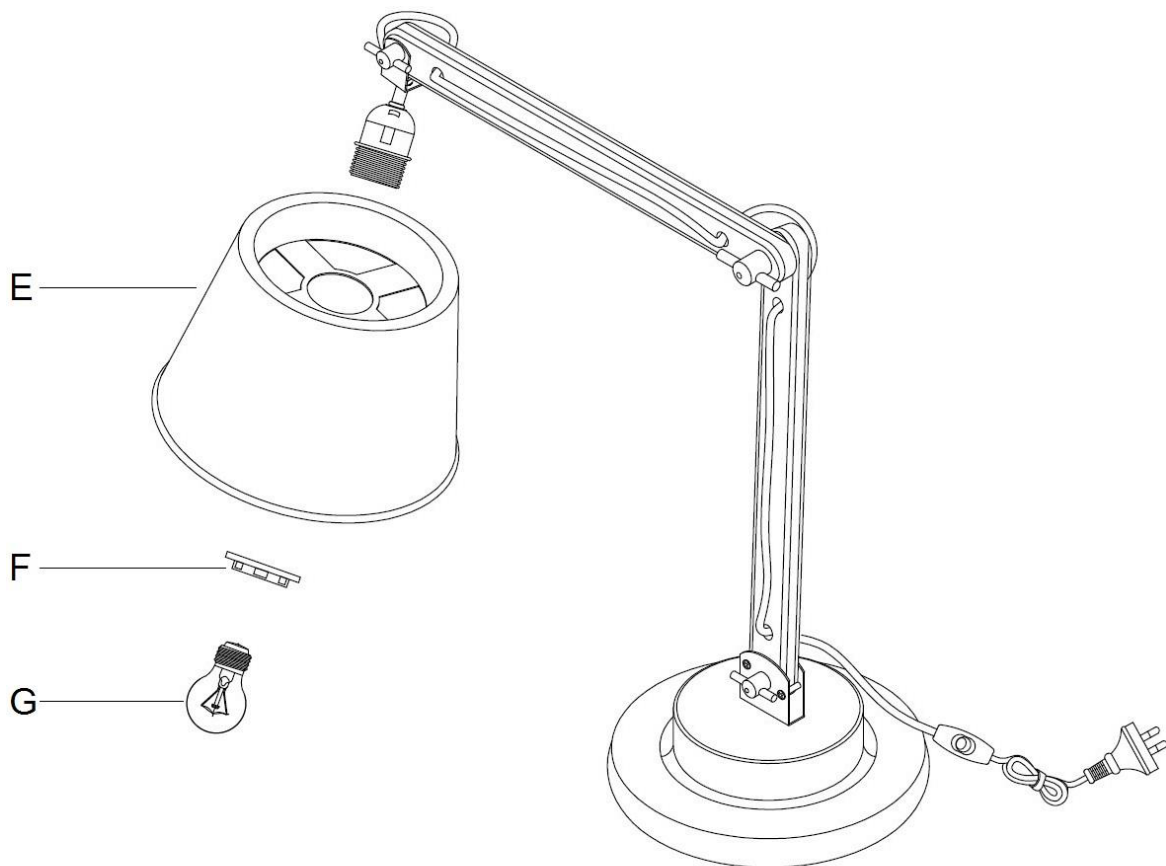

Figure 5

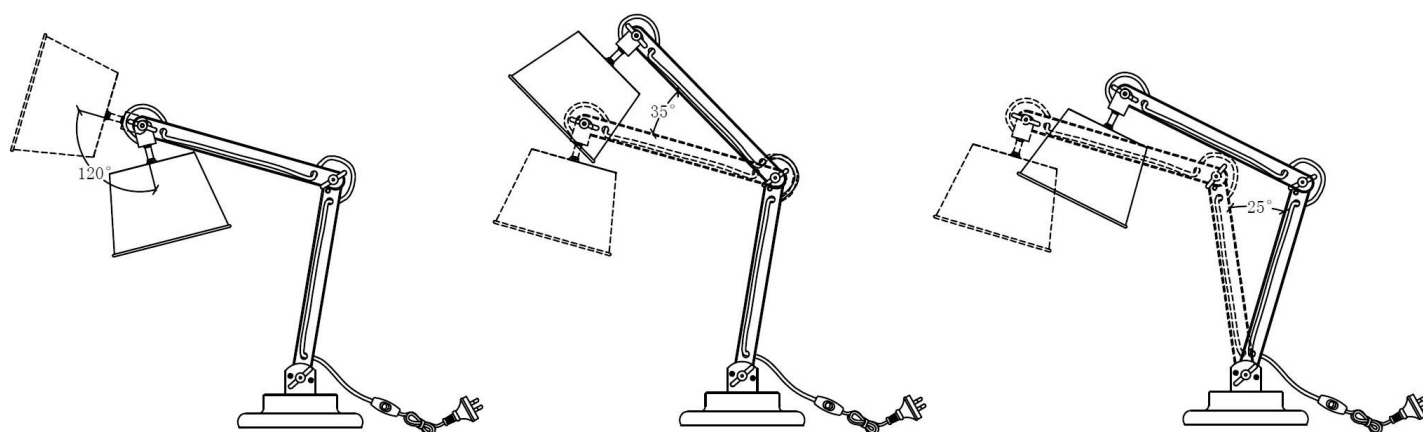

Figure 6

NOTE: Do not force or adjust the arms or shade more than the maximum angles shown above. Doing so may damage the fitting, locking nuts or wiring.

Safety tips

- Always ensure the power is OFF and the fitting has cooled down before performing any maintenance, cleaning, changing the globe or making any adjustment to the fitting.
- The external flexible cable or cord of this luminaire cannot be replaced; if the cable or cord is damaged, the luminaire shall be destroyed.
- To avoid injury or damage to the fitting, ensure that power leads and screws are secure before connecting the power.
- Young children should be supervised to ensure that they do not play with the portable lamp.
- Handle the fitting and/or shade with care to avoid any damage or breakage.
- Select a suitable location away from liquids and hazards.
- Ensure that the fitting does not come in contact with corrosive chemicals, etc.
- To clean, wipe with a damp clean cloth. Never soak the fitting with water.

Specifications

SKU #	261105	261106
Colour	Wash Grey	Walnut
Rated Voltage	220-240V~ 50Hz	
Rated Wattage	45W Max. (fancy round globe recommended)	
Lamp Holder	ES / E27	
Weight	3.0kg	
Dimensions	L:685mm W:200mm H:775mm MAX	