

WILFRED TABLE LAMP

SKU# 281020, 281021, 281022, 281023

Rated Voltage 220-240V~ 50Hz

Thank you for purchasing this quality Lucci product. To ensure correct function and safety, please read and follow all instructions carefully before assembly, installation and use of this product. Please keep the instructions for future reference.

Warranty

- This fitting is covered by a 12 month warranty from the date of purchase. Please retain proof of purchase.
- Warranty will be void if there is any damage due to improper usage or modification to the fitting.
- Failure to comply with the instructions in this manual may increase the risk of damage or injury and will void warranty.

Installation Requirements

- Select a suitable location for this light fitting:
 - This product is suitable for indoor use only.
 - Do not place flammable material near or over the fitting.
 - Ensure the fitting is not installed in direct line of an air vent/system.
 - If the fitting is placed in an area prone to moisture, ensure that the area is well ventilated and an appropriately rated exhaust fan is used if required. Damage or corrosion caused by moisture is not a product fault, and as such is not covered under warranty.
- Do not exceed the maximum wattage rating.
- Take care not to pull any electrical wires during unpacking as this may damage the connection.
- Lay out all the components on a smooth surface and make sure there are no components missing before assembling. If parts are missing, return the complete product to the place of purchase for inspection or replacement.
- Check whether the fitting has been damaged during transport. Do not operate/install any product which appears damaged in any way. Return the complete product to the place of purchase for inspection, repair or replacement.
- Do not plug into the mains power socket outlet before or during assembly. Only do so after the portable lamp is fully assembled with the globe installed and is ready to use for the first time.

Installation Directions

1. Remove all packaging material from the product.
2. Join the upper arm (C) and lower arm (F) together and secure by installing the washer (E) and locking knob (D).
3. Select a suitable location for the light fitting. See the installation requirements above.
4. Adjust the angle of the upper arm (C) by loosening the locking knob (D) first.
Do not use excessive force as this may damage the adjustable joint and the wiring.
NOTE: Never adjust the upper arm (C) without first loosening the locking knob (D).
NOTE: When adjusting the upper arm (C), do not adjust more than 142° as this may damage the wiring.
5. After adjusting the upper arm (C) to the desired angle, re-tighten the locking knob (D).
Ensure the fitting is well balanced and will not tip over easily.
6. Install a globe (G - not included) into the lamp holder. Do not exceed the maximum wattage rating.
7. Insert the plug (A) into the mains power socket outlet and ensure it is fully plugged in.
8. Turn power on at the mains power socket outlet.
9. Use the cord line switch (B) to turn the lamp on/off.

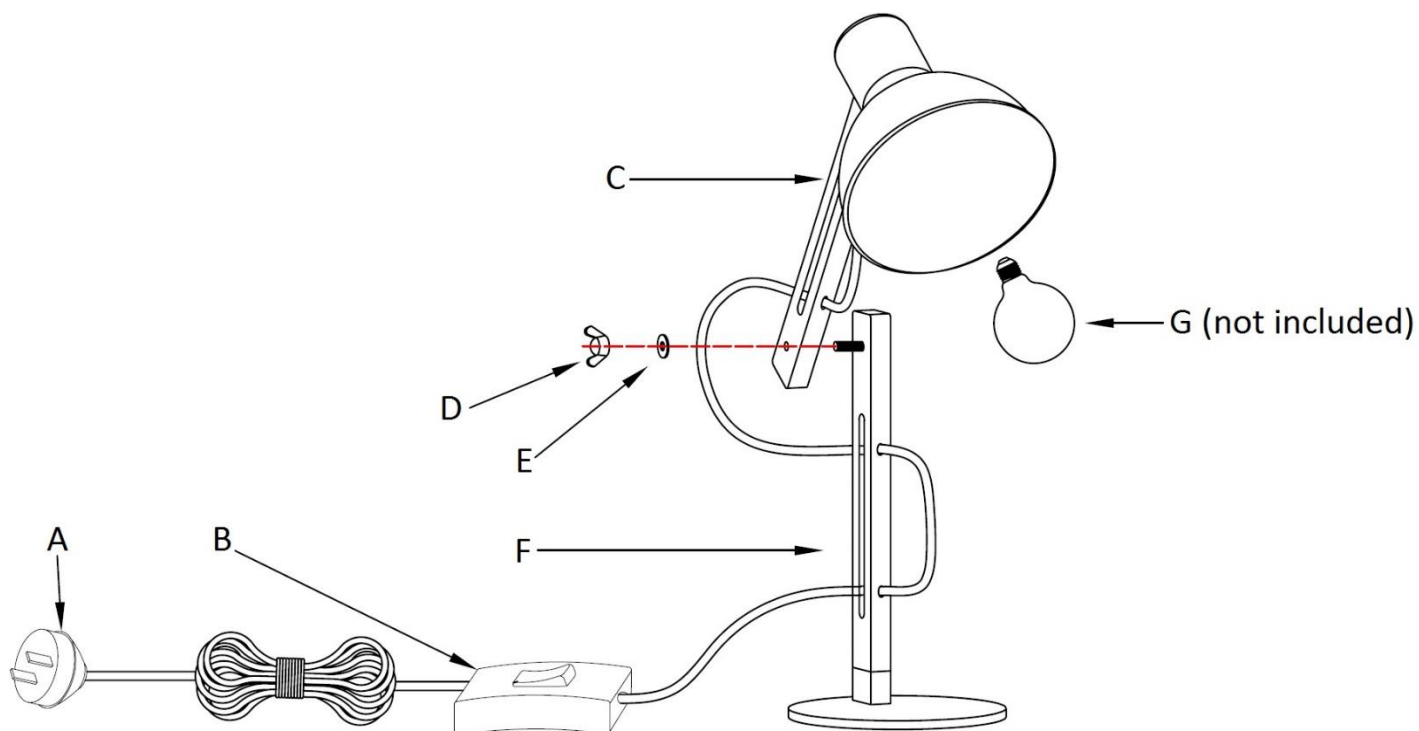

NOTE: Never adjust the upper arm (C) without first loosening the locking knob (D).

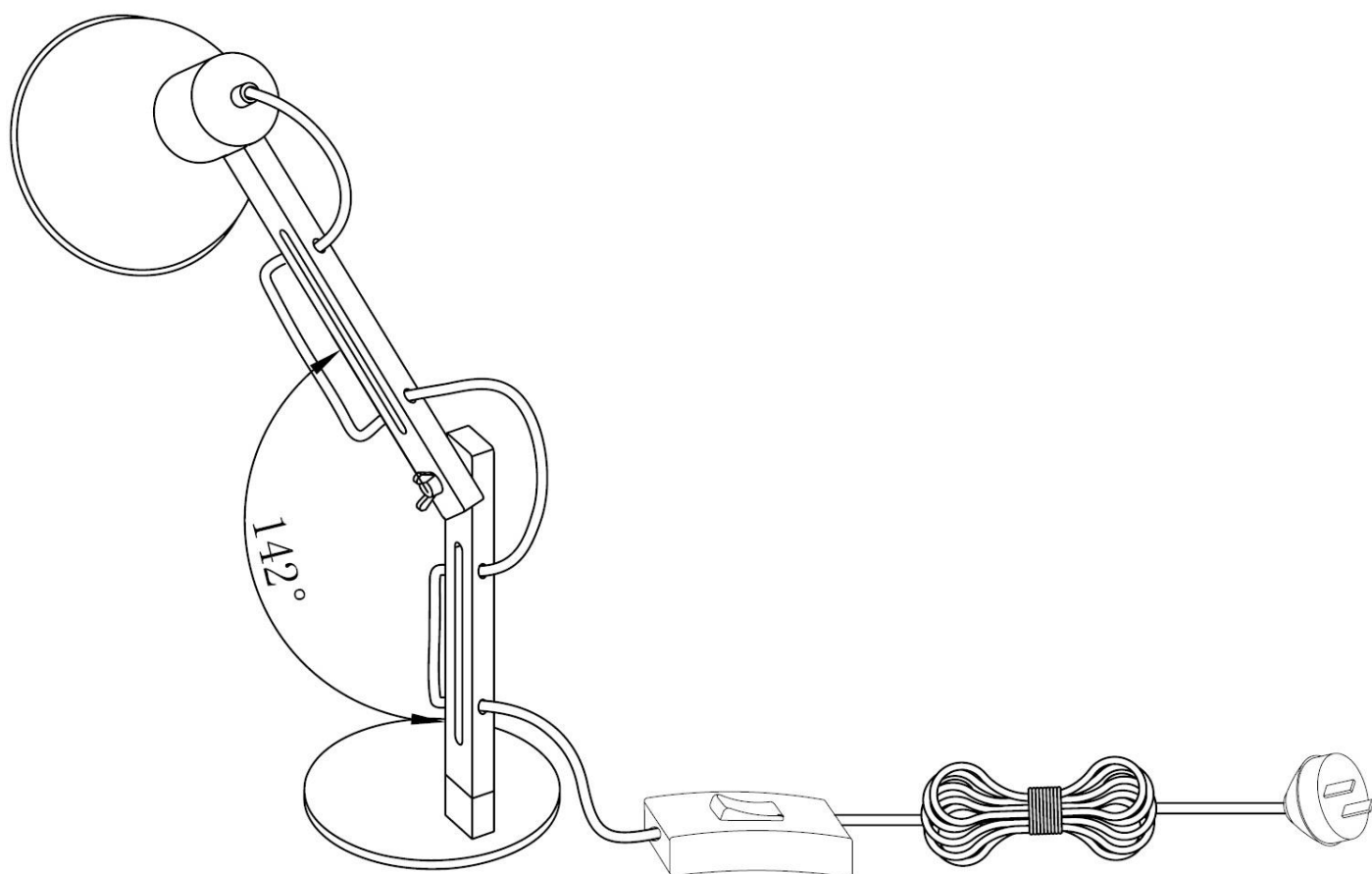

NOTE: When adjusting the upper arm (C), do not adjust more than 142° as this may damage the wiring.

Safety Tips

- Always ensure the power is OFF and the fitting has cooled down before performing any maintenance, cleaning, changing the globe or making any adjustment to the fitting.
- During normal operation the shade may be hot to touch. If any adjustment needs to be made, please touch the bottom section of the shade or wait until the fitting has cooled down.
- The external flexible cable or cord of this luminaire cannot be replaced; if the cable or cord is damaged, the luminaire shall be destroyed.
- To avoid injury or damage to the fitting, ensure that power leads and screws are secure before connecting the power.
- Young children should be supervised to ensure that they do not play with the portable lamp.
- Handle the fitting and/or shade with care to avoid any damage or breakage.
- Select a suitable location away from liquids and hazards.
- To clean, wipe with a soft damp cloth. Do NOT soak or immerse the product in water or other liquids.
- Ensure that the fitting does not come in contact with corrosive chemicals/solvents or abrasive cleaners etc.

Specifications

SKU #	281020	281021	281022	281023
Colour	Matte White	Matte Black	Grey	Mint
Rated Voltage	220-240V~ 50Hz			
Rated Wattage	45W Max.			
Lamp Holder	ES / E27			
Weight	1.4kg			
Dimensions	H:590mm L:370mm W:160mm MAX			