

Lucci Connect Smart Motion Sensor

SKU# 299042

Rated Voltage 3.0V DC

Thank you for purchasing this quality Lucci product. To ensure correct function and safety, please read and follow all instructions carefully before assembly, installation and use of this product. Please keep the instructions for future reference.

Warranty

- This device is covered by a 2-year warranty from the date of purchase. Please retain the proof of purchase.
- Warranty will be void if there is any damage due to improper usage or modification to the device.
- Failure to comply with the instructions in this manual may increase the risk of damage or injury and will void warranty.

Installation Requirements

- **Battery:** 1 x 3V CR2450 button battery (included).
- Select a suitable location for this device:
 - This device is not waterproof.
 - This device is suitable for indoor or dry location use only.
 - Keep away from liquids, dusty, humid, direct sunlight or hot areas.
- Lay out all the components on a smooth surface and make sure no components are missing. If parts are missing, return the complete device to the place of purchase for inspection or replacement.
- Check whether the device has been damaged during transport. Do not operate/install any device which appears damaged in any way. Return the complete device to the place of purchase for inspection, repair or replacement.

Operation Directions

Battery installation & replacement

1. Unscrew and open the battery compartment lid. Install CR2450 battery into the battery box. Ensure the batteries are inserted with the correct polarity.

NOTE: CR2450 battery is included and make sure the insulation film is removed for the first time to use.

2. Install the battery compartment lid back then tighten the screw. **Check and ensure the screw is tightened and the lid is secure.**

Installation & Operation

1. Use the provided 3M tape to stick the device on the desired location.

NOTE: Ensure the surface is smooth, dry and clean before applying the '3M' adhesive tape.

2. Set up the wireless & in-app control according to the 'Lucci CONNECT user guide'.

NOTE: Turn on the Bluetooth function of your mobile phone before setting up.

NOTE: MUST BE used with Lucci gateway (SKU# 299075, sold separately) to receive notification & control other 'Lucci CONNECT' products.

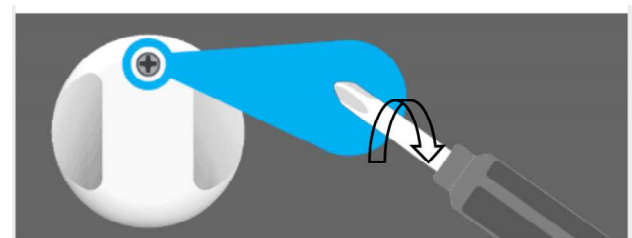
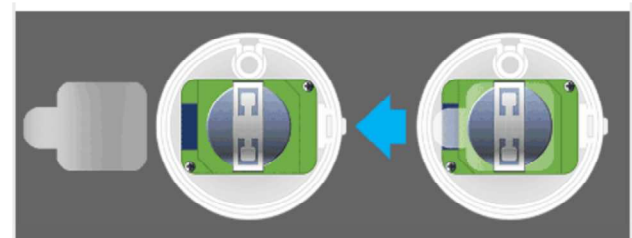
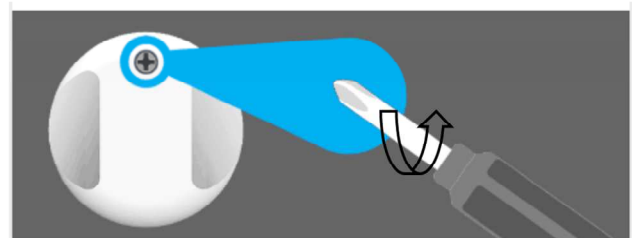

Battery Tips and Warnings

- **WARNING – KEEP BATTERIES OUT OF REACH OF CHILDREN.**
- **CAUTION – Do not ingest battery—Chemical burn hazard.**
- If the coin/button cell battery is swallowed, it can cause severe internal burns in just 2 hours and can lead to death due to chemical burns and potential perforation of the oesophagus.
- If you think batteries might have been swallowed or placed inside any part of the body, seek immediate medical attention.
- If you suspect your child has swallowed or inserted a button battery, immediately call the 24-hour Poisons Information Centre on **13 11 26** for fast, expert advice.
- Regularly check the product and make sure the battery box lid is correctly secured. If the battery compartment does not close securely, stop using the product and keep it away from children.
- If the battery box lid has been cracked or damaged, do not continue to use this product.
- Dispose of used batteries immediately and safely (so they cannot be retrieved by children). Flat batteries can still be dangerous.
- Keep new and used batteries away from children.
- Exhausted batteries are to be removed from the product.
- Batteries shall only be installed or replaced by an adult. Securely tight the battery box lid after replacement.
- Do not use rechargeable batteries in this product.
- The supply terminals are not to be short-circuited.
- Ensure the batteries are inserted with the correct polarity.
- Remove batteries from the product when not in use for long periods of time.

Safety Tips and Warnings

- This device is NOT a toy. Keep out of reach of young children.
- Young children should be supervised to ensure that they do not play with this device.
- To clean, wipe with a soft dry cloth or duster. Do NOT soak or immerse the device in water or other liquids.
- Ensure that the device does not come in contact with corrosive chemicals/solvents or abrasive cleaners etc.

Specifications

SKU #	299042	
Colour	White	
Rated Voltage	3V DC	
Motion Sensor spec	Wall mounted	Ceiling mounted
	PIR Sensor, Detection range & angle: Max.4M 120 degree, Recommended height 1.2 – 1.8M	PIR Sensor, Detection range & angle: Max.6M 360 degree, Recommended height 2.2 – 3M
Battery	3V CR2450 Button Battery (Included)	
Weight	0.03kg	
Dimensions	D: 48mm H: 27mm	