

FINO WALL BRACKET

SKU# 309047, 309048

Rated Voltage 220-240V~ 50Hz

To ensure correct function and safety, please read and follow all instructions carefully before assembly, installation, and use of this product. Please keep instructions for future reference.

Warranty

- This luminaire is covered by a 12-months warranty. The warranty is from date of purchase, not the date of installation.
- If the luminaire is not assembled and installed by a licensed electrician, the warranty will be void.
- Please retain the proof of purchase and evidence of installation by a licensed electrician for any warranty enquiries.
- Warranty will be void if there is any damage due to improper usage or modification to the luminaire.
- Failure to comply with the instructions in this manual may increase the risk of damage or injury and will void the warranty.

Installation Requirements

- This luminaire must be assembled and installed by a licensed electrician.
- All wiring and installation of the luminaire must adhere to the latest local and national wiring rules.
E.g. AS/NZS 3000 Electrical Installations.
- The luminaire is a Class I product and must be earthed during wiring and installation.
- Do not exceed the maximum wattage rating.
- Select a suitable location for installation:
 - This luminaire is suitable for indoor use only.
 - The mounting point must support 2 times the weight of the luminaire.
 - If installing a luminaire in an area prone to moisture, ensure that the area is well ventilated, and an appropriately rated exhaust fan is used if required. Damage or corrosion caused by moisture is not a product fault, and as such is not covered under warranty.
- Take care not to pull any electrical wires during unpacking as this may damage the connection.
- Lay out all the components on a smooth surface and make sure no components are missing before assembling.
- If parts are missing, return the complete product to the place of purchase for inspection or replacement.
- Check whether the luminaire has been damaged during transport. Do not operate/install any product which appears damaged in any way. Return the complete product to the place of purchase for inspection, repair, or replacement.

Installation Directions

Remove all packaging material from the product and be careful not to throw away accessories that may be hidden within the packaging material. If assembly is required, place the luminaire on a smooth non-scratch surface.

FIGURE A

1. Ensure power to the circuit you are working on has been switched OFF before commencing any electrical work.

FIGURE B

1. Loosen the screws at the top of the luminaire.
2. Remove the shade from the mounting bracket by lifting the shade upwards and away from the mounting bracket.
3. Pull the mains supply wire through the wiring hole in the mounting bracket.
4. Use the mounting bracket as a template to mark the screw positions on the wall. Install the mounting bracket onto the wall using appropriately sized mounting screws. Ensure the screws used are suitable for the mounting surface and the surrounding environment.
5. Connect the mains supply wire to the terminal block and earth wire to the back of lamp holder and secure with the screw. Ensure that the wires are secure, and no bare wires are exposed.

Mains Supply Wire	Luminaire Wire / Terminal block
Earth – Yellow/Green	Yellow/Green or 
Neutral – Blue or Black	Blue or N
Live – Brown or Red	Brown or L

NOTE: The luminaire is a Class I product and must be earthed during wiring and installation.
NOTE: The installing electrician must ensure the supply wire maintains double insulation after connecting to the terminal block

6. Install the terminal block cover back over the terminal block.
7. Secure the terminal block cover by tightening with the screws.
8. Install the shade back onto the mounting bracket.
9. Install a globe (not included) into the lamp holder. Do not exceed the maximum wattage rating.
10. Affix the shade to the mounting bracket by tightening the screws on the top of the luminaire.

NOTE: Ensure the shade is flush against the wall and there is no gap.

FIGURE C

1. After the luminaire has been fully installed, switch on the luminaire to test and enjoy your new lighting product.

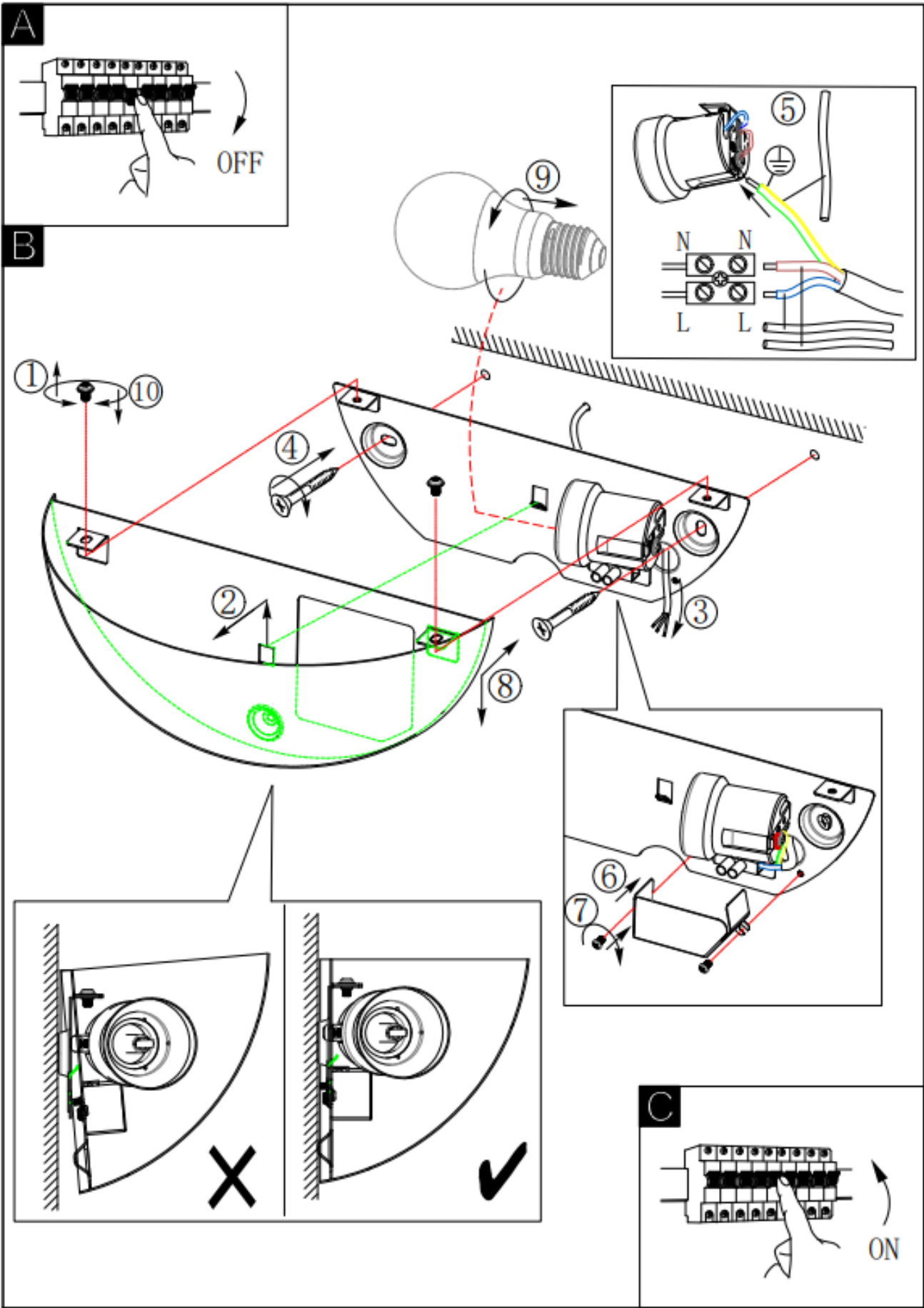

Safety Tips

- Always ensure the power is OFF and the luminaire has cooled down before performing any maintenance, cleaning, changing the globe or making any adjustment to the luminaire.
- To avoid injury or damage to the luminaire, ensure that power leads and screws are secure before connecting the power.
- Select a suitable location away from liquids and hazards.
- To clean, wipe with a soft damp cloth. Do NOT soak or immerse the luminaire in water or other liquids.
- Ensure that the luminaire does not come in contact with corrosive chemicals/solvents or abrasive cleaners etc.

Specifications

SKU #	309047	309048
Art. No.	206001	206002
Colour	Black	White
Rated Voltage	220-240V~ 50Hz	
Rated Wattage	25W Max.	
Lamp Holder	ES / E27	
Weight	0.5kg	
Luminaire Dimensions	H:111mm W:246mm E: 105mm	