

## BOULDER SQUARE WALL BRACKET

SKU# 239361

Rated Voltage 220-240V~ 50Hz

Thank you for purchasing this quality Lucci product. To ensure correct function and safety, please read and follow all instructions carefully before assembly, installation and use of this product. Please keep instructions for future reference.

### Warranty

- This light fitting is covered by a 12 month warranty. The warranty is from date of purchase, not the date of installation.
- If the fitting is not assembled and installed by a licensed electrician the warranty will be void.
- Please retain proof of purchase and evidence of installation by a licensed electrician.
- Warranty will be void if there is any damage due to improper usage or modification to the fitting.
- Failure to comply with the instructions in this manual may increase the risk of damage or injury and will void warranty.

### Installation requirements

- Must be assembled and installed by a licensed electrician.
- All wiring and installation of the light fitting must adhere to local and national wiring rules.  
eg. AS/NZS 3000:2007/Amendment 2:2012 Electrical installations.
- Do not exceed the maximum wattage rating.
- Select a suitable location for installation:
  - This fitting is protected against water penetration to IP65 standards, which is against low pressure jets of water from all practicable direction. This must be maintained during installation.
  - It is suitable for indoor or outdoor use.
  - The mounting point must support 2 times the weight of the fitting.
- Take care not to pull any electrical wires during unpacking as this may damage the connection.
- Lay out all the components on a smooth surface and make sure there are no components missing before assembling. If parts are missing, return the complete product to the place of purchase for inspection or replacement.
- Check whether the fitting has been damaged during transport. Do not operate/install any product which appears damaged in any way. Return the complete product to the place of purchase for inspection, repair or replacement.

### Installation directions

1. Remove all packaging material from the product and be careful not to throw away accessories that may be hidden within the packaging material.
2. Ensure power to the circuit you are working on has been switched OFF. (Fig.1)
3. Remove the mounting bracket by loosening the screws from the side. (Fig.2)
4. Install the mounting bracket on the wall by using appropriately sized mounting screws and anchors. Ensure the screws and anchors used are suitable for mounting surface and the surrounding environment. (Fig.3)
5. Connect the mains supply wire to the light fitting using the terminal block provided. (Fig.4) Ensure that the wires are secure and no bare wires are exposed.

#### Mains Supply Wire

Live – Brown or Red

Neutral – Blue or Black

#### Terminal block

Live (L)

Neutral (N)

**NOTE: It is recommended that a non-corrosive bead of silicone be applied before installation onto the wall ensuring that no water can run down into the cabling.**

6. Fix the terminal block on the mounting bracket. (Fig.5) Make sure it is firm and secure.
7. Install the fitting back onto the mounting bracket by tightening the screws on the both sides. (Fig.6)
8. Remove the lamp covers by loosening the screws. (Fig.7)
9. Install the globes (not included) into the lamp holders. (Fig.8) **Do not exceed the maximum wattage rating.**

10. Install the lamp covers back onto the fitting by tightening the screws. (Fig.9)

11. Make any final adjustments to the fitting and check that all parts are secured tightly before turning the power on.

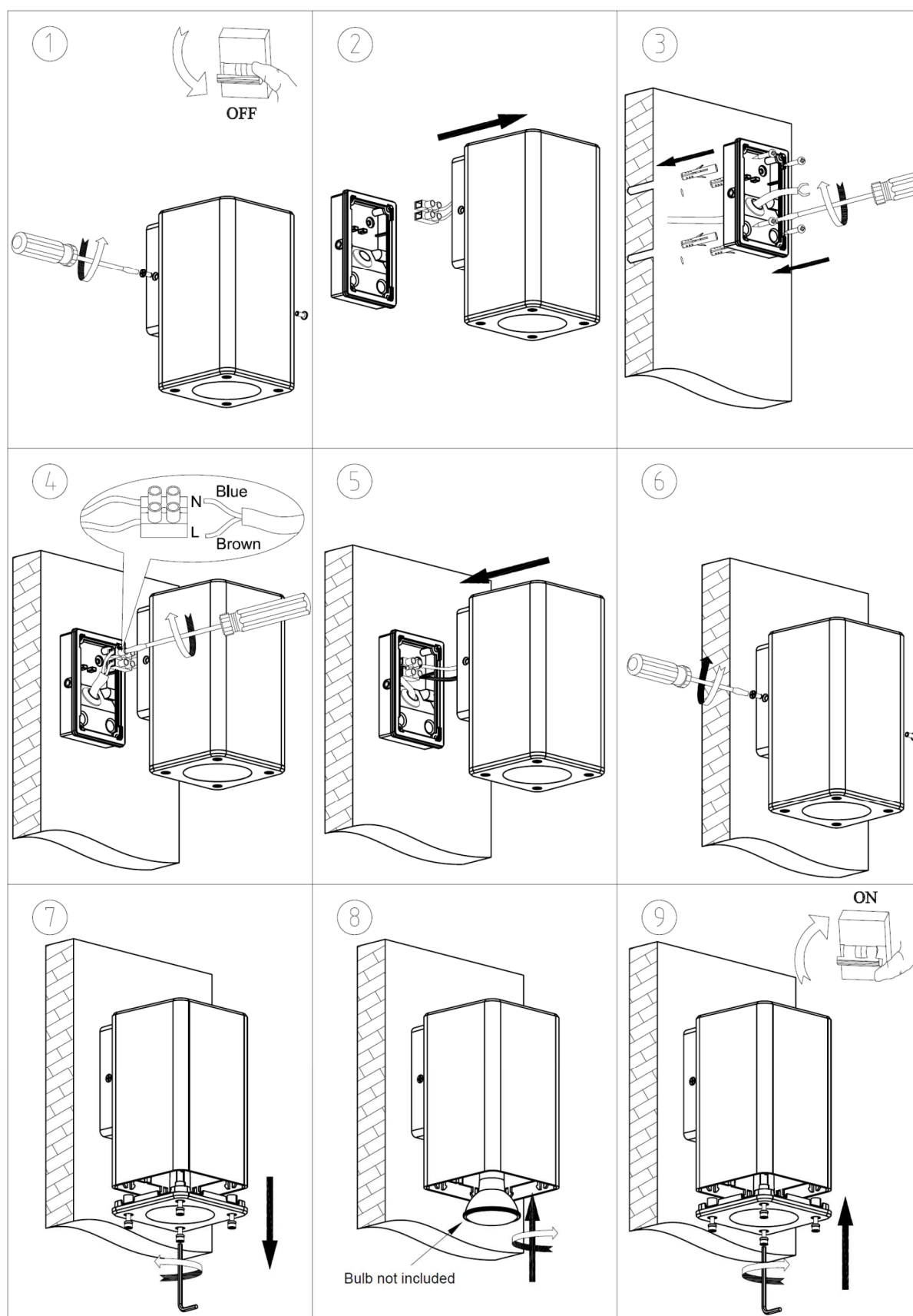

## Safety tips

- Always ensure the power is OFF and the fitting has cooled down before performing any maintenance, cleaning, changing the globe or making any adjustment to the fitting.
- To avoid injury or damage to the fitting, ensure that power leads and screws are secure before connecting the power.
- The fitting must not be used if the shade has been cracked. Replace any cracked protective shield.
- Ensure that the fitting does not come in contact with corrosive chemicals/solvents or abrasive cleaners etc.
- To clean, wipe with a damp clean cloth. Do NOT soak or immerse the product in water or other liquids.

## Specifications

SKU #	239361
Colour	Black
Rated Voltage	220-240V~ 50Hz
Rated Wattage	8W Max. (LED Only)
Lamp Holder	GU10
IP Rating	IP65
Weight	0.4kg
Dimensions	H:160mm W:90mm E:113mm