

## SUNSET SOLAR LED REC WALL SCONCE WITH SENSOR

SKU#240741

Rated Voltage 3.7 VDC

Thank you for purchasing this quality Lucci product. To ensure correct function and safety, please read and follow all instructions carefully before assembly, installation and use of this luminaire. Please keep instructions for future reference.

### Warranty

- This luminaire is covered by a 3 year warranty. The warranty is from date of purchase, not the date of installation.
- Warranty will be void if there is any damage due to improper usage or modification to the luminaire.
- Failure to comply with the instructions in this manual may increase the risk of damage or injury and will void warranty.

### Installation requirements

- Select a suitable location for installation;
  - This product is suitable for outdoor use only.
  - This product is protected against water penetration to IP44 standards, which is splashing in every direction and is not designed to be immersed in water.
- Lay out all the components on a smooth surface and make sure there are no components missing before assembling. If parts are missing, return the complete product to the place of purchase for inspection or replacement.
- Check whether the luminaire has been damaged during transport. Do not operate/install any product which appears damaged in any way. Return the complete product to the place of purchase for inspection, repair or replacement.

### Installation directions

1. Remove all packaging material from the product and be careful not to throw away accessories that may be hidden within the packaging material.
2. Use the mounting bracket as a template to mark the screw positions onto the wall. Drill holes into the wall and push plastic anchors into the holes. (Fig.1)
3. Install the mounting bracket onto the wall by using the mounting screws. Ensure that the anchors and mounting screws used are suitable for the mounting surface. (Fig. 2)  
NOTE: Choose a best installation position where the sensor can detect the body motion movement.  
NOTE: The ideal mounting height for the fitting is between 1.5m to 2.3m above the detection area.  
NOTE: The detection area is approximately 6 metres away at an angle of 90° wide. This may vary depending on the mounting height and location.
4. Turn the ON/OFF switch to the ON position. Then the solar panel can charge the battery under sunlight when the ambient light level is higher than 20 lux. When there is no sunlight and the ambient light level is below 20lux, the luminaire will activate the detect function. And when detect the body movement, the LED will light up and lasting for 40s.  
NOTE: If you want to test the detection area of the PIR sensor, please wait for the ambient light level is below 20 lux, Or cover the solar panel by light-proof material.
5. Secure the luminaire on the mounting bracket using the hooks on the mounting bracket. (Fig. 3)

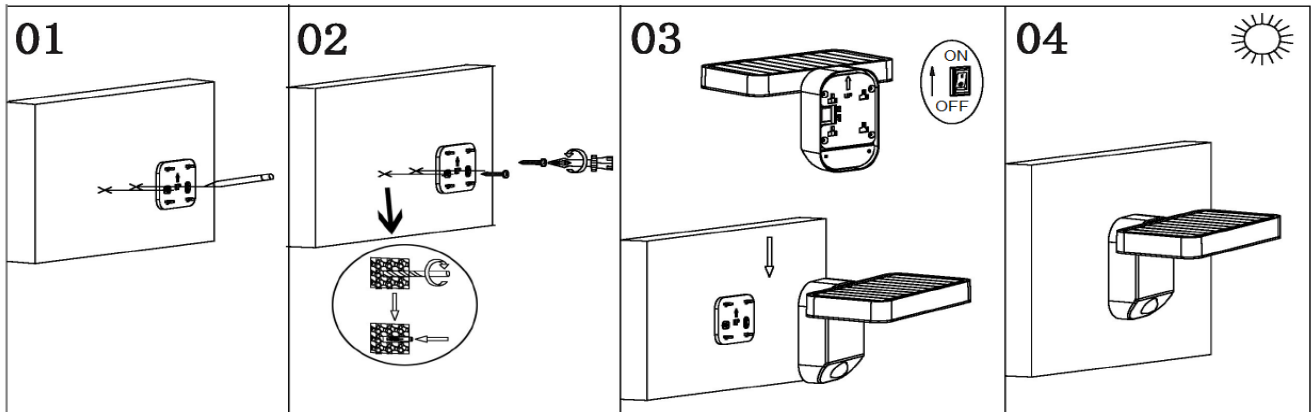

6. The luminaire has a built-in rechargeable battery.

ICR18650 (3.7V 2Ah) type battery located inside the unit has a limited life of up to 1 year. After this time the battery can be changed over with a new one simply by:

- Removing the battery compartment cover from the solar unit body by loosening the 4 screws. Fig. 5
- Replace the battery with a new one. Make sure the polarity is right. Fig.6
- Secure the battery compartment cove back using the screws. Fig.7

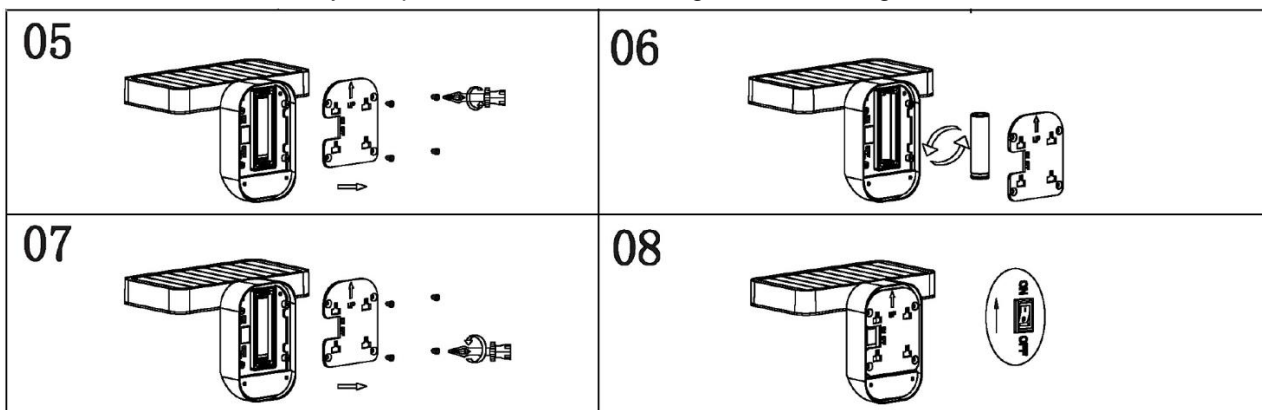

## Safety tips

- Do not drop the system or make impact to the system.
- Do not turn on the ON/OFF switch during transportation, faulty condition, or dangerous condition (battery leakage, control unit box damaged / burned / high temperature).
- Do not install the luminaire in a position where sunlight cannot reach the solar panel.
- The light source contained in this luminaire shall only be replaced by the manufacturer or his service agent or a similar qualified person.

## Specifications

SKU	240741
Rated Voltage	3.7 VDC
IP Rating	IP44
Dimensions	H:120mm x W:180mm x E:127mm
Battery	ICR18650 (3.7V 2.0Ah) rechargeable Li-ion battery
LEDS	200 lumens, MAX 4W , 3000K
Light up times	>100 times when fully charged (and there has been sufficient sunlight)
Weight	0.4kg