

## FORT LED 2 LIGHT SPOT WITH SENSOR

SKU# 240756, 240757

Rated Voltage 220-240V~ 50Hz

Thank you for purchasing this quality Bayside product. To ensure correct function and safety, please read and follow all instructions carefully before assembly, installation and use of this luminaire. Please keep instructions for future reference.

### Warranty

- This luminaire is covered by a 2 year warranty. The warranty is from date of purchase, not the date of installation.
- If the luminaire is not assembled and installed by a licensed electrician the warranty will be void.
- Please retain proof of purchase and evidence of installation by a licensed electrician for any warranty enquiries.
- Warranty will be void if there is any damage due to improper usage or modification to the luminaire.
- Failure to comply with the instructions in this manual may increase the risk of damage or injury and will void warranty.
- This luminaire is not suitable for use with dimmer switches. Warranty will be void if the luminaire is used on the same circuit which has a dimmer switch.

### Installation Requirements

- Must be assembled and installed by a licensed electrician.
- All wiring and installation of the luminaire must adhere to the latest local and national wiring rules. eg. AS/NZS 3000 Electrical Installations.
- This luminaire is a Class I product and must be earthed.
- This luminaire is rated IP44. This must be maintained during installation.
- Select a suitable location for installation:
  - This luminaire is suitable for indoor and outdoor use.
  - The mounting point must support 2 times the weight of the luminaire.
  - This luminaire must not be mounted on a surface which can be subject to vibrations
  - This luminaire is protected against water penetration to IP44 standards, which is splashing water from any direction.
  - This luminaire is not suitable for dimming and should not be used with a circuit which has a dimmer.
- The LED lights are not suitable for dimming and should not be used with a circuit which has a dimmer. Warranty will be void if the luminaire is used on the same circuit which has a dimmer switch
- Take care not to pull any electrical wires during unpacking as this may damage the connection.
- Lay out all the components on a smooth surface and make sure there are no components missing before assembling. If parts are missing, return the complete product to the place of purchase for inspection or replacement.
- Check whether the luminaire has been damaged during transport. Do not operate/install any product which appears damaged in any way. Return the complete product to the place of purchase for inspection, repair or replacement.
- Ensure power to the circuit you are working on has been switched OFF before commencing any electrical work

## Sensor Information

### **PIR (PASSIVE INFRA RED) SENSOR:**

This luminaire has a PIR (Passive Infra Red) sensor which continuously scans the operating zone and immediately switches the luminaire on when it detects movement in that area. Whenever movement is detected within the range of the sensor, the luminaire will switch on automatically to illuminate the area. While there is movement within the sensor range, the luminaire will remain on.

### **SENSOR LOCATION & INFORMATION:**

To find a suitable location for installation, please take into consideration the following points:

- The ideal mounting height for the luminaire is between 2.3m to 2.7m above the detection area (figure 1).
- The detection area is approximately 5m to 12m away at an angle of 100° wide. This will vary depending on the mounting height and location.
- The detection area may also alter at different temperatures. PIR sensors are more sensitive in cold weather than warm weather.
- The sensor has better sensitivity with movement across the detection area (figure 2).
- The sensor has reduced sensitivity with movement towards and away from the detection area (figure 3).
- If movement is made walking directly towards or away from the sensor and not across, the apparent detection range will be substantially reduced.
- To avoid false triggering, the sensor should be directed away from potential heat sources, such as barbecues, air-conditioners, air vents etc.
- Also avoid areas with electromagnetic disturbance, outside luminaires, moving cars, trees or pets etc.
- Avoid installing the luminaire in close proximity or on the same circuit to any fluorescent luminaires or ceiling fans. RFI (Radio Frequency Interference) may cause the luminaire to switch on unintentionally.
- Do not aim the sensor towards reflective surfaces, such as smooth white walls, swimming pools etc.
- To avoid damage to the sensor, do not aim the sensor towards the sun.
- It is recommended that the luminaire is installed on its own switch and does not interconnect with other lights on the same switch as it may cause false triggering.

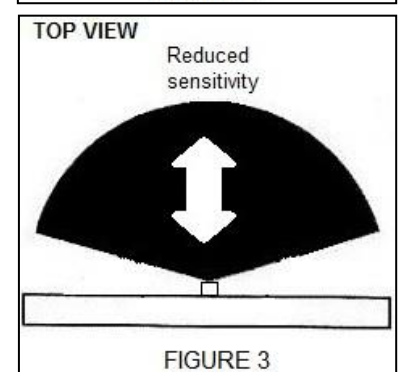
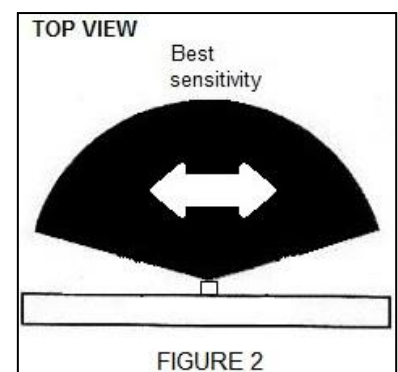
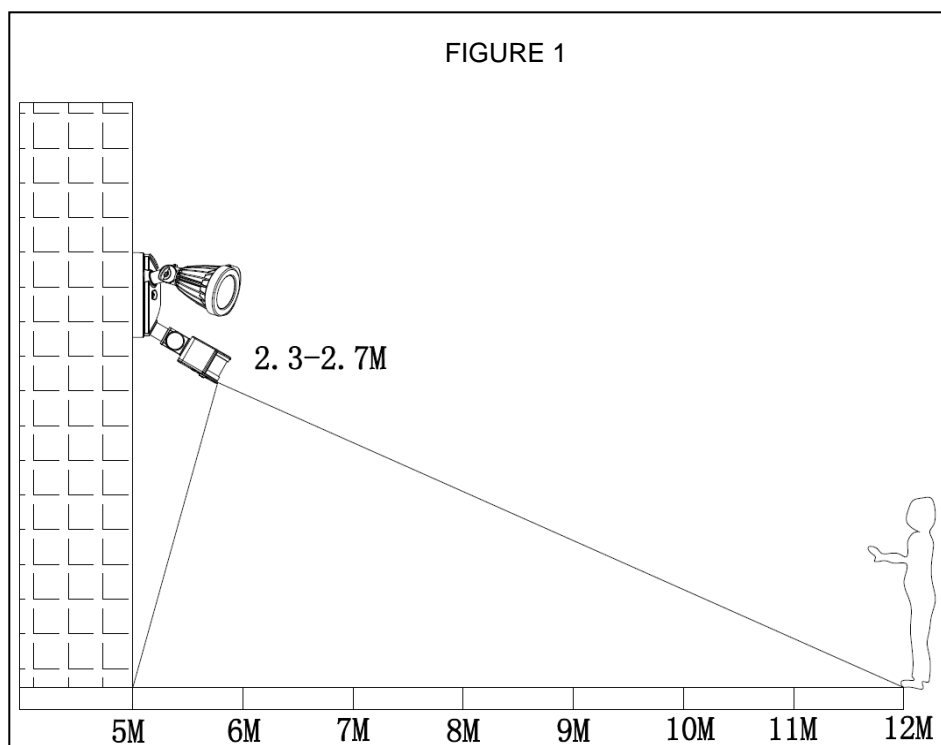

## Installation Directions

1. Remove all packaging material from the product and be careful not to throw away accessories that may be hidden within the packaging material. If assembly is required, place the luminaire on a smooth non-scratch surface.
2. Loosen the two screws on the front of the luminaire and carefully place the screws and washers aside. (Fig A)
3. Remove the body of the luminaire from the mounting bracket. (Fig B)
4. Use the mounting bracket as a template to mark the screw positions onto the wall. (Fig C)  
NOTE: Ensure the directional arrow is facing up on the mounting bracket.
5. Drill holes into the wall and install anchors. Ensure the anchors used are suitable for the mounting surface (Fig D & E)
6. Push the mains supply wire through the cord entry point on the mounting bracket. (Fig F)

**NOTE: It is recommended that a non-corrosive bead of silicone be applied before installation to ensure no water can run down the cable and into the luminaire.**

7. Install the mounting bracket onto the wall by using appropriately sized mounting screws and washers. Ensure the mounting screws used are suitable for the mounting surface and the surrounding environment. (Fig F)  
NOTE: Ensure the directional arrow is facing up on the mounting bracket.
8. Connect the mains supply wire to the terminal block. Ensure the wires are secure and no bare wires are exposed. (Fig G)

### Mains Supply Wire

Earth – Yellow/Green

Neutral – Blue or Black

Live – Brown or Red

### Luminaire Wire

Yellow/Green (⊕)

Blue or N

Brown or L

9. Install the luminaire body back onto the mounting bracket. Take care not to damage any of the internal wires and secure by installing the screws and washers onto the front of the luminaire. (Fig H)
10. Adjust the LED head and sensor to the desired position.

**NOTE: When adjusting the head or sensor, do not bend more than 180° and do not rotate more than 300° as this may damage the internal wires and void the warranty. (Fig I)**

11. Switch the power to circuit back ON only after all electrical work has been fully completed and the luminaire is fully assembled and is ready to use for the first time. Test all the lighting functions and enjoy your new luminaire.

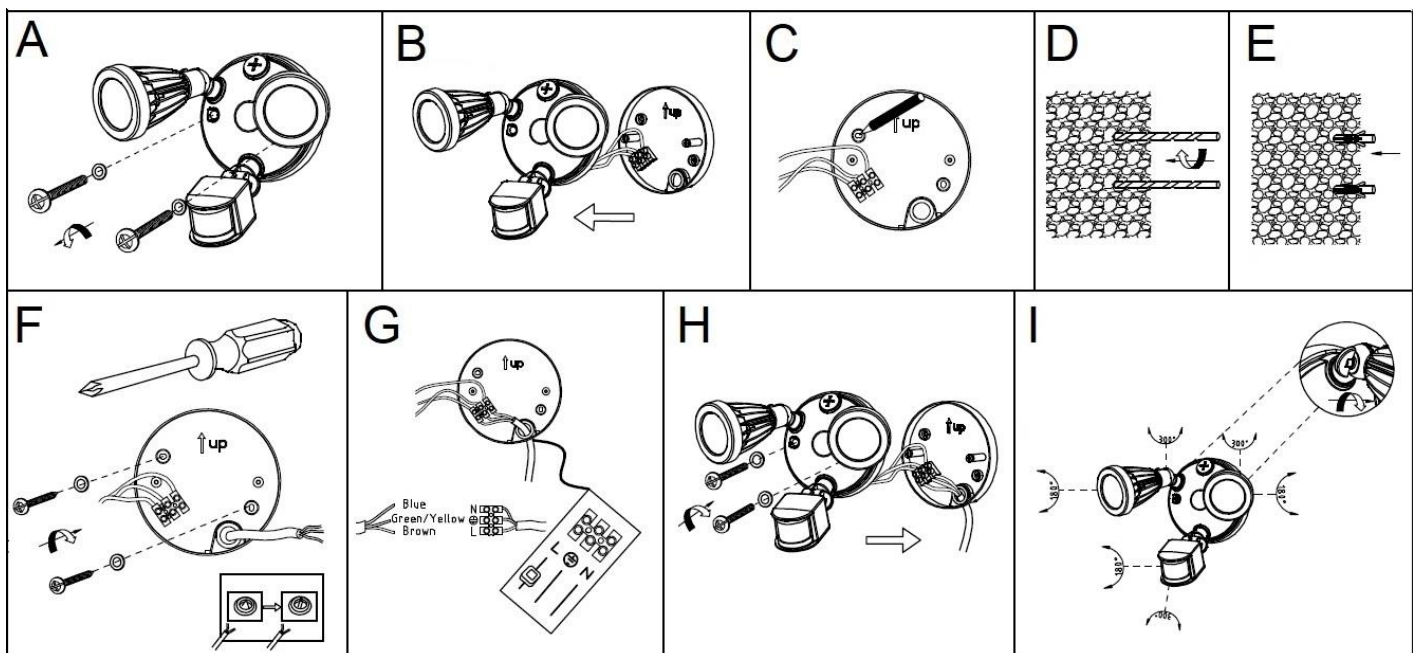

## **SENSOR SETTINGS:**

**DURATION TIME:** The length of time the light will remain switched on after activation can be adjusted from 10secs  $\pm 5$  to 7mins  $\pm 1$ . Rotating the time from (+) to (-) will reduce the duration time.

**NOTE:** Once the luminaire has been triggered by the PIR sensor, any subsequent detection will start the timed period again from the beginning, the luminaire will remain on until there is no movement detected.

**ADJUSTING THE SENSITIVITY:** The sensitivity means the maximum distance which PIR Sensor can be triggered by movement body. Turning the SENS knob + to - will decrease the sensitivity distance.

**LUX LEVEL:** The lux control module has a built-in sensing device (photocell) that detects daylight and darkness. The (\*) position means that the luminaire will work at both day and night. The (D) position will only work at night.

**NOTE:** If you want to test the detection area of the PIR sensor, please wait for the ambient light level is below 20 lux.

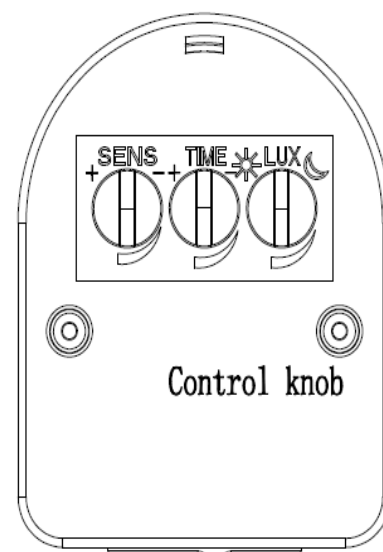

## **SENSOR TESTING:**

1. Put the LUX control knob to the light (\*) position and the TIME control knob to minimum (-). Turn the wall switch on, the luminaire will enter “self-start” mode for 5 seconds and then the luminaire will turn on and remain on for about 30 seconds in “warm-up” mode. After “warm-up” mode the light will turn off and the luminaire will be in AUTO MODE.
2. Direct the sensor toward the desired area to be scanned.
3. Have someone walk across the centre of the area to be scanned and slowly adjust the angle of the sensor until the luminaire can sense the moving person and cause the luminaire to switch on.
4. Adjust the TIME control knob to the desired length of time for the luminaire to remain on.
5. Adjust the LUX control knob to achieve the ideal ambient light for the luminaire to switch “on”.  
For the luminaire to switch ‘on’ when the ambient light is darker, switch the LUX control knob from (\*) to (D).  
For the luminaire to switch ‘on’ when the ambient light is brighter, switch the LUX control knob from (D) to (\*).  
You may need to make further adjustments to achieve your ideal light level setting.

## **MANUAL MODE: (Sensor Override Function)**

Manual mode is used when you want the luminaire to be constantly on. The PIR sensor will be disabled and not affected by the duration time and lux level settings.

1. During normal use the wall switch is in the ON position and the luminaire is in AUTO MODE with the PIR sensor detecting any movement and the luminaire will switch on and off accordingly.
2. To switch into MANUAL MODE, turn the wall switch off and on within three seconds.  
Wall switch action: OFF → ON.
3. To change back to AUTO MODE, turn off the wall switch for 1 minute. Turn the wall switch on again.  
Wall switch action: OFF (leave for 1 minute) → ON.

**NOTE:** During MANUAL MODE or AUTO MODE, by switching off the wall switch for about 1 minute this will reset the sensor mode.

Turn the wall switch on again and the PIR sensor will enter into the “self-start” mode and “warm-up” mode, the luminaire will remain on for about for 30 seconds. After this the luminaire will turn off and the luminaire will be in AUTO MODE.

## Trouble shooting

PROBLEM	POSSIBLE CAUSE	SUGGESTED SOLUTION
<b>Light does not switch on when there is movement in the detection area.</b>	No mains voltage.	Check all connections, fuses, switches.
	Nearby lighting is too bright.	Redirect sensor or relocate the unit.
	Controls set incorrectly.	Adjust the SENS control knob to the maximum setting. Adjust the LUX control knob more towards the (*) position.
<b>Light switches on for no apparent reason (false trigger)</b>	Heat sources such as air-con, Vents, heater flues, barbecues, other outside lighting, moving cars are activating sensor.	Adjust direction of sensor head away from these sources.
	Animals, birds, possums, pets etc.	Redirecting sensor head may help.
	Reflection from a swimming pool or another reflective surface.	Redirect sensor head.
<b>Light remains on.</b>	Continuously false triggered.	Redirect sensor head may help.
	Time control is set too long.	Adjust the TIME control knob to reduce the time.
<b>Light switches on during daylight hours.</b>	LUX control knob is set to daylight position.	Turn the LUX control knob towards (D) position.
<b>When setting controls in daylight the detection distance becomes shorter.</b>	Interference by sunlight.	Re-test at night.

## Safety Tips

- Always ensure the power is OFF and the luminaire has cooled down before performing any maintenance, cleaning or making any adjustment to the luminaire.
- To avoid injury or damage to the luminaire, ensure that power leads and screws are secure before connecting the power.
- Do not use the luminaire if the protective shield has been damaged or cracked. The protective shield cannot be replaced; if the protective shield is damaged or cracked, the luminaire shall be replaced and destroyed.
- To clean, wipe with a soft damp cloth. Do NOT soak or immerse the luminaire in water or other liquids.
- Ensure that the luminaire does not come in contact with corrosive chemicals/solvents or abrasive cleaners etc.
- The LEDs are not replaceable and there are no serviceable parts, do not attempt to dismantle or open the product.

## Specifications

SKU #	240756	240757
Colour	Matte Black	Matte White
Rated Voltage	220-240V~ 50Hz	
Rated Wattage	16W (2x 8W)	
LED	1000 lumens, 4000K, Non-dimmable	
IP Rating	IP44	
Weight	0.9kg	
Dimensions	H:320mm W:345mm E:170mm MAX	