

## JACKSON SPOTLIGHT

SKU# 140750, 140751, 140752, 140753, 140754, 140755, 140756, 140757,  
140758, 140759, 140760, 140761, 140762, 140763, 140764, 140765

Rated Voltage 220-240V~ 50Hz

Thank you for purchasing this quality Lucci product. To ensure correct function and safety, please read and follow all instructions carefully before assembly, installation and use of this product. Please keep instructions for future reference.

### Warranty

- This luminaire is covered by a 12 month warranty. The warranty is from date of purchase, not the date of installation.
- If the luminaire is not assembled and installed by a licensed electrician the warranty will be void.
- Please retain proof of purchase and evidence of installation by a licensed electrician for any warranty enquiries.
- Warranty will be void if there is any damage due to improper usage or modification to the luminaire.
- Failure to comply with the instructions in this manual may increase the risk of damage or injury and will void warranty.

### Installation Requirements

- Must be assembled and installed by a licensed electrician.
- All wiring and installation of the luminaire must adhere to the latest local and national wiring rules. eg. AS/NZS 3000 Electrical installations.
- This luminaire is a Class I product and must be earthed during wiring and installation.
- Do not exceed the maximum wattage rating.
- Select a suitable location for installation:
  - This luminaire is suitable for indoor use only.
  - The mounting point must support 2 times the weight of the luminaire.
  - Ensure the luminaire is not installed in direct line of an air vent/system.
  - If installing a luminaire in an area prone to moisture, ensure that the area is well ventilated and an appropriately rated exhaust fan is used if required. Damage or corrosion caused by moisture is not a product fault, and as such is not covered under warranty.
- Take care not to pull any electrical wires during unpacking as this may damage the connection.
- Lay out all the components on a smooth surface and make sure there are no components missing before assembling. If parts are missing, return the complete product to the place of purchase for inspection or replacement.
- Check whether the luminaire has been damaged during transport. Do not operate/install any product which appears damaged in any way. Return the complete product to the place of purchase for inspection, repair or replacement.
- Ensure power to the circuit you are working on has been switched OFF before commencing any electrical work.

### Installation Directions

1. Remove all packaging material from the product and be careful not to throw away accessories that may be hidden within the packaging material. To help with assembly, lay the fitting on its side on a smooth non scratch surface.
2. Remove the mounting bracket from the luminaire by loosening the screws. Fig. 1
3. Use the mounting bracket as a template to mark the screw positions on the mounting surface. Fig. 1
4. Install the mounting bracket onto the mounting surface by using appropriately sized mounting screws. Ensure the screws used are suitable for the mounting surface and the surrounding environment. Fig. 2
5. Connect the mains supply wire to the terminal block. Fig. 3

#### Mains Supply Wire

Earth – Yellow/Green  
Neutral – Blue or Black  
Live – Brown or Red

#### Luminaire Wire / Terminal block

Yellow/Green or   
Blue or N  
Brown or L

Ensure that the wires are secure and no bare wires are exposed.

6. Install the luminaire onto the mounting bracket and secure it by tightening the screws. Fig. 4
  7. Install globes (not included) into the lamp holders with the globe installation tool. Do not exceed the maximum wattage rating. Fig. 5
  8. Rotate or swing the spot lights to adjust the lighting angle. Fig. 6
- Note: When adjusting the spot lights, do not adjust more than the angles shown in figure 6 as this may damage the internal wiring and void the warranty.**
9. After the installation, switch on the luminaire to test and enjoy your new lighting product. Fig.10

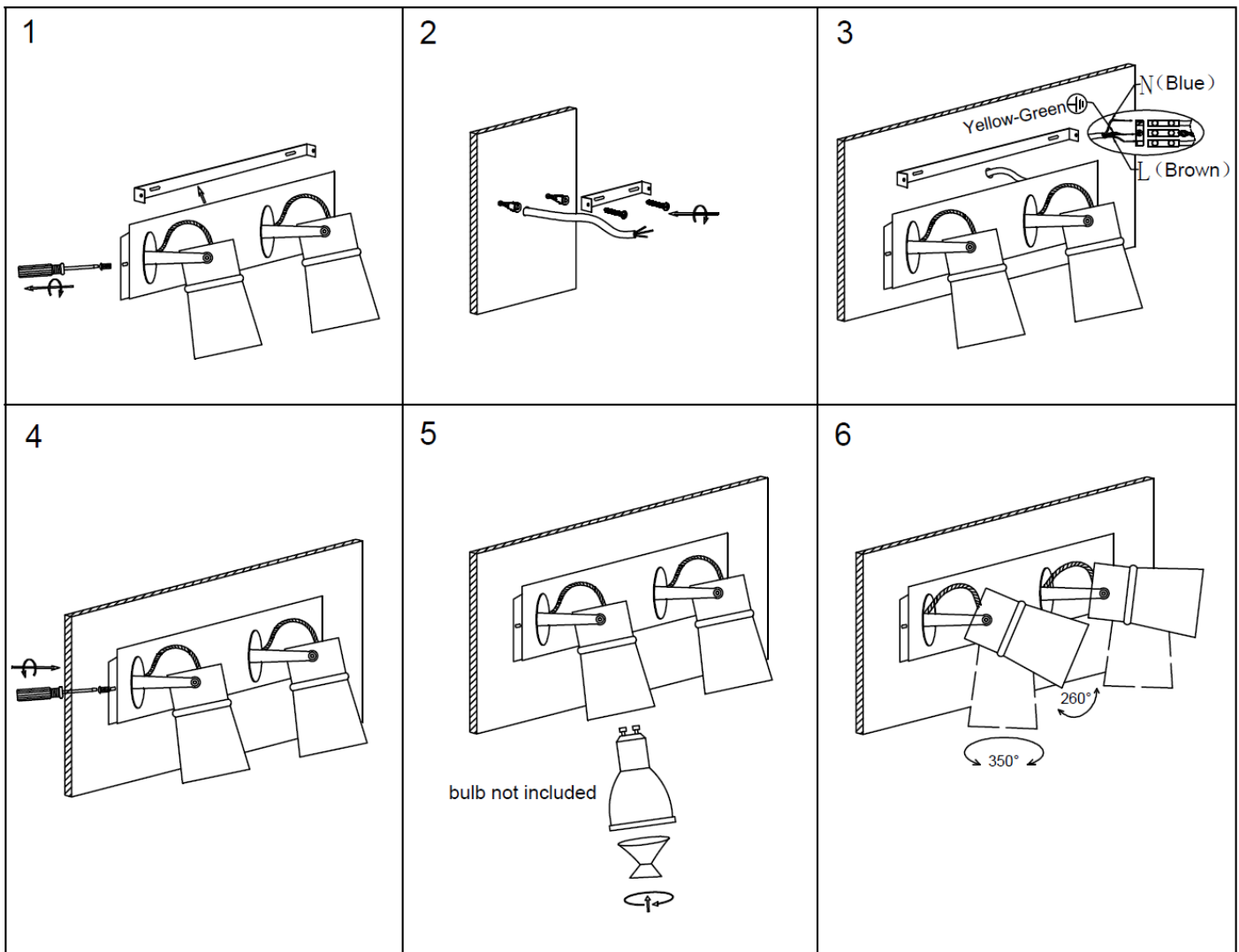

**Note: When adjusting the spot lights, do not adjust more than the angles shown in figure 6 as this may damage the internal wiring and void the warranty.**

## Safety Tips

- Always ensure the power is OFF and the luminaire has cooled down before performing any maintenance, cleaning, changing the globe or making any adjustment to the luminaire.
- Do not touch the globe with bare hands. Use a clean cloth, gloves or a tissue.
- To avoid injury or damage to the luminaire, ensure that power leads and screws are secure before connecting the power.
- Select a suitable location away from liquids and hazards.
- To clean, wipe with a damp clean cloth. Do NOT soak or immerse the luminaire in water or other liquids.
- Ensure that the luminaire does not come in contact with corrosive chemicals/solvents or abrasive cleaners etc.

Specifications								
SKU #	140750	140754	140758	140762	140751	140755	140759	140763
Colour	Black	White	Bronze	Nickel	Black	White	Bronze	Nickel
Light Head	1 light				2 light			
Rated Voltage	220-240V~ 50Hz							
Rated Wattage	8W MAX (1 x MAX. 8W LED globe)				16W MAX (2 x MAX. 8W LED globe)			
Lamp Holder	GU10							
Weight	0.3kg				0.8kg			
Canopy Size	H:60mm W:60mm E:25mm				H:60mm W:290mm E:25mm			
Dimensions	H:130mm W:130mm E:160mm Max				H:170mm W:335mm E:165mm Max			

SKU #	140752	140756	140760	140764	140753	140757	140761	140765
Colour	Black	White	Bronze	Nickel	Black	White	Bronze	Nickel
Light Head	3 light				4 light			
Rated Voltage	220-240V~ 50Hz							
Rated Wattage	24W MAX (3 x MAX. 8W LED globe)				32W MAX (4 x MAX. 8W LED globe)			
Lamp Holder	GU10							
Weight	1.2kg				1.6kg			
Canopy Size	H:60mm W:408mm E:25mm				H:60mm W:582mm E:25mm			
Dimensions	H:170mm W:505mm E:165mm Max				H:170mm W:670mm E:165mm Max			